

5

4

3

2

1

NOTE(S):  
1. PART NUMBER, "/00" DENOTES PART SHALL HAVE FINISH.

ITEM NO.	PART NUMBER	DESCRIPTION	QTY.
1	3-055/00	TP ROLL SPRING HOLDER	1
2	92010	SET SCREW, CUP POINT 8-32UNC 5/16" LENGTH SS	2
3	P23047/00	KCW50/65 POST	2
4	P23055	KPG BACK PLATE	2
5	P36005	#6 DRY WALL SCREW	4
6	P39001	HEX KEY 5/64, FOR 8-32 SET SCREW	1

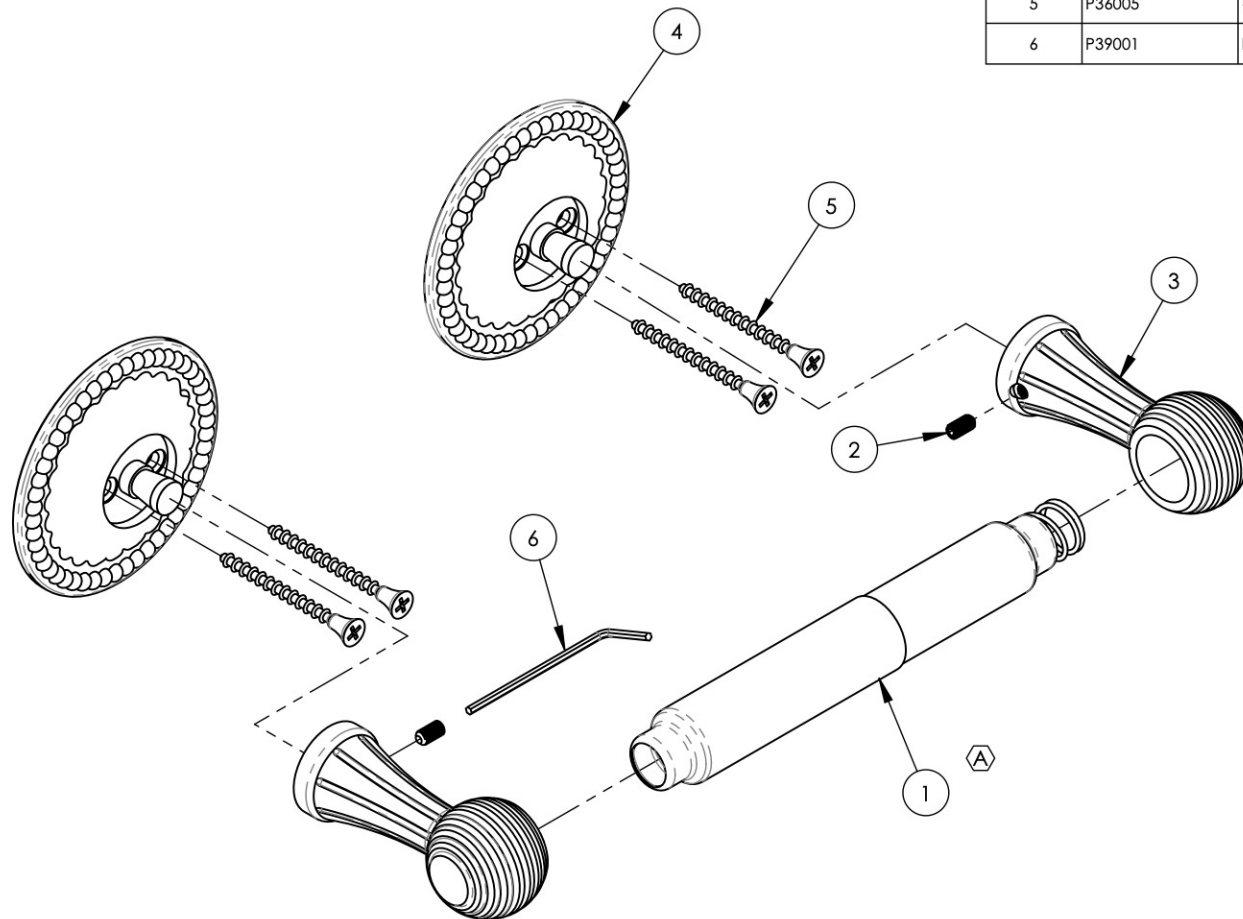

B3	A	UPDATE TEMPLATE & PAPER ROLLER	7/14/2020	AMM
ZONE	REV.	DESCRIPTION	DATE	APPROVED
REVISIONS				

1261 LOGAN AVENUE  
COSTA MESA, CALIFORNIA 92626  
PHONE: 714.361.4800  
FAX: 714.617.3120

**PHYL RICH**<sup>®</sup>  
Defining Luxury Since 1959

**PROPRIETARY AND CONFIDENTIAL**  
THE INFORMATION CONTAINED IN THIS DRAWING IS THE SOLE PROPERTY OF PHYL RICH. ANY REPRODUCTION IN PART OR AS A WHOLE WITHOUT THE WRITTEN PERMISSION OF PHYL RICH IS PROHIBITED.

-	-	INTERPRET GEOMETRIC DIMENSIONING & TOLERANCING IN ACCORDANCE WITH ASME Y14.5-2009 & ASME Y14.41-2003 STANDARDS, UNLESS OTHERWISE SPECIFIED. DIMENSIONS ARE IN INCHES. TOLERANCES ARE:		
NEXT ASSY	USED ON	<b>FRACTIONS</b> ±1/16"	<b>DECIMALS</b> X.X: ±.1 X.XX: ±.01 X.XXX: ±.005	<b>ANGULAR</b> ±2°
APPLICATION		MATERIAL	NAME	DATE
FINISH		DRAWN	LLO	8/27/2013
<b>DO NOT SCALE DRAWING</b>		CHECKED	GRE	

**TP HOLDER DOUBLE POST, GEORGIAN & BARCELONA (360-73/00)**

SIZE	ASM/PRT NO.	REV
<b>A</b>	<b>KPG50/00</b>	<b>A</b>
SCALE: 1:2	WEIGHT: lbs.	SHEET 1 OF 2

5

4

3

2

1