

NOTE(S):
1. PART NUMBER, "/00" DENOTES PART SHALL HAVE FINISH.
2. APPLY NSF COMPLIANT LOCTITE TO THREADED AREA.

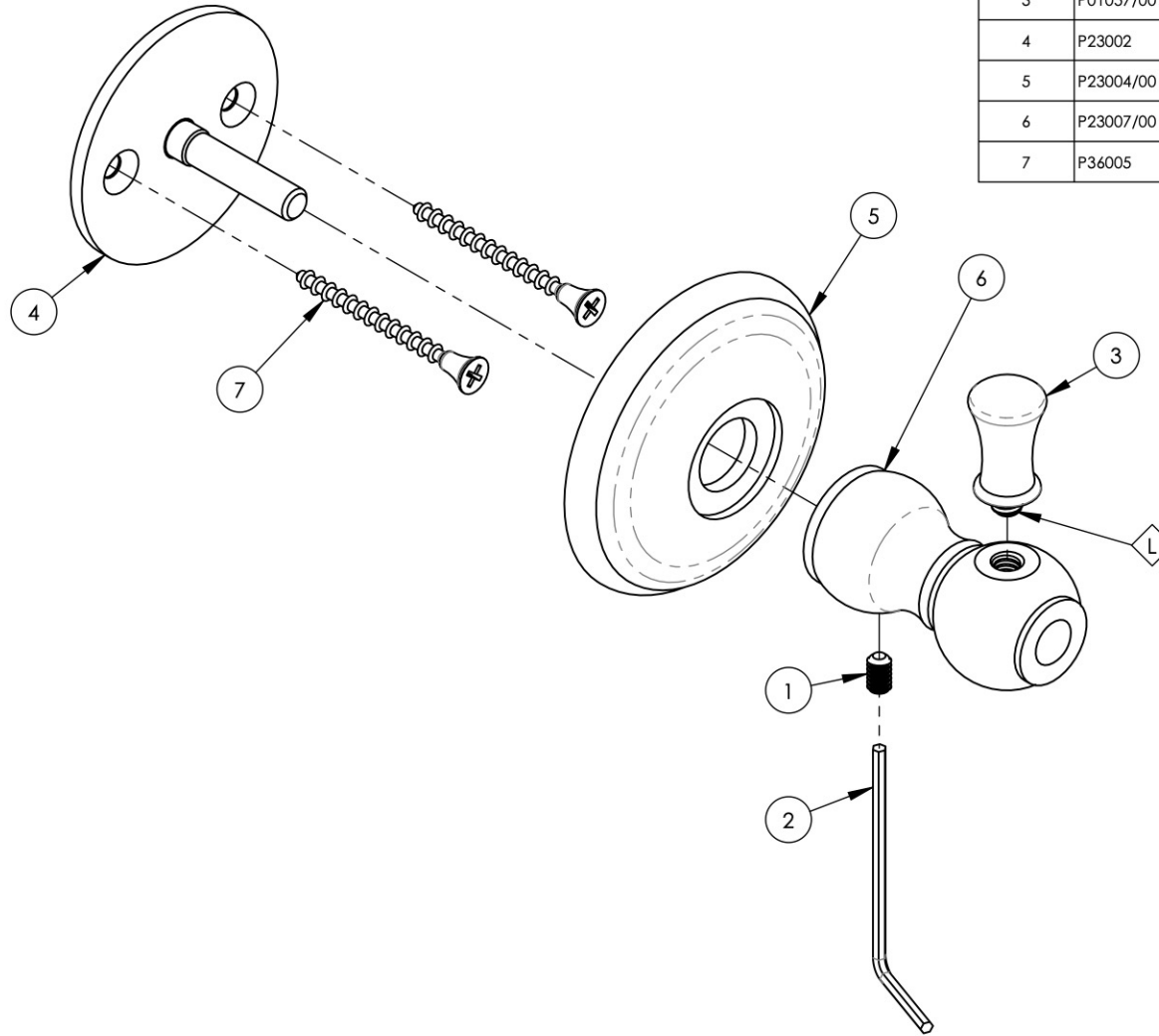

ITEM NO.	PART NUMBER	DESCRIPTION	QTY.
1	92060	SET SCREW, 10-24 5/16"L	1
2	92184	HEX L-KEY 3/32" HEX x 2 1/8"L	1
3	P01057/00	SPOKE FOR HANDLE, D103	1
4	P23002	GKB MOUNTING STUD	1
5	P23004/00	KGB BACK PLATE	1
6	P23007/00	KGB10 POST	1
7	P36005	#6 DRY WALL SCREW	2



ZONE	REV.	DESCRIPTION	DATE	APPROVED
REVISIONS				

1261 LOGAN AVENUE
COSTA MESA, CALIFORNIA 92626
PHONE: 714.361.4800
FAX: 714.617.3120

PHYLIRICH®
Defining Luxury Since 1959

PROPRIETARY AND CONFIDENTIAL

THE INFORMATION CONTAINED IN THIS DRAWING
IS THE SOLE PROPERTY OF PHYLIRICH. ANY
REPRODUCTION IN PART OR AS A WHOLE
WITHOUT THE WRITTEN PERMISSION OF PHYLIRICH
IS PROHIBITED.

-	-	INTERPRET GEOMETRIC DIMENSIONING & TOLERANCING IN ACCORDANCE WITH ASME Y14.5-2009 & ASME Y14.41-2003 STANDARDS. UNLESS OTHERWISE SPECIFIED, DIMENSIONS ARE IN INCHES. TOLERANCES ARE:		
-	-			
-	-			
-	-			
NEXT ASSY		USED ON		FRACTIONS ±1/16"
APPLICATION				DECIMALS X.X: ±.1 X.XX: ±.01 X.XXX: ±.005
MATERIAL				ANGULAR ±2°
FINISH		NAME	DATE	
		DRAWN	AMM	4/15/2020
		CHECKED		
DO NOT SCALE DRAWING				

ROBE HOOK, 3RING

SIZE	ASM/PRT NO.	REV
A	KGB10	-
SCALE: 1:1.5	WEIGHT: lbs.	SHEET 1 OF 2