

A

B

C

D

E

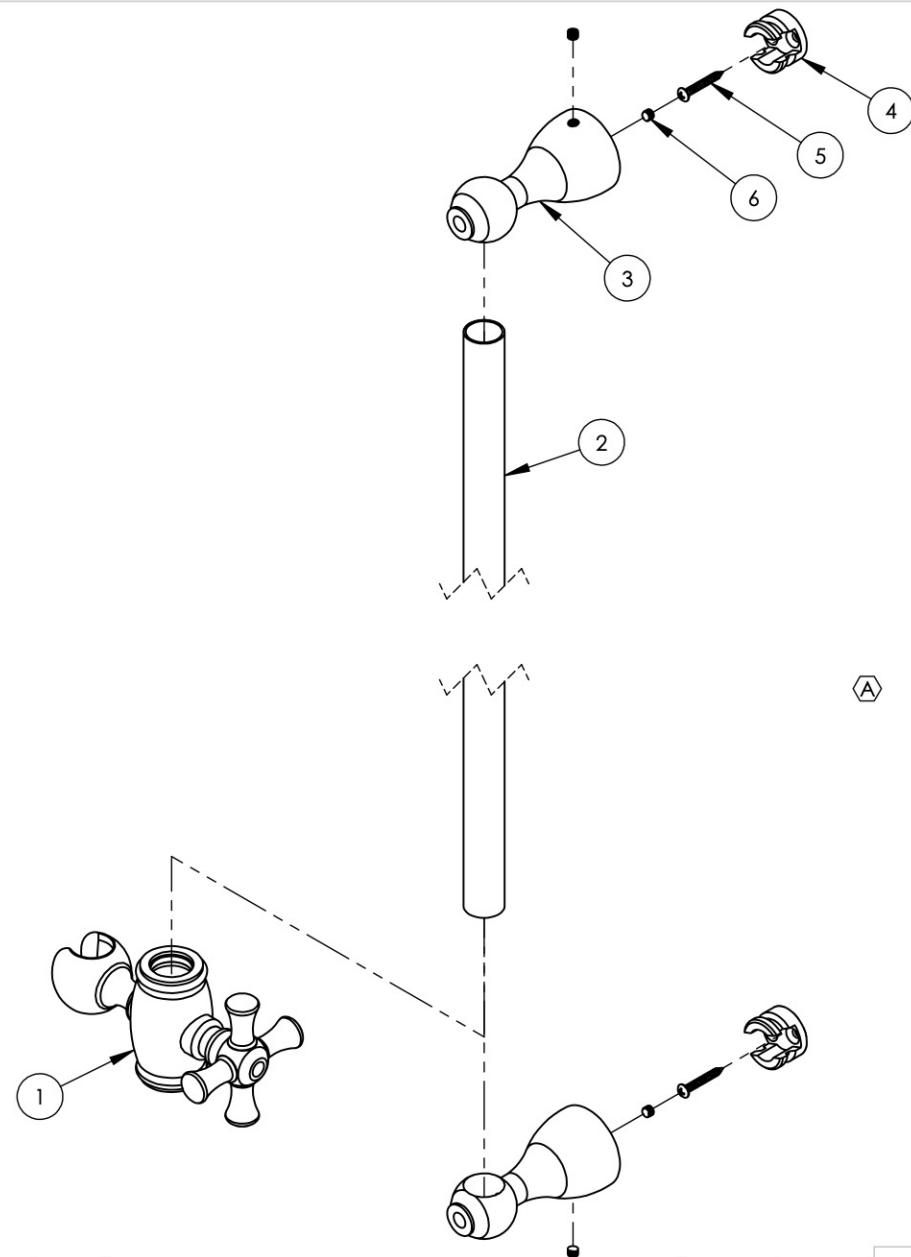

ITEM NO.	PART NUMBER	DESCRIPTION	QTY.
1	3-413/00	ASSY, HANDSHOWER HOLDER, SLIDE BAR, TRADITIONAL	1
2	10917/00	BAR TUBE, SLIDEBAR FOR HANDSHOWER	1
3	10968/00	ARM POST, SLIDEBAR FOR HANDSHOWER	2
4	10916	MOUNT, SLIDEBAR FOR HANDSHOWER	2
5	92167	SCREW, PAN HD PHIL NO. 6 X 1" L	2
6	92166	SET SCREW, CONE PT 10-32 X 3/16"L	4

C3	A	RESTRUCTURED DRAWING	3/27/2019	RAH
ZONE	REV.	DESCRIPTION	DATE	APPROVED
REVISIONS				

REVISIONS		PROPRIETARY AND CONFIDENTIAL
1261 LOGAN AVENUE COSTA MESA, CALIFORNIA 92626 PHONE: 714.361.4800 FAX: 714.617.3120		THE INFORMATION CONTAINED IN THIS DRAWING IS THE SOLE PROPERTY OF RSS MANUFACTURING. ANY REPRODUCTION IN PART OR AS A WHOLE WITHOUT THE WRITTEN PERMISSION OF RSS MANUFACTURING IS PROHIBITED.

-	-	INTERPRET GEOMETRIC DIMENSIONING & TOLERANCING IN ACCORDANCE WITH ASME Y14.5-2009 & ASME Y14.41-2003 STANDARDS, UNLESS OTHERWISE SPECIFIED. DIMENSIONS ARE IN INCHES. TOLERANCES ARE:		
NEXT ASSY	USED ON	FRACTIONS ±1/64"	DECIMALS X.X: ±.1 X.XX: ±.01 X.XXX: ±.005	ANGULAR ±.5°
APPLICATION				
MATERIAL BRASS		NAME	DATE	
FINISH		DRAWN	4/15/13	
DO NOT SCALE DRAWING		CHECKED		

24" ADJUSTABLE SLIDE BAR W/ HOOK  
TRADITIONAL

SIZE	ASM/PRT NO.	REV
<b>A</b>	K6024/00	<b>B</b>
SCALE: 1:4	WEIGHT: lbs.	SHEET 1 OF 2

5

4

3

2

1