

ITEM NO.	PART NUMBER	VendorNo	DESCRIPTION	QTY.
1	92010		SET SCREW, CUP POINT 8-32UNC 5/16" LENGTH SS	2
2	92188	P23192	ANCHOR SCREW	6
3	92189		Pan Head Phillips Screw # 7 1-1/2" L	6
4	P23161/00		GRAB BAR TUBE	1
5	P23181		MOUNTING BRACKET	2
6	P23191/00		GRAB BAR MAIN BODY	2
7	P39014	7289A12	2MM HEX KEY	1

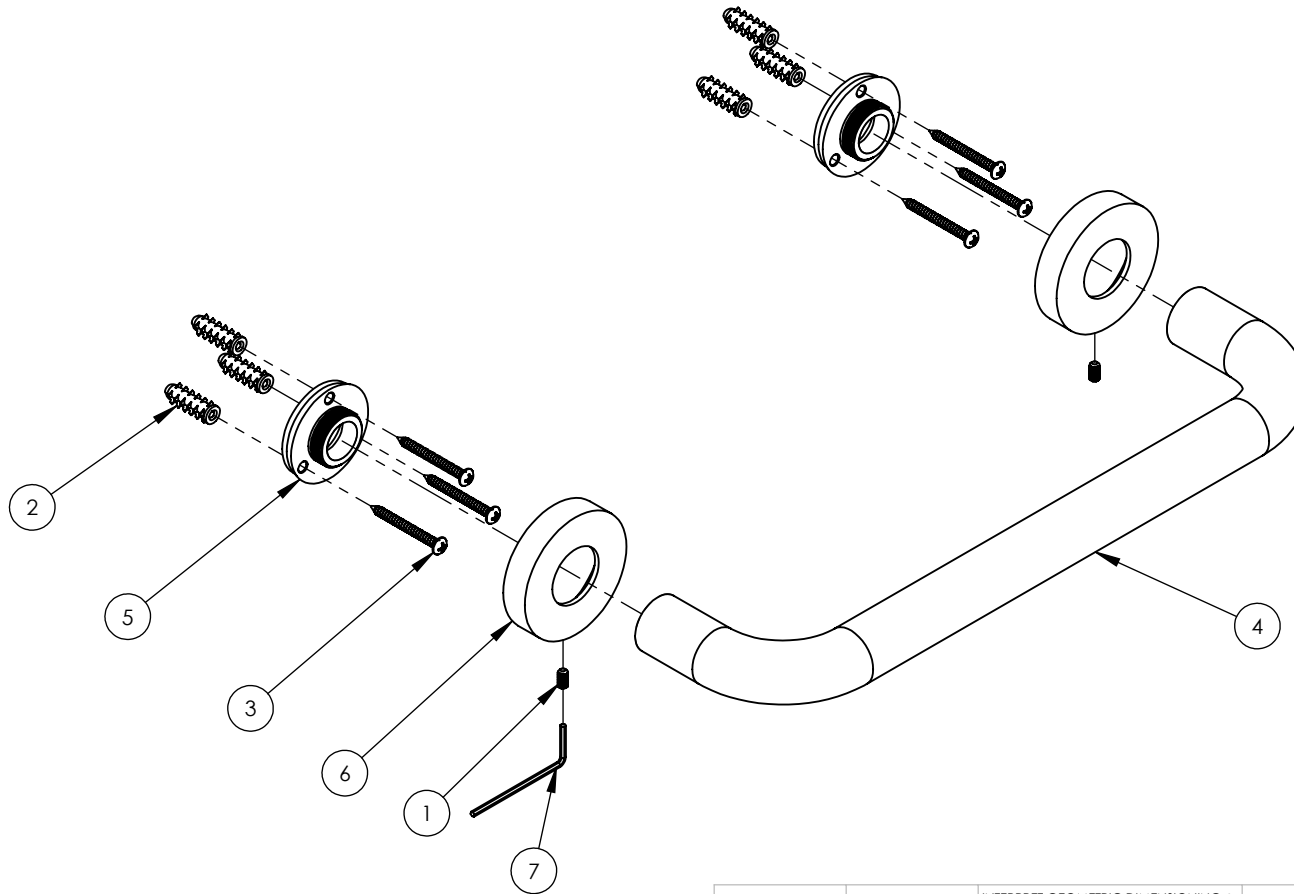

A

B

C

D

E

ZONE	REV.	DESCRIPTION	DATE	APPROVED
REVISIONS				

NEXT ASSY	USED ON	APPLICATION

1261 LOGAN AVENUE COSTA MESA, CALIFORNIA 92626 PHONE: 714.361.4800 FAX: 714.617.3120		PROPRIETARY AND CONFIDENTIAL THE INFORMATION CONTAINED IN THIS DRAWING IS THE SOLE PROPERTY OF RSS MANUFACTURING. ANY REPRODUCTION IN PART OR AS A WHOLE WITHOUT THE WRITTEN PERMISSION OF RSS MANUFACTURING IS PROHIBITED.
---	---	---

INTERPRET GEOMETRIC DIMENSIONING & TOLERANCING IN ACCORDANCE WITH ASME Y14.5-2009 & ASME Y14.41-2003 STANDARDS, UNLESS OTHERWISE SPECIFIED. DIMENSIONS ARE IN INCHES. TOLERANCES ARE: FRACTIONS ±1/64" DECIMALS X.X: ±.1 ANGULAR X.XX: ±.01 X.XXX: ±.005		
MATERIAL	NAME	DATE
FINISH	DRAWN	LLO 7/30/2013
DO NOT SCALE DRAWING	CHECKED	GRE

GRAB BAR, BASIC		
SIZE	ASM/PRT NO.	REV
A	DB110/00	-
SCALE: 1:3	WEIGHT: lbs.	SHEET 1 OF 2

5

4

3

2

1

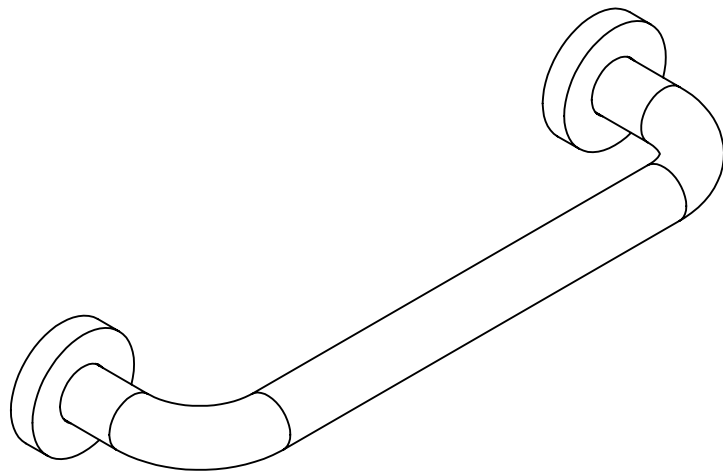
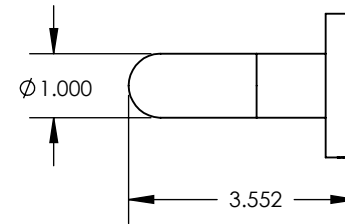
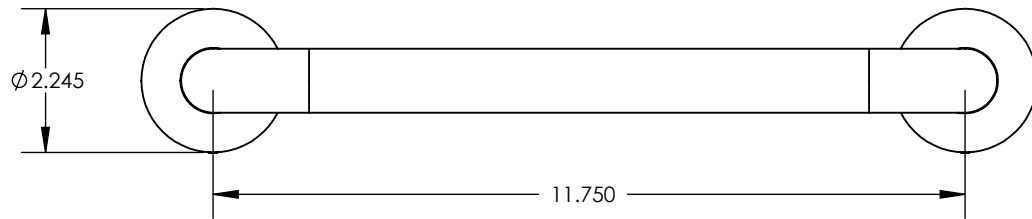

-	-	INTERPRET GEOMETRIC DIMENSIONING & TOLERANCING IN ACCORDANCE WITH ASME Y14.5-2009 & ASME Y14.41-2003 STANDARDS, UNLESS OTHERWISE SPECIFIED. DIMENSIONS ARE IN INCHES. TOLERANCES ARE:		
NEXT ASSY	USED ON	FRACTIONS ±1/64"	DECIMALS X.X: ±.1 X.XX: ±.01 X.XXX: ±.005	ANGULAR ±.5°
APPLICATION		MATERIAL	NAME	DATE
FINISH		DRAWN	LLO	7/30/2013
DO NOT SCALE DRAWING		CHECKED	GRE	

GRAB BAR, BASIC			
SIZE	ASM/PRT NO.	REV	
A	DB110/00	-	
SCALE: 1:3	WEIGHT: lbs.	SHEET 2 OF 2	

1261 LOGAN AVENUE
COSTA MESA, CALIFORNIA 92626
PHONE: 714.361.4800
FAX: 714.617.3120



MANUFACTURING

PROPRIETARY AND CONFIDENTIAL

THE INFORMATION CONTAINED IN THIS DRAWING IS THE SOLE PROPERTY OF RSS MANUFACTURING. ANY REPRODUCTION IN PART OR AS A WHOLE WITHOUT THE WRITTEN PERMISSION OF RSS MANUFACTURING IS PROHIBITED.

5

4

3

2

1

A

B

C

D

E