

NOTE(S):
 1. PART NUMBER, "/00" DENOTES PART SHALL HAVE FINISH.

2. APPLY NSF COMPLIANT GREASE TO ANY O-RING, SEALING JOINTS, AND/OR PIVOTAL POINTS.

3. APPLY NSF COMPLIANT LOCTITE TO THREADED AREA:

4. APPLY NSF COMPLIANT REMOVABLE (BLUE) LOCTITE TO THREADED AREA:

5. SILVER SOLDER JOINTS SHALL BE FULLY WETTED VIA CAPILLARY ACTION AND COMPLETELY NON-POROUS.



ITEM NO.	PART NUMBER	DESCRIPTION	QTY.
1	3-190/00	DECK TUB, SPOUT ONLY, HIGH SPOUT, BASIC	1
1.1	2-167/00	SUB ASSY. HIGH ARC TUB SPOUT, DECK TUB BASIC	1
1.2	P05024	AERATOR CACHE COIN SLOT, M21.5X1.0 FULL FLOW	1
1.3	92127	SET SCREW, CUP PT, 1/4"-20 X 5/16"L, SS	1
1.4	90137	O-RING, 2-1/16"ID X 3/32"THK., AS-568-137	1
1.5	P05025	AERATOR, BASIC KEY, PLASTIC RED	1
2	92216	HEX L-KEY 1/8" HEX x 2-5/16"L	1

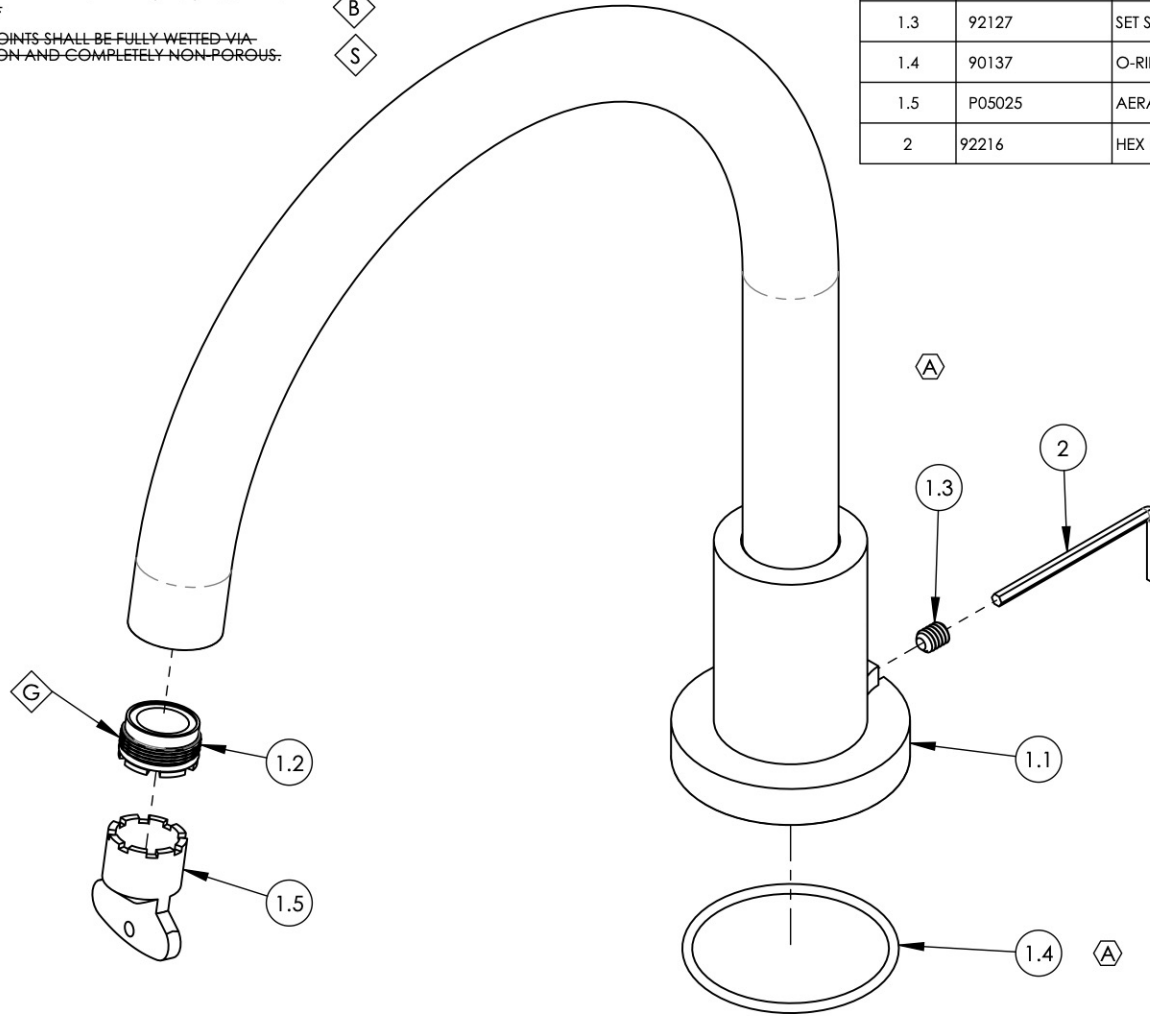

ALL	A	ADD CALL OUTS, ADD SPOUT ASSY, UPDATE HEX, SET SCREW/ O-RING	5/21/2020	AMM
ZONE	REV.	DESCRIPTION	DATE	APPROVED
REVISIONS				

1261 LOGAN AVENUE
 COSTA MESA, CALIFORNIA 92626
 PHONE: 714.361.4800
 FAX: 714.617.3120

PHYLIRICH[®]
 Defining Luxury Since 1959

PROPRIETARY AND CONFIDENTIAL
 THE INFORMATION CONTAINED IN THIS DRAWING IS THE SOLE PROPERTY OF PHYLIRICH. ANY REPRODUCTION IN PART OR AS A WHOLE WITHOUT THE WRITTEN PERMISSION OF PHYLIRICH IS PROHIBITED.
DO NOT SCALE DRAWING

DECK TUB, SPOUT ONLY, HIGH ARC SPOUT, BASIC

SIZE A	ASM/PRT NO. D5130/00	REV A
SCALE: 1:2	WEIGHT: lbs.	SHEET 1 OF 2