

NOTE(S):
 1. PART NUMBER, "/00" DENOTES PART SHALL HAVE FINISH.
 2. APPLY NSF COMPLIANT GREASE TO ANY O-RING, SEALING JOINTS, AND/OR PIVOTAL POINTS.
 3. APPLY NSF COMPLIANT LOCTITE TO THREADED AREA.
 4. APPLY NSF COMPLIANT REMOVABLE (BLUE) LOCTITE TO THREADED AREA.
 5. SILVER SOLDER JOINTS SHALL BE FULLY WETTED VIA CAPILLARY ACTION AND COMPLETELY NON-POROUS.

G
 L
 B
 S

| ITEM NO. | PART NUMBER | DESCRIPTION | QTY. |
|----------|-------------|---|------|
| 1 | 11366 | HOSE, SUPPLY, FREE STANDING TUB FILLER | 2 |
| 2 | 11367 | CONNECTOR, BODY TO RISER | 1 |
| 3 | 11368/00 | RISER, SUPPLY TUBE | 1 |
| 4 | 3-440/00 | ASSY. BLADE HANDLE, BASIC SERIES | 1 |
| 4.1 | 92008 | SET SCREW, CUP POINT 8-32, 3/16" L. | 2 |
| 4.2 | P01081/00 | HANDLE CROSS BLADE BASIC | 1 |
| 5 | 3-504/00 | ASSY, RISER & BASE, FLOOR MOUNT TUB FILLER | 1 |
| 6 | 3-506/00 | ASSY, FLAT/LOW SQUARE SPOUT, FLOOR MOUNT TUB FILLER | 1 |
| 7 | 3-761/00 | MAIN BODY FLOOR MOUNT TUB FILLER, LESS HOOK | 1 |
| 8 | 92176 | WEAR WASHER | 1 |
| 9 | P05024 | AERATOR CACHE COIN SLOT, M21.5X1.0 FULL FLOW | 1 |
| 10 | P05025 | AERATOR, BASIC KEY, PLASTIC RED | 1 |

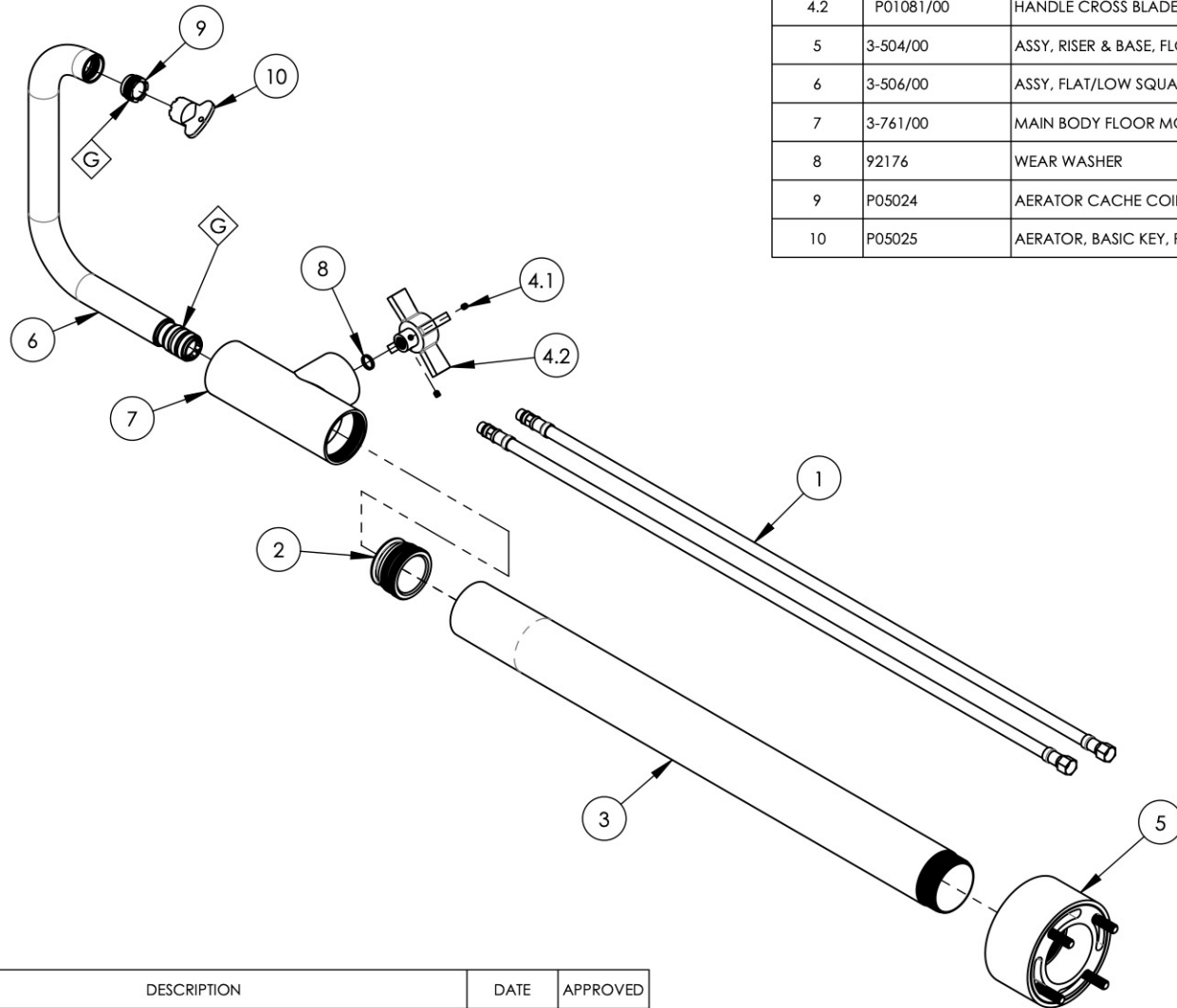

| ZONE | REV. | DESCRIPTION | DATE | APPROVED |
|-----------|------|-------------|------|----------|
| REVISIONS | | | | |

1261 LOGAN AVENUE
 COSTA MESA, CALIFORNIA 92626
 PHONE: 714.361.4800
 FAX: 714.617.3120

PHYLIRICH[®]
 Defining Luxury Since 1959

PROPRIETARY AND CONFIDENTIAL
 THE INFORMATION CONTAINED IN THIS DRAWING IS THE SOLE PROPERTY OF PHYLIRICH. ANY REPRODUCTION IN PART OR AS A WHOLE WITHOUT THE WRITTEN PERMISSION OF PHYLIRICH IS PROHIBITED.
DO NOT SCALE DRAWING

**FLOOR MOUNT TUB FILLER, SINGLE HOLE
 TALL, LOW SPOUT W/ CROSS BLADE,
 BASIC**

| | | |
|------------------|------------------------------------|--------------|
| SIZE A | ASM/PRT NO. 132-45-02/00 | REV - |
| SCALE: 1:6 | WEIGHT: lbs. | SHEET 1 OF 2 |