

A

B

C

D

E

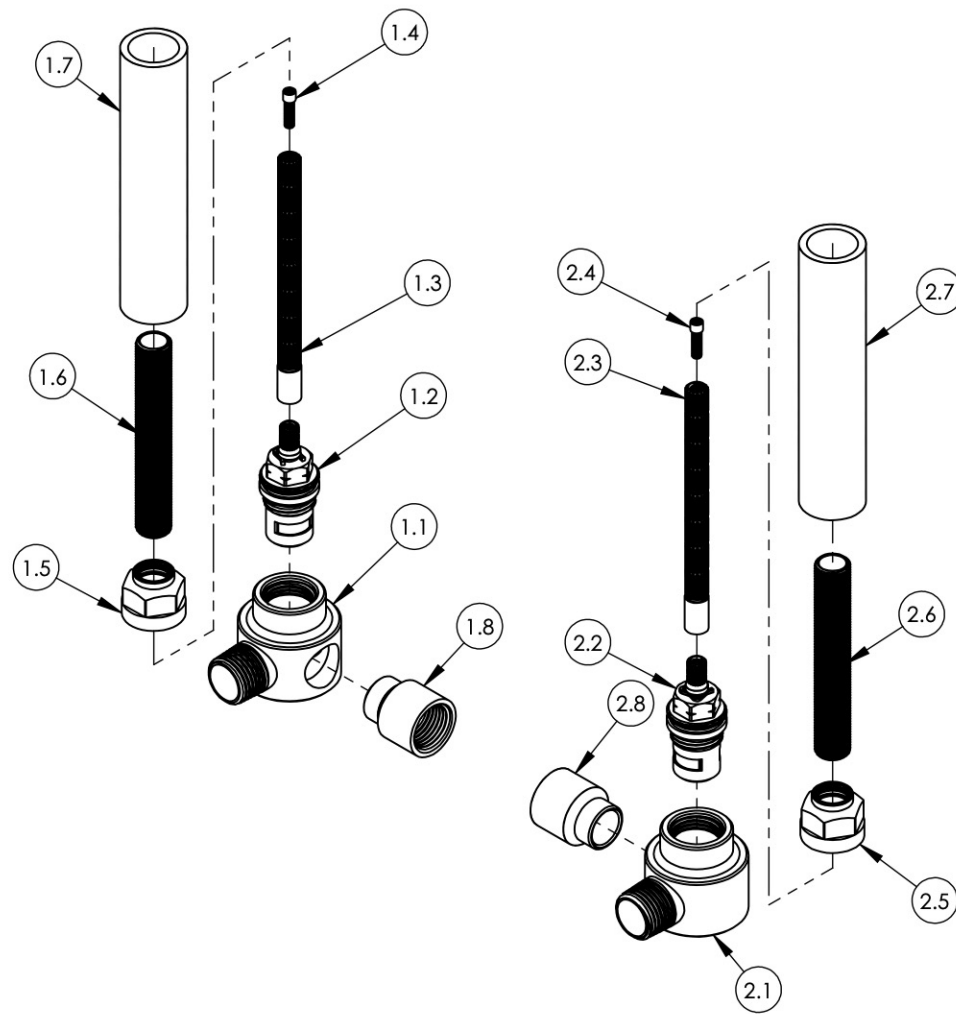

ITEM NO.	PART NUMBER	DESCRIPTION	QTY.
1	1-045	CORNER VALVE HOT WITH 1/2" FEM OUT 16PT	1
1.1	10088	VALVE, INWALL ROUGH SIDE LEFT 1/2" G & NPT NIPPLE	1
1.2	10211	CARTRIDGE, VALVE 1/2G20PT HOT LEAD FREE	1
1.3	10054	STEM EXTENSION, 20PT INT. TO 16PT LONG EXT. BROACH	1
1.4	92157	SCREW, SMALL HD M4X0.7 - 1/2"L	1
1.5	10058	NUT, ADAPTOR CART. TO THREADALL, M24X1.0 - 9/16"-20UN	1
1.6	10209	SHANK, NIPPLE THREAD ALL 9/16"-20UN WITH .433"ID	1
1.7	10324	MUD GUARD PVC	1
1.8	10069	NIPPLE, 1/2"NPT FEMALE INWALL VALVE ROUGH	1
2	1-046	CORNER VALVE COLD WITH 1/2" FEM OUT 16PT	1
2.1	10089	VALVE, INWALL ROUGH SIDE RIGHT 1/2" G & NPT NIPPLE	1
2.2	10210	CARTRIDGE, VALVE 1/2"G 20PT COLD LEAD FREE	1
2.3	10054	STEM EXTENSION, 20PT INT. TO 16PT LONG EXT. BROACH	1
2.4	92157	SCREW, SMALL HD M4X0.7 - 1/2"L	1
2.5	10058	NUT, ADAPTOR CART. TO THREADALL, M24X1.0 - 9/16"-20UN	1
2.6	10209	SHANK, NIPPLE THREAD ALL 9/16"-20UN WITH .433"ID	1
2.7	10324	MUD GUARD PVC	1
2.8	10069	NIPPLE, 1/2"NPT FEMALE INWALL VALVE ROUGH	1

ZONE	REV.	DESCRIPTION	DATE	APPROVED
REVISIONS				

1261 LOGAN AVENUE  
COSTA MESA, CALIFORNIA 92626  
PHONE: 714.361.4800  
FAX: 714.617.3120



MANUFACTURING

**PROPRIETARY AND CONFIDENTIAL**

THE INFORMATION CONTAINED IN THIS DRAWING IS THE SOLE PROPERTY OF RSS MANUFACTURING. ANY REPRODUCTION IN PART OR AS A WHOLE WITHOUT THE WRITTEN PERMISSION OF RSS MANUFACTURING IS PROHIBITED.

-	-	INTERPRET GEOMETRIC DIMENSIONING & TOLERANCING IN ACCORDANCE WITH ASME Y14.5-2009 & ASME Y14.41-2003 STANDARDS, UNLESS OTHERWISE SPECIFIED. DIMENSIONS ARE IN INCHES. TOLERANCES ARE:		
NEXT ASSY	USED ON	<b>FRACTIONS</b> ±1/64"	<b>DECIMALS</b> X.X: ±.1 X.XX: ±.01 X.XXX: ±.005	<b>ANGULAR</b> ±.5°
APPLICATION				
MATERIAL				
FINISH	DRAWN	NAME	DATE	
	MAF	MAF	4/17/2014	
<b>DO NOT SCALE DRAWING</b>	CHECKED	GRE		

## CORNER VALVES

SIZE	ASM/PRT NO.	REV
<b>A</b>	8090536RC	-
SCALE: 1:3	WEIGHT: lbs.	SHEET 1 OF 1

5

4

3

2

1