

- NOTE(S):
1. PART NUMBER, "/00" DENOTES PART SHALL HAVE FINISH.
 2. APPLY NSF COMPLIANT GREASE TO ANY O-RING, SEALING JOINTS, AND/OR PIVOTAL POINTS.
 3. APPLY NSF COMPLIANT LOCTITE TO THREADED AREA.
 4. APPLY NSF COMPLIANT REMOVABLE (BLUE) LOCTITE TO THREADED AREA.
 5. SILVER SOLDER JOINTS SHALL BE FULLY WETTED VIA CAPILLARY ACTION AND COMPLETELY NON-POROUS.

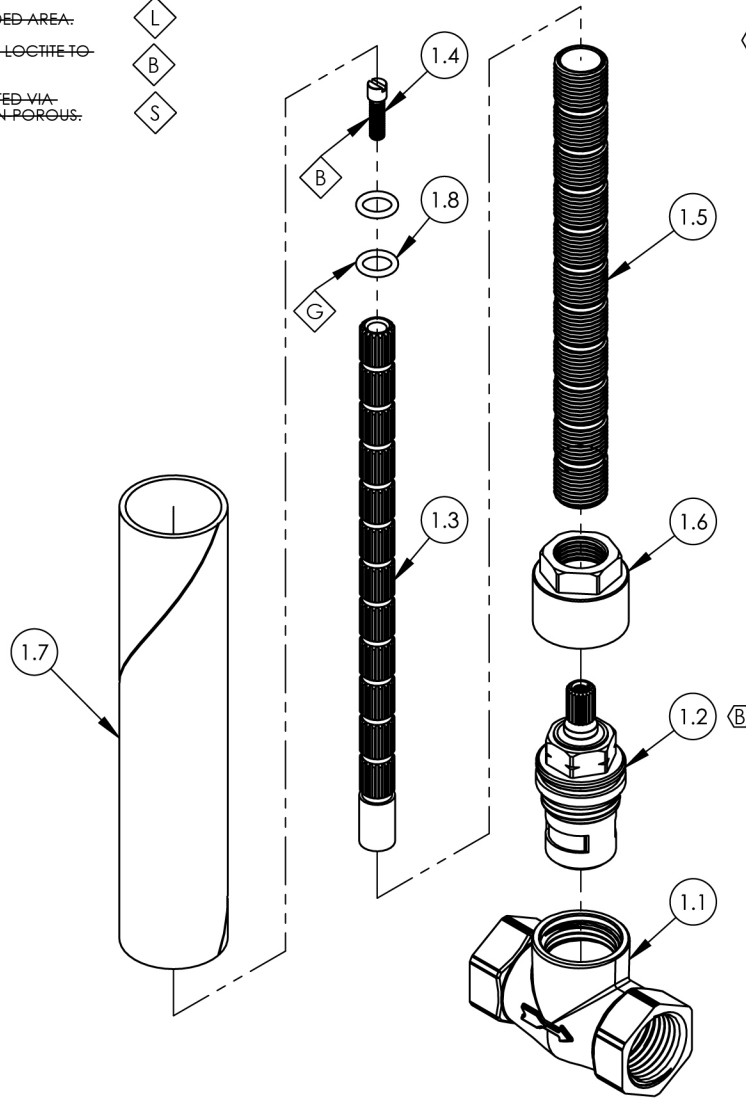

ITEM NO.	PART NUMBER	DESCRIPTION	QTY.
1	1-060	VALVE 1/2" IN-LINE STOP / VOLUME CONTROL COLD	1
1.1	11666	BODY FORGED, SHUTOFF 1/2" NPT IN & OUT	1
1.2	11540	CARTRIDGE, 1/2"G 20PT COLD, HI-TRQ LLL, EXACTO	1
1.3	11416	STEM EXTENSION, 20PT TO 16PT, XXL	1
1.4	92157	SCREW, SMALL HD M4X0.7 - 1/2"L	1
1.5	11498	ALL THREAD, EXTENSION, 9/16"-20, 5-9/16"L, XXL	1
1.6	11321	CARTRIDGE RETAINER NUT	1
1.7	11648	MUD GUARD, CARDBOARD, LONG	1
1.8	90011	O-RING, 5/16"ID X 1/16"THK, AS-568-011	2

ALL	B	UPDATED COMPONENT & EXPLODED VIEW	2/21/2025	VA
ZONE	REV.	DESCRIPTION	DATE	APPROVED
REVISIONS				

1261 LOGAN AVENUE
COSTA MESA, CALIFORNIA 92626
PHONE: 714.361.4800
FAX: 714.617.3120

PHYLIRICH®
Defining Luxury Since 1959

PROPRIETARY AND CONFIDENTIAL
THE INFORMATION CONTAINED IN THIS DRAWING
IS THE SOLE PROPERTY OF PHYLIRICH. ANY
REPRODUCTION IN PART OR AS A WHOLE
WITHOUT THE WRITTEN PERMISSION OF PHYLIRICH
IS PROHIBITED.
DO NOT SCALE DRAWING

VALVE, 1/2" IN LINE STOP / VOLUME
CONTROL

SIZE	ASM/PRT NO.	REV
A	80607PHY	B
SCALE: 1:2	WEIGHT: lbs.	SHEET 1 OF 1