

- NOTE(S):
- PART NUMBER, "/00" DENOTES PART SHALL HAVE FINISH.
  - APPLY NSF COMPLIANT GREASE TO ANY O-RING, SEALING JOINTS, AND/OR PIVOTAL POINTS.
  - APPLY NSF COMPLIANT LOCTITE TO THREADED AREA.
  - APPLY NSF COMPLIANT REMOVABLE (BLUE) LOCTITE TO THREADED AREA.
  - SILVER SOLDER JOINTS SHALL BE FULLY WETTED VIA CAPILLARY ACTION AND COMPLETELY NON-POROUS.
  - HAND SHOWER USES CHECK VALVE "31.4153.0" (10672).
  - FLOOR MOUNT MAIN BODY USES CHECK VALVE INSERT "31.4210.0" (12229).

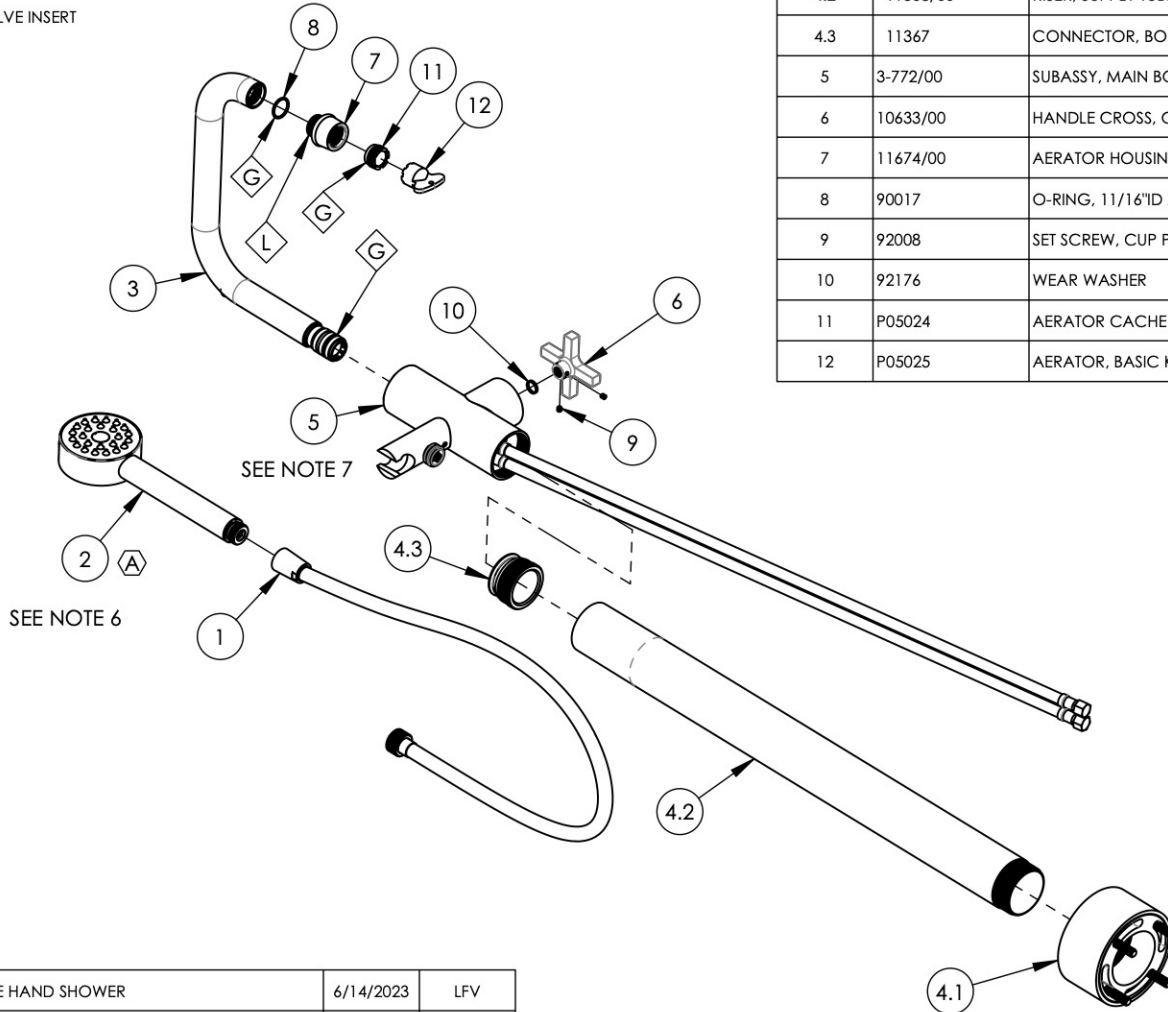

| ITEM NO. | PART NUMBER | DESCRIPTION   | QTY. |
|----------|-------------|---|------|
| 1        | 3-049/00    | ASSY, HOSE KIT, HANDSHOWER                          | 1    |
| 2        | 3-782/00    | HAND SHOWER, ROUND, SINGLE FUNCTION                 | 1    |
| 3        | 3-506/00    | ASSY, FLAT/LOW SQUARE SPOUT, FLOOR MOUNT TUB FILLER | 1    |
| 4        | 3-771/00    | RISER & BASE, TALL, FLOOR MOUNT TUB FILLER          | 1    |
| 4.1      | 3-504/00    | ASSY, BASE, FLOOR MOUNT TUB FILLER                  | 1    |
| 4.2      | 11368/00    | RISER, SUPPLY TUBE                                  | 1    |
| 4.3      | 11367       | CONNECTOR, BODY TO RISER                            | 1    |
| 5        | 3-772/00    | SUBASSY, MAIN BODY & HOSES, FLOOR MOUNT TUB FILLER  | 1    |
| 6        | 10633/00    | HANDLE CROSS, CONTEMPORARY 16PT                     | 1    |
| 7        | 11674/00    | AERATOR HOUSING, RT SPOUT, TRANS. HEX MODERN        | 1    |
| 8        | 90017       | O-RING, 11/16"ID X 13/16"OD X 1/16"THK, AS-568-017  | 1    |
| 9        | 92008       | SET SCREW, CUP POINT 8-32, 3/16" L.                 | 2    |
| 10       | 92176       | WEAR WASHER   | 1    |
| 11       | P05024      | AERATOR CACHE COIN SLOT, M21.5X1.0 FULL FLOW        | 1    |
| 12       | P05025      | AERATOR, BASIC KEY, PLASTIC RED                     | 1    |

| ZONE      | REV. | DESCRIPTION        | DATE      | APPROVED |
|-----------|------|--------------------|-----------|----------|
| C4        | A    | UPDATE HAND SHOWER | 6/14/2023 | LFV      |
| REVISIONS |      |                    |           |          |

1261 LOGAN AVENUE  
COSTA MESA, CALIFORNIA 92626  
PHONE: 714.361.4800  
FAX: 714.617.3120

**PHYLIRICH**<sup>®</sup>  
Defining Luxury Since 1959

**PROPRIETARY AND CONFIDENTIAL**  
THE INFORMATION CONTAINED IN THIS DRAWING IS THE SOLE PROPERTY OF PHYLIRICH. ANY REPRODUCTION IN PART OR AS A WHOLE WITHOUT THE WRITTEN PERMISSION OF PHYLIRICH IS PROHIBITED.  
**DO NOT SCALE DRAWING**

FLOOR MOUNT TUB FILLER W/  
HANDSHOWER SET, SINGLE HOLE TALL,  
LOW SPOUT W/ CROSS, HEX MODERN

|                  |                             |              |
|------------------|-----------------------------|--------------|
| SIZE<br><b>A</b> | ASM/PRT NO.<br>501-54-01/00 | REV<br>A     |
| SCALE: 1:7       | WEIGHT: lbs.                | SHEET 1 OF 2 |