

- NOTE(S):
 1. PART NUMBER, "/00" DENOTES PART SHALL HAVE FINISH.
 2. APPLY NSF COMPLIANT GREASE TO ANY O-RING, SEALING JOINTS, AND/OR PIVOTAL POINTS.
 3. APPLY NSF COMPLIANT LOCTITE TO THREADED AREA.
 4. APPLY NSF COMPLIANT REMOVABLE (BLUE) LOCTITE TO THREADED AREA.
 5. SILVER SOLDER JOINTS SHALL BE FULLY WETTED VIA CAPILLARY ACTION AND COMPLETELY NON-POROUS.

- G
- L
- B
- S

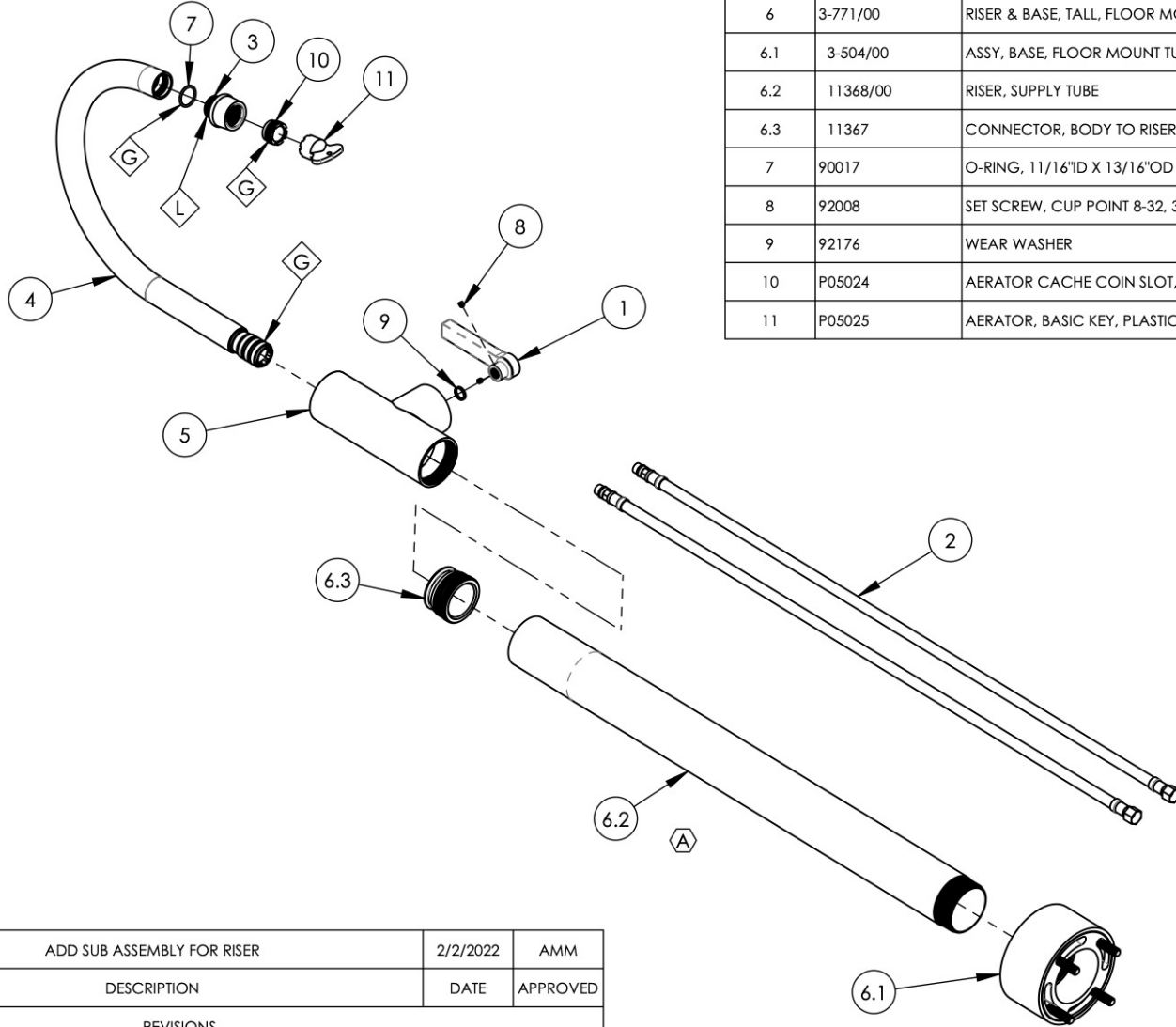

ITEM NO.	PART NUMBER	DESCRIPTION	QTY.
1	11036/00	HANDLE LEVER, CONTEMPORARY 16PT	1
2	11366	HOSE, SUPPLY, FREE STANDING TUB FILLER	2
3	11674/00	AERATOR HOUSING, RT SPOUT, TRANS. HEX MODERN	1
4	3-505/00	ASSY, ARC SPOUT, FLOOR MOUNT TUB FILLER	1
5	3-761/00	MAIN BODY FLOOR MOUNT TUB FILLER, LESS HOOK	1
6	3-771/00	RISER & BASE, TALL, FLOOR MOUNT TUB FILLER	1
6.1	3-504/00	ASSY, BASE, FLOOR MOUNT TUB FILLER	1
6.2	11368/00	RISER, SUPPLY TUBE	1
6.3	11367	CONNECTOR, BODY TO RISER	1
7	90017	O-RING, 11/16"ID X 13/16"OD X 1/16"THK, AS-568-017	1
8	92008	SET SCREW, CUP POINT 8-32, 3/16" L.	2
9	92176	WEAR WASHER	1
10	P05024	AERATOR CACHE COIN SLOT, M21.5X1.0 FULL FLOW	1
11	P05025	AERATOR, BASIC KEY, PLASTIC RED	1

B3	A	ADD SUB ASSEMBLY FOR RISER	2/2/2022	AMM
ZONE	REV.	DESCRIPTION	DATE	APPROVED

REVISIONS

1261 LOGAN AVENUE
 COSTA MESA, CALIFORNIA 92626
 PHONE: 714.361.4800
 FAX: 714.617.3120

PHYL RICH[®]
 Defining Luxury Since 1959

PROPRIETARY AND CONFIDENTIAL
 THE INFORMATION CONTAINED IN THIS DRAWING IS THE SOLE PROPERTY OF PHYL RICH. ANY REPRODUCTION IN PART OR AS A WHOLE WITHOUT THE WRITTEN PERMISSION OF PHYL RICH IS PROHIBITED.
DO NOT SCALE DRAWING

FLOOR MOUNT TUB FILLER, SINGLE HOLE TALL, HIGH SPOUT W/ LEVER, HEX MODERN

SIZE A	ASM/PRT NO. 501-47-02/00	REV A
SCALE: 1:6.5	WEIGHT: lbs.	SHEET 1 OF 2