

- NOTE(S):
 1. PART NUMBER, "/00" DENOTES PART SHALL HAVE FINISH.
 2. APPLY NSF COMPLIANT GREASE TO ANY O-RING, SEALING JOINTS, AND/OR PIVOTAL POINTS.
 3. APPLY NSF COMPLIANT LOCTITE TO THREADED AREA.
 4. APPLY NSF COMPLIANT REMOVABLE (BLUE) LOCTITE TO THREADED AREA.
 5. SILVER SOLDER JOINTS SHALL BE FULLY WETTED VIA CAPILLARY ACTION AND COMPLETELY NON-POROUS.
 6. HAND SHOWER USES CHECK VALVE "31.4153.0" (10672).
 7. FLOOR MOUNT MAIN BODY USES CHECK VALVE INSERT "31.4210.0" (12229).

- G
- L
- B
- S

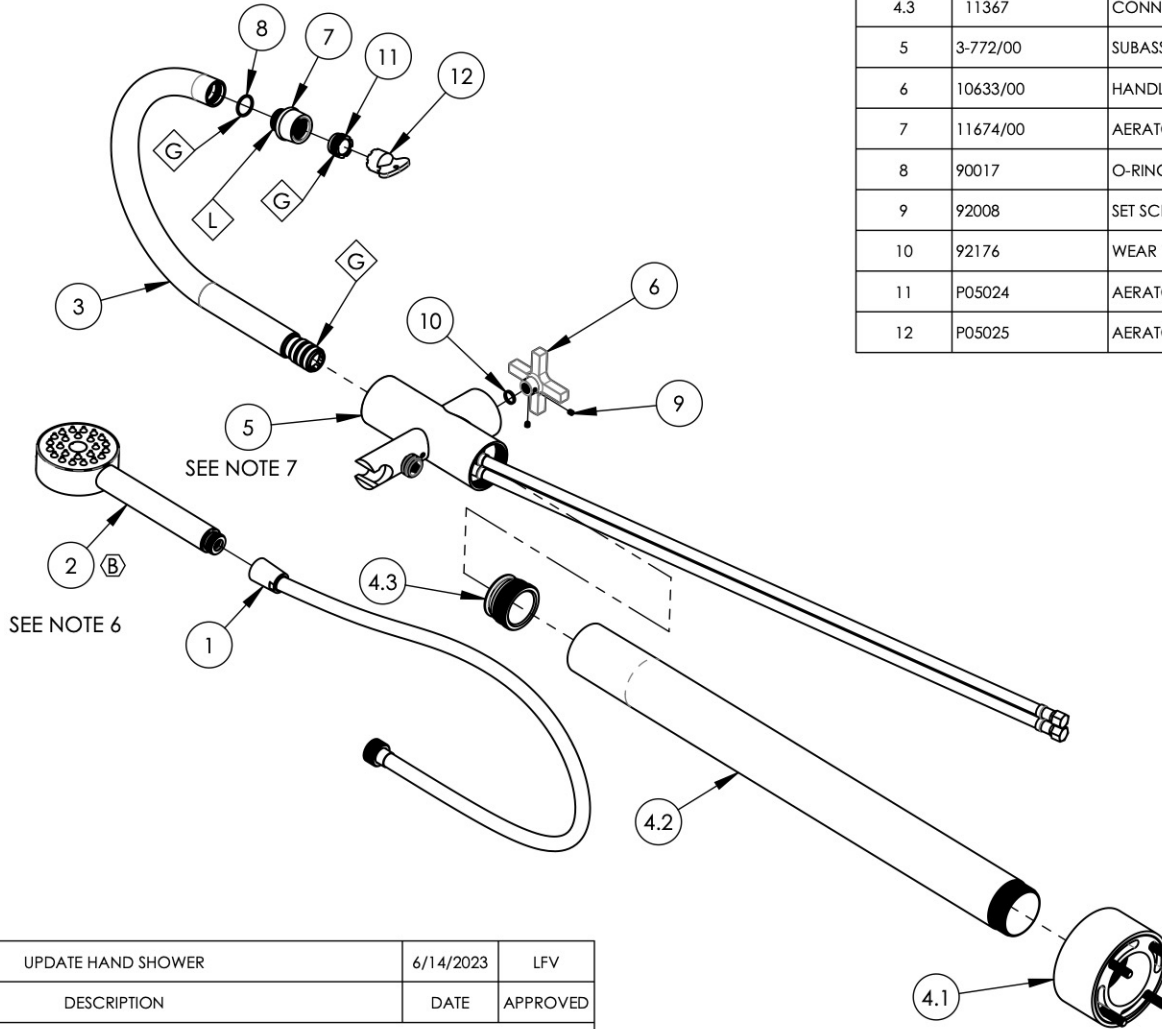

| ITEM NO. | PART NUMBER | DESCRIPTION | QTY. |
|----------|-------------|--|------|
| 1 | 3-049/00 | ASSY, HOSE KIT, HANDSHOWER | 1 |
| 2 | 3-782/00 | HAND SHOWER, ROUND, SINGLE FUNCTION | 1 |
| 3 | 3-505/00 | ASSY, ARC SPOUT, FLOOR MOUNT TUB FILLER | 1 |
| 4 | 3-771/00 | RISER & BASE, TALL, FLOOR MOUNT TUB FILLER | 1 |
| 4.1 | 3-504/00 | ASSY, BASE, FLOOR MOUNT TUB FILLER | 1 |
| 4.2 | 11368/00 | RISER, SUPPLY TUBE | 1 |
| 4.3 | 11367 | CONNECTOR, BODY TO RISER | 1 |
| 5 | 3-772/00 | SUBASSY, MAIN BODY & HOSES, FLOOR MOUNT TUB FILLER | 1 |
| 6 | 10633/00 | HANDLE CROSS, CONTEMPORARY 16PT | 1 |
| 7 | 11674/00 | AERATOR HOUSING, RT SPOUT, TRANS. HEX MODERN | 1 |
| 8 | 90017 | O-RING, 11/16"ID X 13/16"OD X 1/16"THK, AS-568-017 | 1 |
| 9 | 92008 | SET SCREW, CUP POINT 8-32, 3/16" L. | 2 |
| 10 | 92176 | WEAR WASHER | 1 |
| 11 | P05024 | AERATOR CACHE COIN SLOT, M21.5X1.0 FULL FLOW | 1 |
| 12 | P05025 | AERATOR, BASIC KEY, PLASTIC RED | 1 |

| | | | | |
|-----------|------|--------------------|-----------|----------|
| C4 | B | UPDATE HAND SHOWER | 6/14/2023 | LFV |
| ZONE | REV. | DESCRIPTION | DATE | APPROVED |
| REVISIONS | | | | |

1261 LOGAN AVENUE
 COSTA MESA, CALIFORNIA 92626
 PHONE: 714.361.4800
 FAX: 714.617.3120

PHYLIRICH[®]
 Defining Luxury Since 1959

PROPRIETARY AND CONFIDENTIAL
 THE INFORMATION CONTAINED IN THIS DRAWING IS THE SOLE PROPERTY OF PHYLIRICH. ANY REPRODUCTION IN PART OR AS A WHOLE WITHOUT THE WRITTEN PERMISSION OF PHYLIRICH IS PROHIBITED.
DO NOT SCALE DRAWING

**FLOOR MOUNT TUB FILLER W/
 HANDSHOWER SET, SINGLE HOLE TALL,
 HIGH SPOUT W/ CROSS, HEX MODERN**

| | | |
|------------------|------------------------------------|-----------------|
| SIZE A | ASM/PRT NO. 501-46-01/00 | REV B |
| SCALE: 1:7 | WEIGHT: lbs. | SHEET 1 OF 2 |