

NOTE(S):  
 1. PART NUMBER, "/00" DENOTES PART SHALL HAVE FINISH.

2. APPLY NSF COMPLIANT GREASE TO ANY O-RING, SEALING JOINTS, AND/OR PIVOTAL POINTS. G

3. APPLY NSF COMPLIANT LOCTITE TO THREADED AREA. L

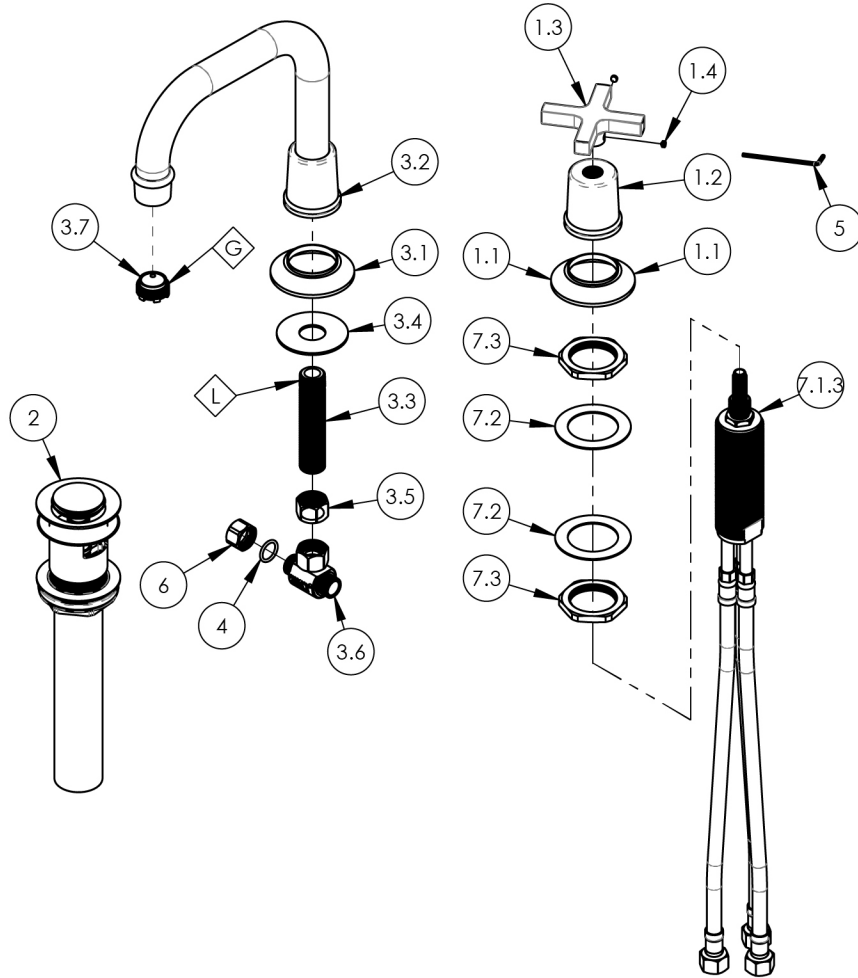

ITEM NO.	PART NUMBER	DESCRIPTION	QTY.
1	3-132/00	CROSS HANDLE, HEX MODERN, 501 SERIES	1
1.1	10921/00	ESCUTCHEON, TRANSITIONAL	1
1.2	10922/00	HUB, FOR HEX TRANSITIONAL	1
1.3	10633/00	HANDLE CROSS, CONTEMPORARY 16PT	1
1.4	92163	SET SCREW, CUP PT 8-32 X 1/8" L	2
2	3-545/00	BRASS PUSH TYPE DRAIN, W/ OVERFLOW & SMALL PLUG	1
3	3-552/00	ASSY, SQUARE SPOUT, WIDESPREAD W/ HARDWARE, HEX MODERN	1
3.1	10921/00	ESCUTCHEON, TRANSITIONAL	1
3.2	2-280/00	ASSY, SQUARE SPOUT, BRAZE, HEX MODERN	1
3.3	10745	THREAD ALL, 3/8"-18 NPSM	1
3.4	92174	WASHER, 1.860 O.D X .690 I.D	1
3.5	10746	NUT, 3/8"-18 NPSL	1
3.6	1-112	TEE VALVE, 3/8" NPSM X 3/8" COMPRESSION	1
3.7	11429	AERATOR CACHE JR, 1.2GPM, M21.5X1.0, 42.2260.450	1
4	90014	O-RING, 1/2"ID X 5/8"OD X 1/16"THK, AS-568-014	1
5	92021	HEX KEY 5/64, FOR 8-32 SET SCREW	1
6	92492	CAP NUT, 3/8" COMPRESSION	1
7	2-581	VALVE KIT, STANDARD MOUNT, SINGLE HANDLE LAV	1
7.1	1-054	VALVE, DECK MOUNTED SINGLE HANDLE LAV DROP-IN	1
7.1.1	12178	BODY, SINGLE HANDLE DECK LAV, PROGRESSIVE, DROP-IN	1
7.1.2	10488	STSR CARTRIDGE ST233, CLOSED TYPE	1
7.1.3	12179	NUT, SINGLE HANDLE DECK VALVE	1
7.1.4	90021	O-RING, 15/16"ID X 1-1/16"OD X 1/16"THK, AS-568-021	1
7.1.5	10561	HOSE, M8 EXT. - 3/8 COMP. X 16" L	3
7.1.6	92157	SCREW, SMALL HD M4X0.7 - 1/2" L	1
7.1.7	12180	STEM ADAPTOR, D-BROACH TO 16PT EXT	1
7.2	92138	BRASS WASHER, THIN	2
7.3	92313	HEX NUT, 1-1/4"-20 THREAD	2

ZONE	REV.	DESCRIPTION	DATE	APPROVED
REVISIONS				

1261 LOGAN AVENUE  
 COSTA MESA, CALIFORNIA 92626  
 PHONE: 714.361.4800  
 FAX: 714.617.3120

**PHYLIRICH**<sup>®</sup>  
 Defining Luxury Since 1959

PROPRIETARY AND CONFIDENTIAL  
 THE INFORMATION CONTAINED IN THIS DRAWING IS THE SOLE PROPERTY OF PHYLIRICH. ANY REPRODUCTION IN PART OR AS A WHOLE WITHOUT THE WRITTEN PERMISSION OF PHYLIRICH IS PROHIBITED.  
 DO NOT SCALE DRAWING

WIDESPREAD LAV, SQUARE SPOUT,  
 SINGLE CROSS HANDLE, HEX MODERN

SIZE <b>A</b>	ASM/PRT NO. 501-09/00	REV -
SCALE: 1:5	WEIGHT: lbs.	SHEET 1 OF 2