

NOTE(S):

1. EXAMPLE OF SPLIT FINISH CODE:  
A. 4-710/026X030
2. MARBLE HANDLE STONE OPTIONS:  
A. BLACK MARBLE = 3-820 (.../00X030)  
B. WHITE MARBLE = 3-826 (.../00X031)
3. APPLY NSF COMPLIANT GREASE TO ANY O-RING, SEALING JOINTS, AND/OR PIVOTAL POINTS.
4. APPLY NSF COMPLIANT LOCTITE TO THREADED AREA.

G

L

SEE NOTES\*

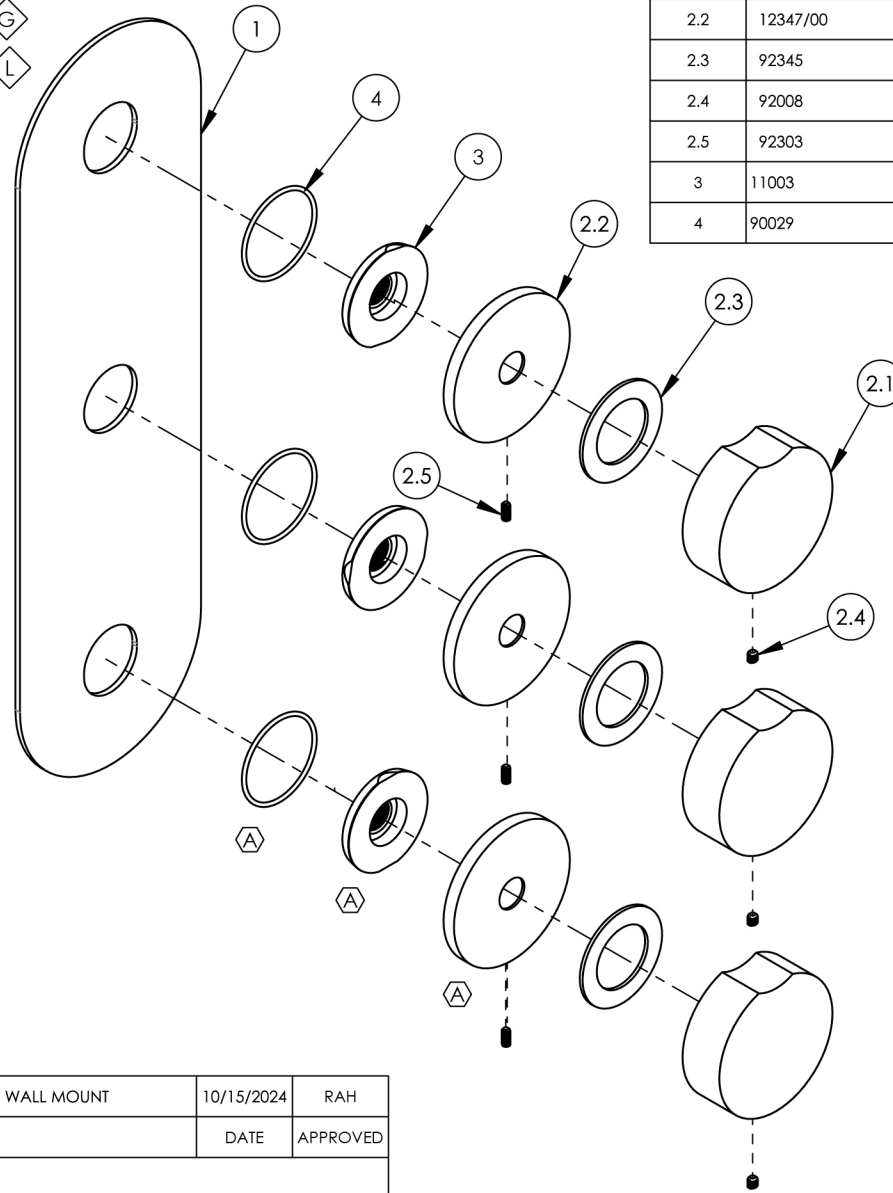

ITEM NO.	PART NUMBER	DESCRIPTION	QTY.
1	11757/00	TRIM PLATE, THREE HOLE, ROND	1
2	3-820/00	ASSY, ROUND BLACK MARBLE HANDLE, CIRC	3
2.1	2-408	BLACK MARBLE HANDLE, BROACH INSERT, ASSY	1
2.2	12347/00	ESCUTCHEON BASE, DECK TUB, CIRC	1
2.3	92345	WASHER	1
2.4	92008	SET SCREW, CUP POINT 8-32, 3/16" L.	1
2.5	92303	SET SCREW, CUP POINT 6-32 X 5/16" L	1
3	11003	SLEEVE MOUNT, WALL MT WIDESPREAD	3
4	90029	O-RING, 1-5/8"ID X 1-3/4"OD X 1/16"THK, AS-568-029	3

B3, B4	A	ADDED COMPONENTS FOR STANDARD WALL MOUNT	10/15/2024	RAH
ZONE	REV.	DESCRIPTION	DATE	APPROVED

REVISIONS

1261 LOGAN AVENUE  
COSTA MESA, CALIFORNIA 92626  
PHONE: 714.361.4800  
FAX: 714.617.3120

**PHYLIRICH**<sup>®</sup>  
Defining Luxury Since 1959

PROPRIETARY AND CONFIDENTIAL  
THE INFORMATION CONTAINED IN THIS DRAWING IS THE SOLE PROPERTY OF PHYLIRICH. ANY REPRODUCTION IN PART OR AS A WHOLE WITHOUT THE WRITTEN PERMISSION OF PHYLIRICH IS PROHIBITED.  
DO NOT SCALE DRAWING

ASSY, SHOWER TRIM PLATE, THREE HANDLE, ROUND MARBLE HANDLE, CIRC

SIZE <b>A</b>	ASM/PRT NO. 4-713/00	REV -
SCALE: 1:3	WEIGHT: lbs.	SHEET 1 OF 2