

- NOTE(S):
- PART NUMBER, "/00" DENOTES PART SHALL HAVE FINISH.
 - APPLY NSF COMPLIANT GREASE TO ANY O-RING, SEALING JOINTS, AND/OR PIVOTAL POINTS. G
 - APPLY NSF COMPLIANT LOCTITE TO THREADED AREA. L
 - APPLY NSF COMPLIANT REMOVABLE (BLUE) LOCTITE TO THREADED AREA. B
 - SILVER SOLDER JOINTS SHALL BE FULLY WETTED VIA CAPILLARY ACTION AND COMPLETELY NON-POROUS. S
 - FOR DEEPEER ESCUTCHEON:
 - 3-601/00
 - 92401 B

| ITEM NO. | PART NUMBER | DESCRIPTION | QTY. |
|----------|-------------|--|------|
| 1 | 3-595/00 | ASSY, BLADE HANDLE, DIAMA | 3 |
| 1.1 | 11762/00 | BLADE HANDLE, DIAMA | 1 |
| 1.2 | 11764/00 | ESCUTCHEON, HANDLE, DIAMA | 1 |
| 1.3 | 92005 | SET SCREW, CUP PT 6-32 UNC THREAD 3/16"L | 1 |
| 1.4 | 92176 | WEAR WASHER | 2 |
| 1.5 | 92177 | RETAINING RING, 7/16" SHAFT | 1 |
| 2 | 11003 | SLEEVE MOUNT, WALL MT WIDESPREAD | 3 |
| 3 | 11761/00 | TRIM PLATE, 3 HOLE, DIAMA | 1 |
| 4 | 90029 | O-RING, 1-5/8"ID X 1-3/4"OD X 1/16"THK, AS-568-029 | 3 |

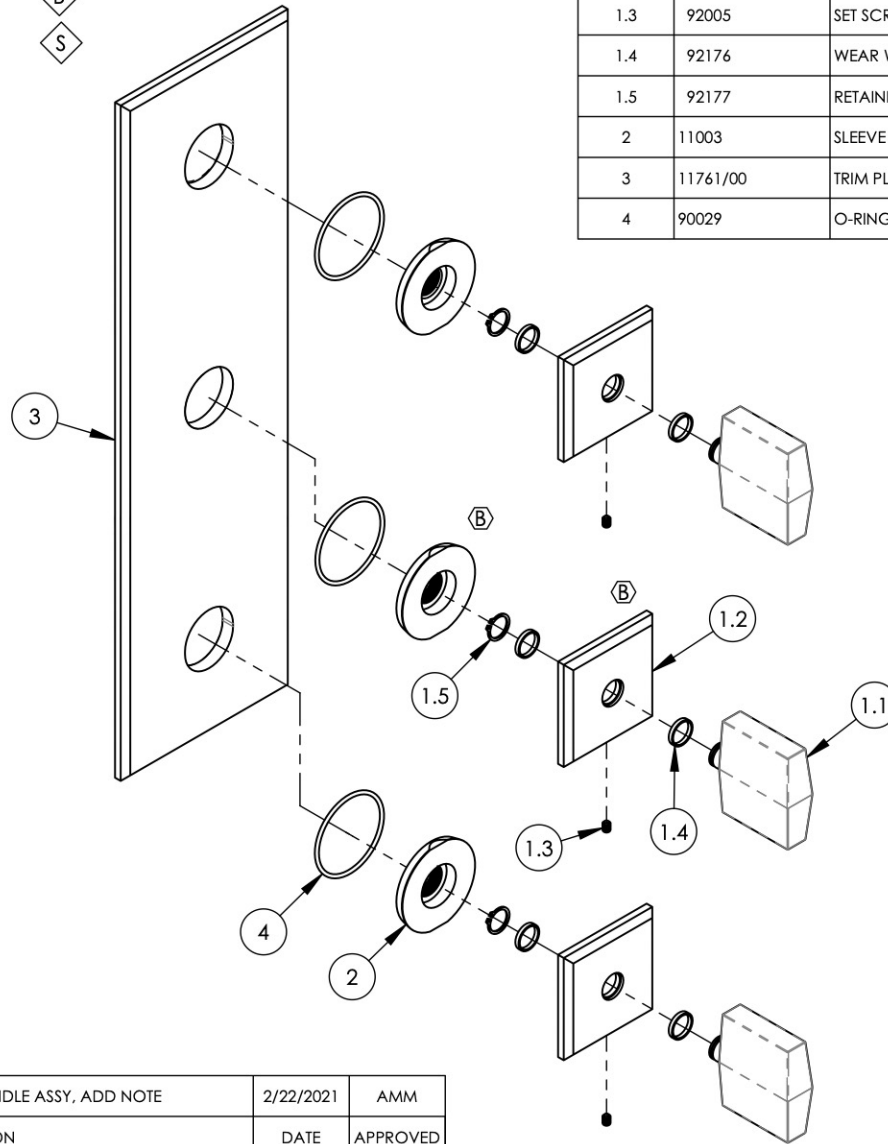

| ZONE | REV. | DESCRIPTION | DATE | APPROVED |
|-----------|------|---|-----------|----------|
| C3, D5 | B | UPDATE SLEEVE MOUNT & HANDLE ASSY, ADD NOTE | 2/22/2021 | AMM |
| REVISIONS | | | | |

1261 LOGAN AVENUE
COSTA MESA, CALIFORNIA 92626
PHONE: 714.361.4800
FAX: 714.617.3120

PHYLIRICH[®]
Defining Luxury Since 1959

PROPRIETARY AND CONFIDENTIAL
THE INFORMATION CONTAINED IN THIS DRAWING IS THE SOLE PROPERTY OF PHYLIRICH. ANY REPRODUCTION IN PART OR AS A WHOLE WITHOUT THE WRITTEN PERMISSION OF PHYLIRICH IS PROHIBITED.
DO NOT SCALE DRAWING

ASSY, 3 HOLE TRIM, BLADE HANDLES,
DIAMA

| | | |
|------------------|-------------------------|--------------|
| SIZE A | ASM/PRT NO. 4-563/00 | REV B |
| SCALE: 1:3.25 | WEIGHT: lbs. | SHEET 1 OF 2 |