

NOTE(S):
 1. FOR DEEPER ESCUTCHEON:
 A. 3-353/00
 B. 92401

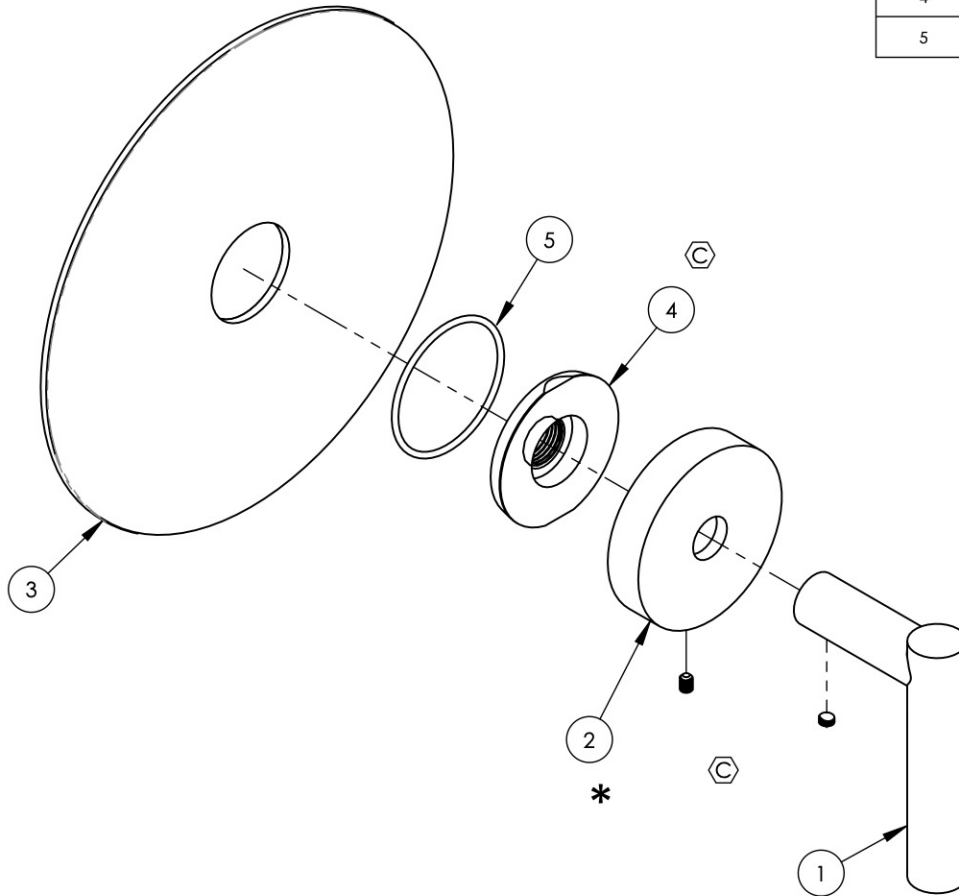

ITEM NO.	PART NUMBER	DESCRIPTION	QTY.
1	3-581/00	HANDLE LEVER W/ SET SCREW, TRANSITION	1
* 2	3-590/00	ESCUTCHEON W/ SET SCREW, TRANSITION	1
3	10443/00	TRIM PLATE 6" ROUND, BASIC II	1
4	11003	SLEEVE MOUNT, WALL MT WIDESPREAD	1
5	90029	O-RING, 1-5/8"ID X 1-3/4"OD X 1/16"THK, AS-568-029	1



ZONE	REV.	DESCRIPTION	DATE	APPROVED
C3, E5	C	REVERT BACK TO OLD SLEEVE MOUNT & ESCUTCHEON HUB, ADD NOTES	3/13/2020	AMM
REVISIONS				

1261 LOGAN AVENUE
 COSTA MESA, CALIFORNIA 92626
 PHONE: 714.361.4800
 FAX: 714.617.3120

PHYLIRICH[®]
 Defining Luxury Since 1959

PROPRIETARY AND CONFIDENTIAL
 THE INFORMATION CONTAINED IN THIS DRAWING IS THE SOLE PROPERTY OF PHYLIRICH. ANY REPRODUCTION IN PART OR AS A WHOLE WITHOUT THE WRITTEN PERMISSION OF PHYLIRICH IS PROHIBITED.

NEXT ASSY	USED ON	FRACTIONS	DECIMALS	ANGULAR
-	-	±1/16"	X.X: ±.1 X.XX: ±.01 X.XXX: ±.005	±2°
APPLICATION		MATERIAL	NAME	DATE
FINISH		DRAWN	AMM	9/9/2019
DO NOT SCALE DRAWING		CHECKED		

INTERPRET GEOMETRIC DIMENSIONING & TOLERANCING IN ACCORDANCE WITH ASME Y14.5-2009 & ASME Y14.41-2003 STANDARDS, UNLESS OTHERWISE SPECIFIED. DIMENSIONS ARE IN INCHES. TOLERANCES ARE:

SHOWER PLATE ONLY, LEVER HANDLE, TRANSITION

SIZE **A** ASM/PRT NO. **4-500/00** REV **C**

SCALE: 1:2 WEIGHT: lbs. SHEET 1 OF 2