

- NOTE(S):
- PART NUMBER, "/00" DENOTES PART SHALL HAVE FINISH.
  - APPLY NSF COMPLIANT GREASE TO ANY O-RING, SEALING JOINTS, AND/OR PIVOTAL POINTS. G
  - APPLY NSF COMPLIANT LOCTITE TO THREADED AREA. L
  - APPLY NSF COMPLIANT REMOVABLE (BLUE) LOCTITE TO THREADED AREA. B
  - SILVER SOLDER JOINTS SHALL BE FULLY WETTED VIA CAPILLARY ACTION AND COMPLETELY NON-POROUS. S
  - FOR DEEPER ESCUTCHEON:
    - 3-119/00
    - 92401

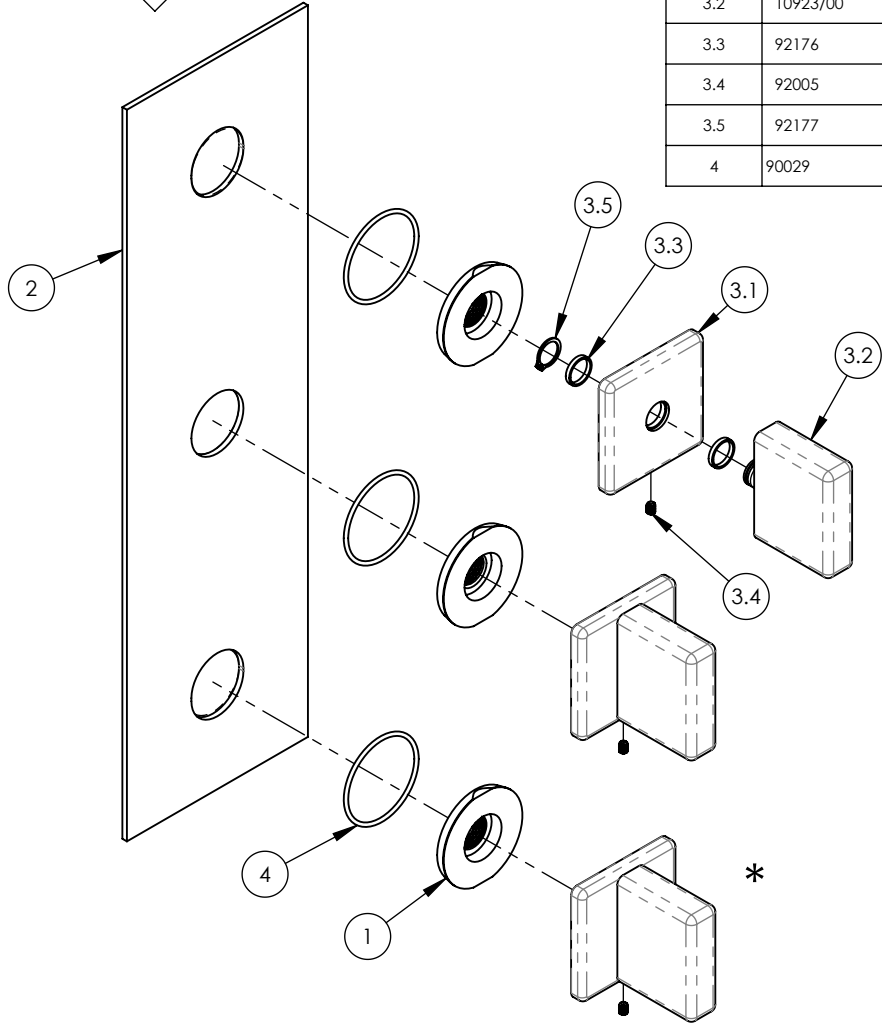

ITEM NO.	PART NUMBER	DESCRIPTION	QTY.
1	11003	SLEEVE MOUNT, WALL MT WIDESPREAD	3
2	11933/00	TRIM PLATE, 3 HOLE, TRANSITION	1
3	3-101/00	ASSY, HANDLE BLADE MIX	3
3.1	10932/00	ESCUTCHEON, HANDLE MIX SERIES	1
3.2	10923/00	HANDLE, BLADE MIX SERIES	1
3.3	92176	WEAR WASHER	2
3.4	92005	SET SCREW, CUP PT 6-32 UNC THREAD 3/16"L	1
3.5	92177	RETAINING RING, 7/16" SHAFT	1
4	90029	O-RING, 1-5/8"ID X 1-3/4"OD X 1/16"THK, AS-568-029	3



ZONE	REV.	DESCRIPTION	DATE	APPROVED
REVISIONS				

1261 LOGAN AVENUE  
COSTA MESA, CALIFORNIA 92626  
PHONE: 714.361.4800  
FAX: 714.617.3120

**PHYLIRICH**<sup>®</sup>  
Defining Luxury Since 1959

**PROPRIETARY AND CONFIDENTIAL**  
THE INFORMATION CONTAINED IN THIS DRAWING IS THE SOLE PROPERTY OF PHYLIRICH. ANY REPRODUCTION IN PART OR AS A WHOLE WITHOUT THE WRITTEN PERMISSION OF PHYLIRICH IS PROHIBITED.  
**DO NOT SCALE DRAWING**

THERM, SHOWER TRIM, THREE HANDLE, BLADE, MIX

SIZE <b>A</b>	ASM/PRT NO. 4-215/00	REV -
SCALE: 1:3	WEIGHT: lbs.	SHEET 1 OF 2

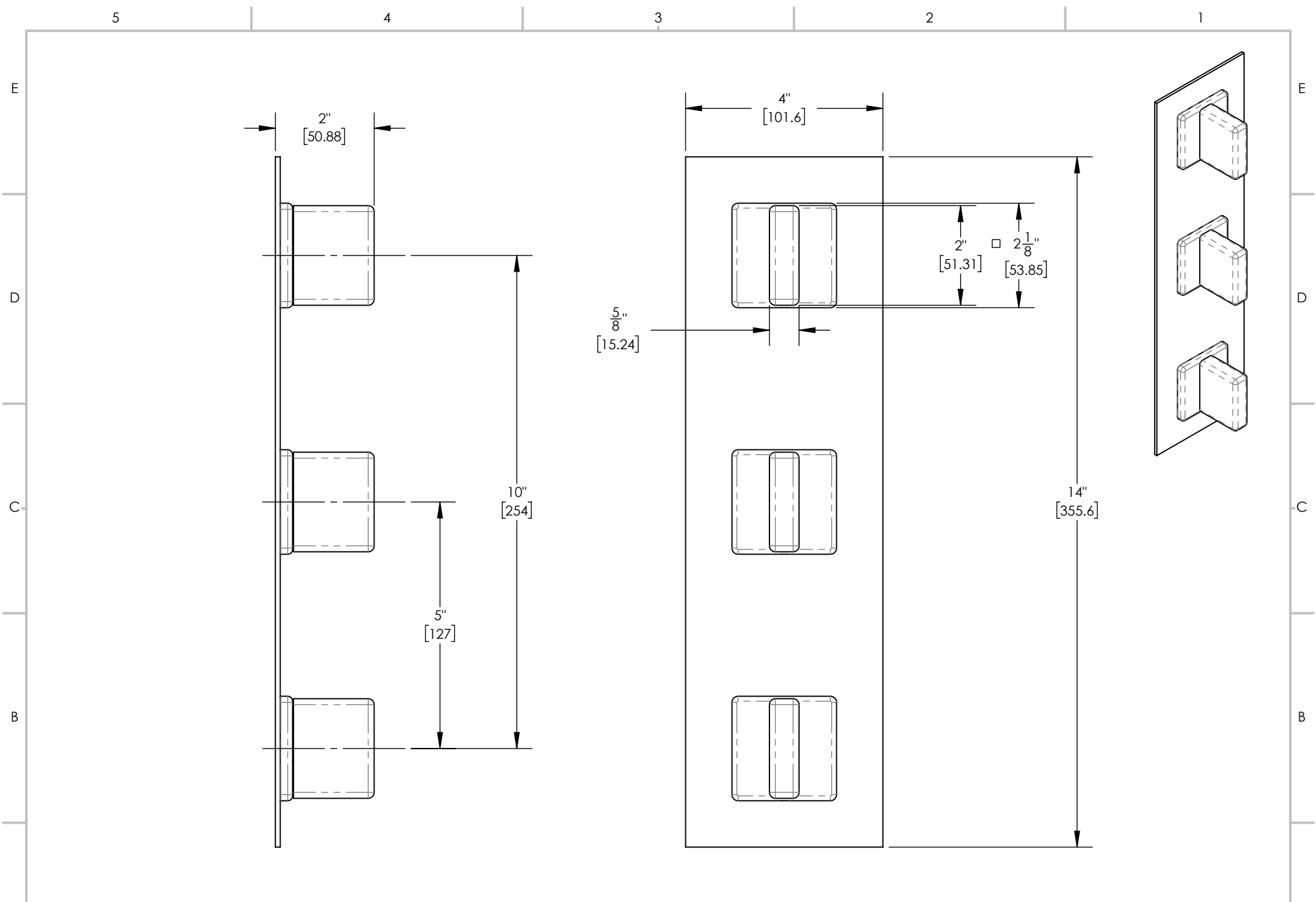

1261 LOGAN AVENUE  
 COSTA MESA, CALIFORNIA 92626  
 PHONE: 714.361.4800  
 FAX: 714.617.3120

**PHYLIRICH**<sup>®</sup>  
 Defining Luxury Since 1959

**PROPRIETARY AND CONFIDENTIAL**  
 THE INFORMATION CONTAINED IN THIS DRAWING IS THE SOLE PROPERTY OF PHYLIRICH. ANY REPRODUCTION IN PART OR AS A WHOLE WITHOUT THE WRITTEN PERMISSION OF PHYLIRICH IS PROHIBITED.  
**DO NOT SCALE DRAWING**

**THERM, SHOWER TRIM, THREE HANDLE, BLADE, MIX**

<b>SIZE</b> <b>A</b>	<b>ASM/PRT NO.</b> 4-215/00	<b>REV</b> -
SCALE: 1:2.5	WEIGHT: lbs.	SHEET 2 OF 2

A

A