

5

4

3

2

1

E

E

D

D

C

C

B

B

A

A

ITEM NO.	PART NUMBER	DESCRIPTION	QTY.
1	11087	SLEEVE FOR PB-THERM PLATE	2
2	11266/00	PLATE, TWO HANDLE, COINED	1
3	3-317/00	LEVER HANDLE, COINED SERIES	2
3.1	10978/00	ESCUTCHEON HANDLE BASE COINED, 3RING, COINED SERIES	1
3.2	10972/00	HUB, TRANSITIONAL 3RING	1
3.3	10977/00	HANDLE, STRAIGHT LEVER COINED, 3RING	1
3.4	92163	SET SCREW, CONE PT 8-32 X 1/8"L	1
3.5	90138	O-RING, 2 1/8"ID X 3/32"THK., AS-568-138	1

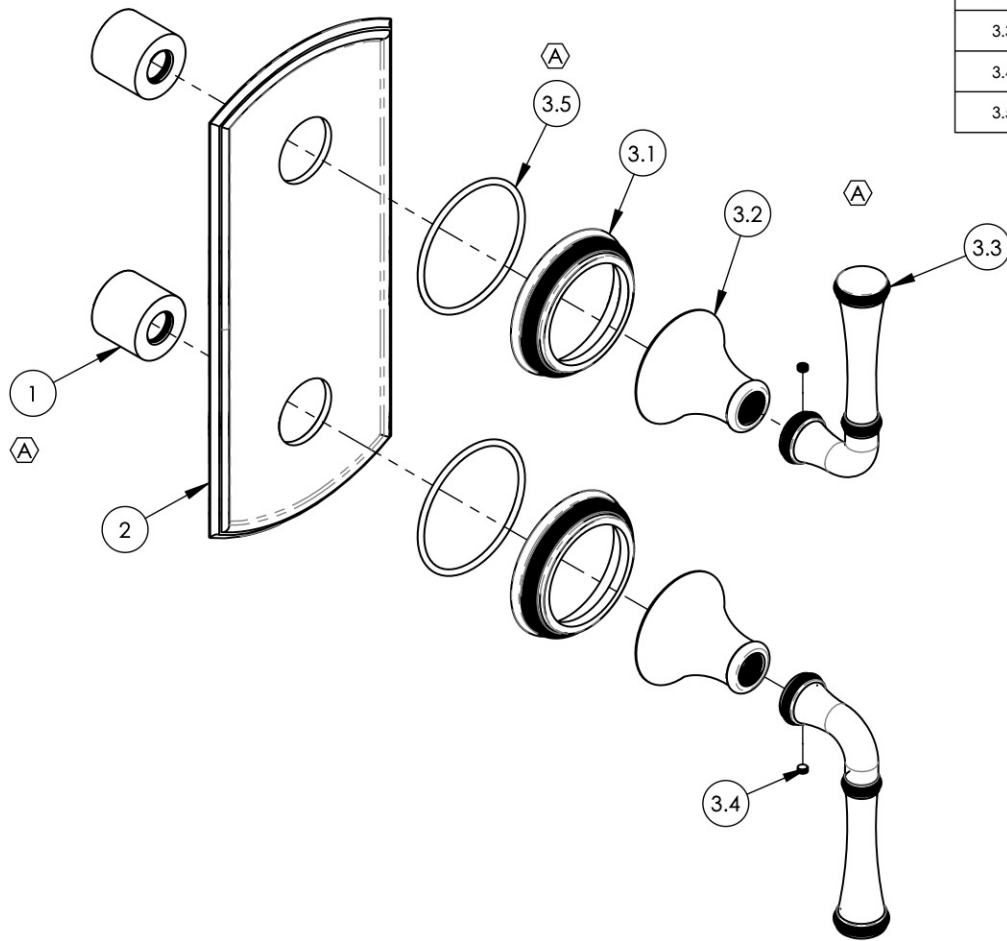

ALL	REV.	DESCRIPTION	DATE	APPROVED
A		UPDATE TEMPLATE, ADD O-RING, SLEEVE MOUNT, REMOVE HEX KEY	4/8/2020	AMM

1261 LOGAN AVENUE
COSTA MESA, CALIFORNIA 92626
PHONE: 714.361.4800
FAX: 714.617.3120

PHYLIRICH®

Defining Luxury Since 1959

PROPRIETARY AND CONFIDENTIAL
THE INFORMATION CONTAINED IN THIS DRAWING IS THE SOLE PROPERTY OF PHYLIRICH. ANY REPRODUCTION IN PART OR AS A WHOLE WITHOUT THE WRITTEN PERMISSION OF PHYLIRICH IS PROHIBITED.

DO NOT SCALE DRAWING

NEXT ASSY		USED ON		INTERPRET GEOMETRIC DIMENSIONING & TOLERANCING IN ACCORDANCE WITH ASME Y14.5-2009 & ASME Y14.41-2003 STANDARDS, UNLESS OTHERWISE SPECIFIED. DIMENSIONS ARE IN INCHES. TOLERANCES ARE:		
APPLICATION		FRACTIONS	DECIMALS	ANGULAR		
		±1/16"	X.X: ±.1 X.XX: ±.01 X.XXX: ±.005	±2°		
MATERIAL	NAME	DATE				
FINISH	DRAWN	LLO	9/22/2015			
	CHECKED	GRE				

**1/2" MINI THERMOSTATIC VALVE W/
VOLUME CONTROL OR DIVERTER**

SIZE	ASM/PRT NO.	REV
A	4-136/00	A

SCALE: 1:3 WEIGHT: lbs. SHEET 1 OF 2

5

4

3

2

1