

~~5. SILVER SOLDER JOINTS SHALL BE FULLY WETTED VIA-
CAPILLARY ACTION AND COMPLETELY NON-POROUS.~~

G
L
B
S

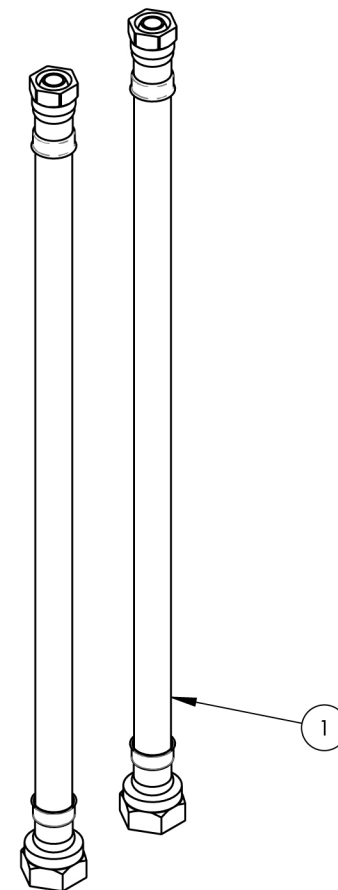
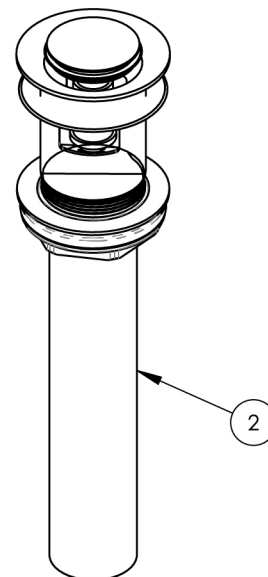
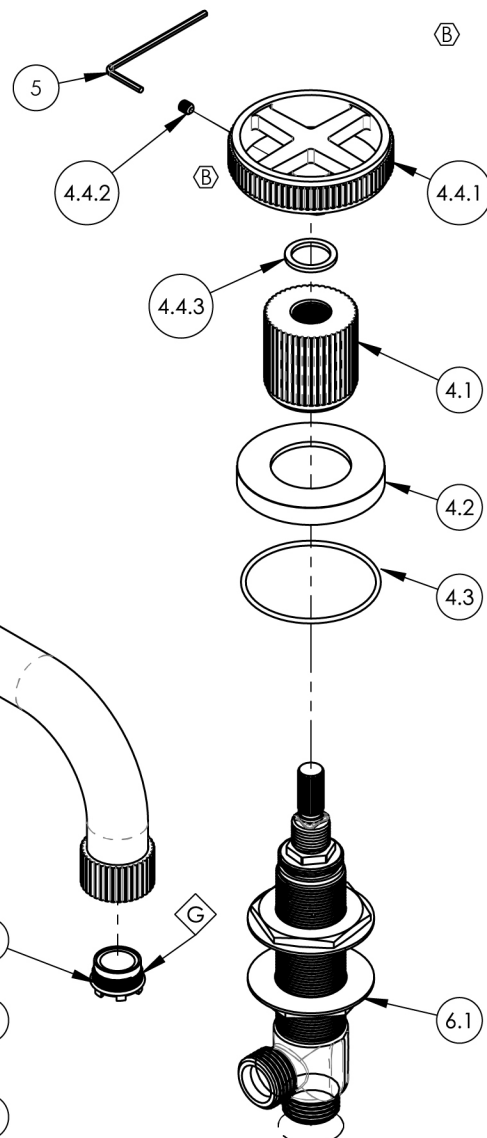
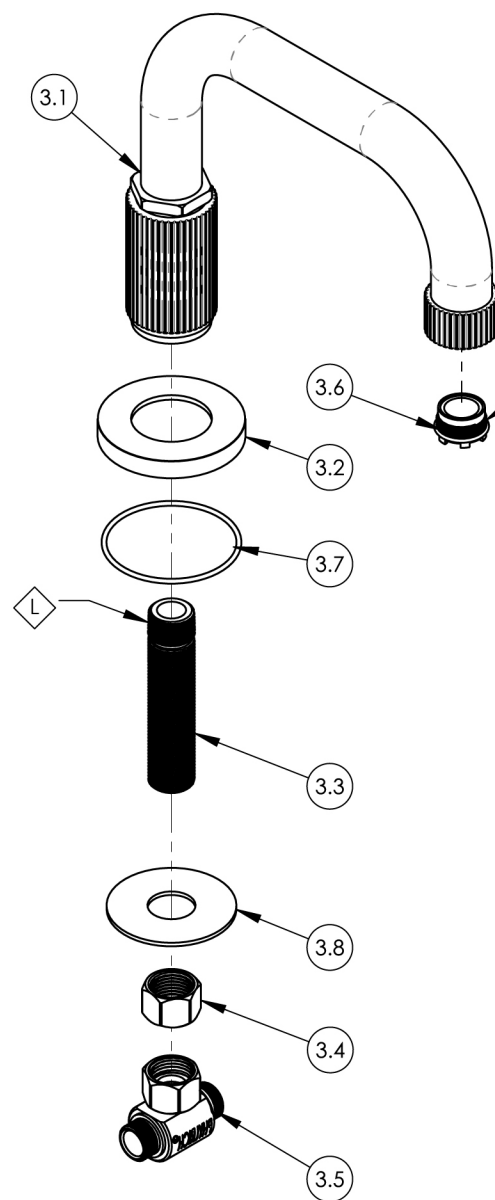
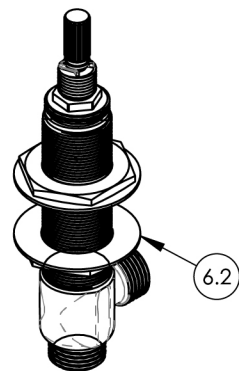

ITEM NO.	PART NUMBER	DESCRIPTION	QTY.
1	10982	HOSE, 3/8" COMP. X 1/2" NPSM - 12'L	2
2	3-545/00	BRASS PUSH TYPE DRAIN, W/ OVERFLOW & SMALL PLUG	1
3	3-618/00	ASSY, SPOUT LOW, GROOVED, DUSTRIE	1
3.1	2-333/00	ASSY, SPOUT, BASE, SLEEVE, GROOVED, BRAZE	1
3.2	11885/00	ESCUTCHEON, DUSTRIE	1
3.3	10745	THREAD ALL, 3/8"-18 NPSL - 3/8"NPT	1
3.4	10746	NUT, 3/8"-18 NPSL	1
3.5	1-112	TEE VALVE, 3/8" NPSM X 3/8" COMPRESSION	1
3.6	11428	AERATOR, CACHE TJ, 1.2GPM PCA PINK, 43.2260.450	1
3.7	90032	O-RING, 1-7/8"ID X 2"OD X 1/16"THK, AS-568-032	1
3.8	92174	WASHER, 1.860 O.D X .690 I.D	1
4	3-617/00	ASSY, HANDLE CROSS, GROOVED, W/ HUB BASE, DUSTRIE	2
4.1	11884/00	HUB, HANDLE, GROOVED, DUSTRIE	1
4.2	11885/00	ESCUTCHEON, DUSTRIE	1
4.3	90032	O-RING, 1-7/8"ID X 2"OD X 1/16"THK, AS-568-032	1
4.4	3-649/00	HANDLE CROSS, GROOVED, W/ HARDWARE, DUSTRIE	1
4.4.1	2-332/00	ASSY, POST & HANDLE , BRAZE	1
4.4.2	92008	SET SCREW, CUP POINT 8-32, 3/16" L.	1
4.4.3	92404	WEAR WASHER, HANDLE	1
5	92021	HEX KEY 5/64, FOR 8-32 SET SCREW	1
6	1-600	WIDESPREAD HOT AND COLD VALVES W/MOUNTING HARDWARE	1
6.1	1-109	WIDESPREAD VALVE LAV 16PT, COLD W/ MOUNTING	1
6.2	1-110	WIDESPREAD VALVE LAV 16PT, HOT W/ MOUNTING	1

D6, A3, E5	B	UPDATED CROSS HANDLE AND SPOUT	3/10/2025	RAH
ZONE	REV.	DESCRIPTION	DATE	APPROVED
REVISIONS				

1261 LOGAN AVENUE
COSTA MESA, CALIFORNIA 92626
PHONE: 714.361.4800
FAX: 714.617.3120

PHYLIRICH[®]
Defining Luxury Since 1959

PROPRIETARY AND CONFIDENTIAL
THE INFORMATION CONTAINED IN THIS DRAWING
IS THE SOLE PROPERTY OF PHYLIRICH. ANY
REPRODUCTION IN PART OR AS A WHOLE
WITHOUT THE WRITTEN PERMISSION OF PHYLIRICH
IS PROHIBITED.
DO NOT SCALE DRAWING

ASSY, WIDESPREAD LAV, LOW SPOUT,
CROSS HANDLE, GROOVED, DUSTRIE

SIZE B	ASM/PRT NO. 370-03/00	REV -
SCALE: 1:2.75	WEIGHT: lbs.	SHEET 1 OF 2