

- NOTE(S):
- PART NUMBER, "/00" DENOTES PART SHALL HAVE FINISH.
 - APPLY NSF COMPLIANT GREASE TO ANY O-RING, SEALING JOINTS, AND/OR PIVOTAL POINTS.
 - APPLY NSF COMPLIANT LOCTITE TO THREADED AREA.
 - APPLY NSF COMPLIANT REMOVABLE (BLUE) LOCTITE TO THREADED AREA.
 - SILVER SOLDER JOINTS SHALL BE FULLY WETTED VIA CAPILLARY ACTION AND COMPLETELY NON-POROUS.

- G
- L
- B
- S

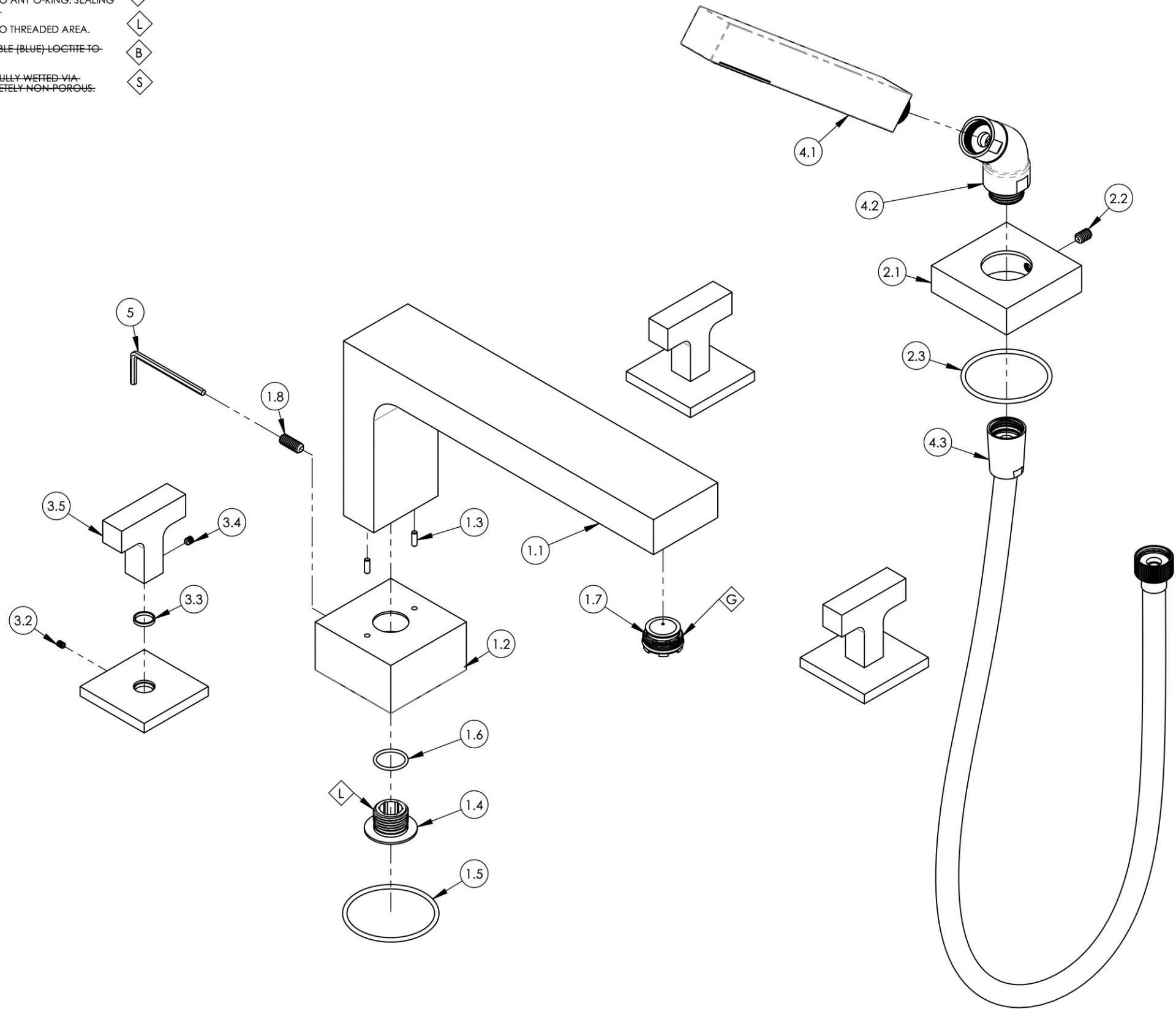

ITEM NO.	PART NUMBER	DESCRIPTION	QTY.
1	3-812/00	ASSEMBLY, SPOUT ROMAN TUB, LOW, CROI	1
1.1	12331/00	SPOUT, DECK TUB, CROI	1
1.2	12332/00	ESCUTCHEON, DECK SPOUT, CROI	1
1.3	92158	DOWEL PIN, 1/8" X 3/8"L	2
1.4	11220	SPUD SCREW, 1/2"-NPSM CONNECTOR	1
1.5	90137	O-RING, 2-1/16"ID X 3/32"THK., AS-568-137	1
1.6	90017	O-RING, 11/16"ID X 13/16"OD X 1/16"THK., AS-568-017	1
1.7	P05051	AERATOR, CACHE COINED SLOT M24X1.0 FULL FLOW	1
1.8	92262	SET SCREW, CUP PT 1/4"-20 X 5/8"L	1
2	3-813/00	ESCUTCHEON BASE, HANDSHOWER, CROI	1
2.1	12337/00	ESCUTCHEON BASE, DECK TUB, HANDSHOWER, CROI	1
2.2	92173	SET SCREW, CUP PT, 1/4"-20 X 3/8" L	1
2.3	90135	O-RING, 1-15/16"ID X 3/32"THK., AS-568-135	1
3	3-799/00	ASSY, LEVER HANDLE, CROI SERIES	3
3.1	10937/00	ESCUTCHEON, HANDLE EDGE SERIES	1
3.2	92005	SET SCREW, CUP PT 6-32 UNC THREAD 3/16"L	1
3.3	92176	WEAR WASHER	1
3.4	92008	SET SCREW, CUP POINT 8-32, 3/16" L.	1
3.5	12298/00	LEVER HANDLE, CROI	1
4	4-522/00	HAND SHOWER HEAD, HOSE, ELBOW, SQUARE, WAVELAND	1
4.1	3-600/00	HAND SHOWER, SQUARE, MODERN	1
4.2	3-050/00	ELBOW ASSEMBLY	1
4.3	3-049/00	ASSY, HOSE KIT, HANDSHOWER	1
5	92216	HEX L-KEY 1/8" HEX X 2-5/16"L	1

REVISIONS				
ZONE	REV.	DESCRIPTION	DATE	APPROVED
8				
7				

1261 LOGAN AVENUE
COSTA MESA, CALIFORNIA 92626
PHONE: 714.361.4800
FAX: 714.617.3120

PHYLIRICH[®]
Defining Luxury Since 1959

PROPRIETARY AND CONFIDENTIAL
THE INFORMATION CONTAINED IN THIS DRAWING IS THE SOLE PROPERTY OF PHYLIRICH. ANY REPRODUCTION IN PART OR AS A WHOLE WITHOUT THE WRITTEN PERMISSION OF PHYLIRICH IS PROHIBITED.
DO NOT SCALE DRAWING

DECK TUB SET w/ HAND SHOWER. LEVER, CROI

SIZE B	ASM/PRT NO. 255-49/00	REV
SCALE: 1:2.75	WEIGHT: lbs.	SHEET 1 OF 2