

NOTE(S):  
1. PART NUMBER, "/00" DENOTES PART SHALL HAVE FINISH.

2. APPLY NSF COMPLIANT GREASE TO ANY O-RING, SEALING JOINTS, AND/OR PIVOTAL POINTS.

3. APPLY NSF COMPLIANT LOCTITE TO THREADED AREA.

4. APPLY NSF COMPLIANT REMOVABLE (BLUE) LOCTITE TO THREADED AREA.

5. SILVER SOLDER JOINTS SHALL BE FULLY WETTED VIA CAPILLARY ACTION AND COMPLETELY NON-POROUS.

G

L

B

S

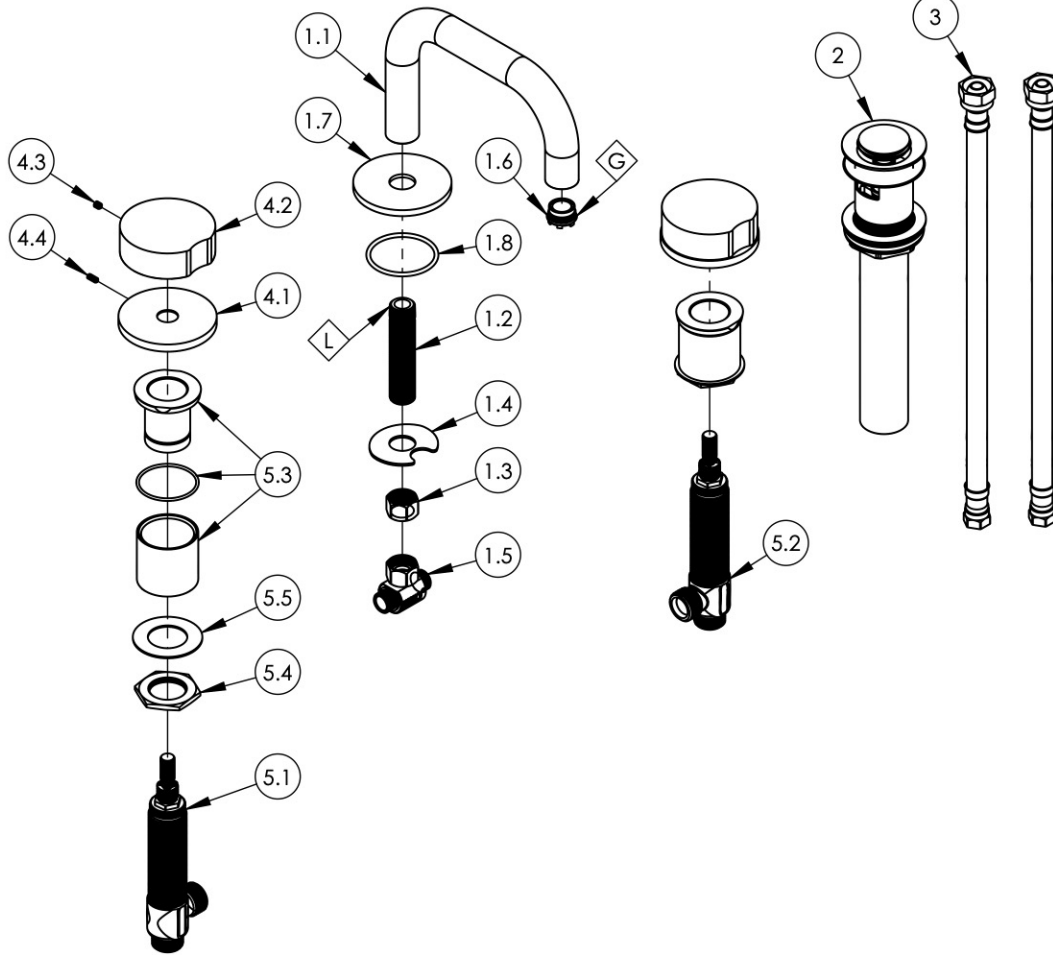

ITEM NO.	PART NUMBER	DESCRIPTION	QTY.
1	3-784/00	LOW SQUARE SPOUT, LAV	1
1.1	11704/00	SPOUT, SQUARE, WIDESPREAD	1
1.2	10745	THREAD ALL, 3/8"-18 NPSL - 3/8"NPT	1
1.3	10746	NUT, 3/8"-18 NPSL	1
1.4	92174	WASHER MOUNT WIDESPREAD (3/8")	1
1.5	1-112	TEE VALVE, 3/8" NPSM X 3/8" COMPRESSION	1
1.6	11428	AERATOR, CACHE TJ, 1.2GPM PCA PINK, 43.2260.450	1
1.7	30555/00	ESCUTCHEON, LAV SPOUT, FRONT STREET	1
1.8	90131	O-RING, 1-11/16ID X 3/32THK, AS-568-131	1
2	3-545/00	BRASS PUSH TYPE DRAIN, W/ OVERFLOW & SMALL PLUG	1
3	10982	HOSE, 3/8" COMP. X 1/2" NPSM - 12"L	2
4	3-819/00	ASSY, ROUND BRASS HANDLE, CIRC	2
4.1	12347/00	ESCUTCHEON BASE, DECK TUB, CIRC	1
4.2	12175/00	ROUND HANDLE, BRASS	1
4.3	92008	SET SCREW, CUP POINT 8-32, 3/16" L.	1
4.4	92303	SET SCREW, CUP POINT 6-32 X 5/16" L	1
5	1-700	WIDESPREAD VALVE 16PT, HOT & COLD, W/ FLUSH MOUNTING KITS	1
5.1	1-149	WIDESPREAD VALVE LAV 16PT, HOT, ONLY	1
5.2	1-150	WIDESPREAD VALVE LAV 16PT, COLD, ONLY	1
5.3	2-410	RECESSED FLUSHED MOUNTING KIT FOR WIDESPREAD W/O WASHER/NUT	2
5.4	92251	HEX NUT, 1"-20 THREAD	2
5.5	92252	WASHER, 1-1/32" ID 1-13/16" OD	2

1261 LOGAN AVENUE  
COSTA MESA, CALIFORNIA 92626  
PHONE: 714.361.4800  
FAX: 714.617.3120

**PHYLIRICH**<sup>®</sup>  
Defining Luxury Since 1959

**PROPRIETARY AND CONFIDENTIAL**  
THE INFORMATION CONTAINED IN THIS DRAWING IS THE SOLE PROPERTY OF PHYLIRICH. ANY REPRODUCTION IN PART OR AS A WHOLE WITHOUT THE WRITTEN PERMISSION OF PHYLIRICH IS PROHIBITED.  
**DO NOT SCALE DRAWING**

**WIDESPREAD FAUCET, LOW SPOUT,  
ROUND BRASS HANDLE, CIRC**

SIZE <b>A</b>	ASM/PRT NO. <b>250L-01/00</b>	REV -
SCALE: 1:5	WEIGHT: lbs.	SHEET 1 OF 2