

NOTE(S):

1. EXAMPLE OF SPLIT FINISH CODE:
A. 4-710/026X030
2. MARBLE HANDLE STONE OPTIONS:
A. BLACK MARBLE = 3-820 (.../00X030)
B. WHITE MARBLE = 3-826 (.../00X031)
3. APPLY NSF COMPLIANT GREASE TO ANY O-RING, SEALING JOINTS, AND/OR PIVOTAL POINTS.
4. APPLY NSF COMPLIANT LOCTITE TO THREADED AREA.

SEE NOTES*

ITEM NO.	PART NUMBER	DESCRIPTION	QTY.
1	3-820/00	ASSY, ROUND BLACK MARBLE HANDLE, CIRC	1
1.1	2-408	BLACK MARBLE HANDLE, BROACH INSERT, ASSY	1
1.2	12347/00	ESCUTCHEON BASE, DECK TUB, CIRC	1
1.3	92345	WASHER	1
1.4	92008	SET SCREW, CUP POINT 8-32, 3/16" L.	1
1.5	92303	SET SCREW, CUP POINT 6-32 X 5/16" L	1
2	11003	SLEEVE MOUNT, WALL MT WIDESPREAD	1
3	90029	O-RING, 1-5/8"ID X 1-3/4"OD X 1/16"THK, AS-568-029	1

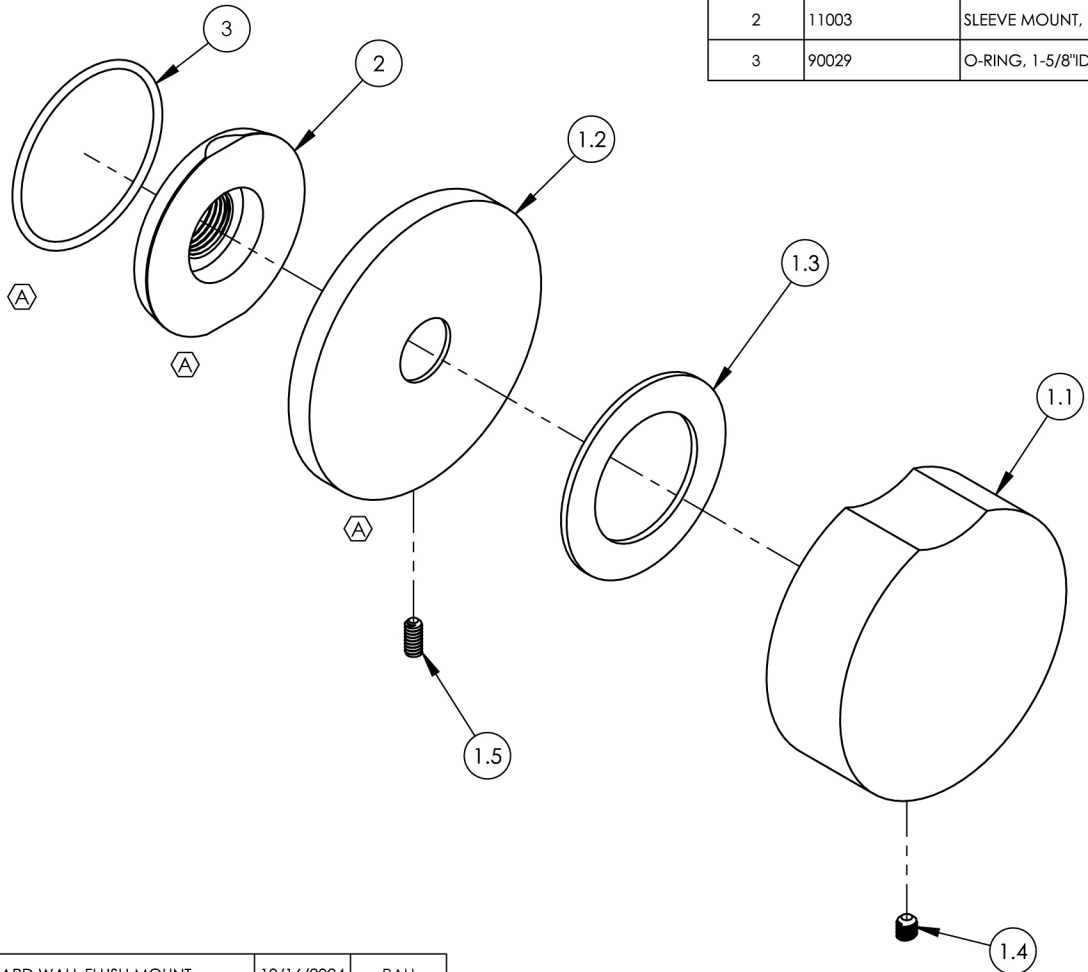

C3, C4, D4	A	ADDED COMPONENTS FOR STANDARD WALL FLUSH MOUNT	10/16/2024	RAH
ZONE	REV.	DESCRIPTION	DATE	APPROVED

REVISIONS

1261 LOGAN AVENUE
COSTA MESA, CALIFORNIA 92626
PHONE: 714.361.4800
FAX: 714.617.3120

PHYLIRICH®
Defining Luxury Since 1959

PROPRIETARY AND CONFIDENTIAL
THE INFORMATION CONTAINED IN THIS DRAWING IS THE SOLE PROPERTY OF PHYLIRICH. ANY REPRODUCTION IN PART OR AS A WHOLE WITHOUT THE WRITTEN PERMISSION OF PHYLIRICH IS PROHIBITED.
DO NOT SCALE DRAWING

ROUND MARBLE HANDLE WALL LAV, MOUNT ASSY, CIRC

SIZE A	ASM/PRT NO. 250-37/00	REV A
SCALE: 1:1.5	WEIGHT: lbs.	SHEET 1 OF 2