

NOTE(S):
 1. PART NUMBER, "/00" DENOTES PART SHALL HAVE FINISH.

ITEM NO.	PART NUMBER	DESCRIPTION	QTY.
1	11555/00	BASE, CABINET KNOB, BASIC II	1
2	11556/00	CABINET KNOB, SMOOTH, BASIC II SERIES	1
3	92094	SCREW, PAN HD 8-32 X 1.5"L	1

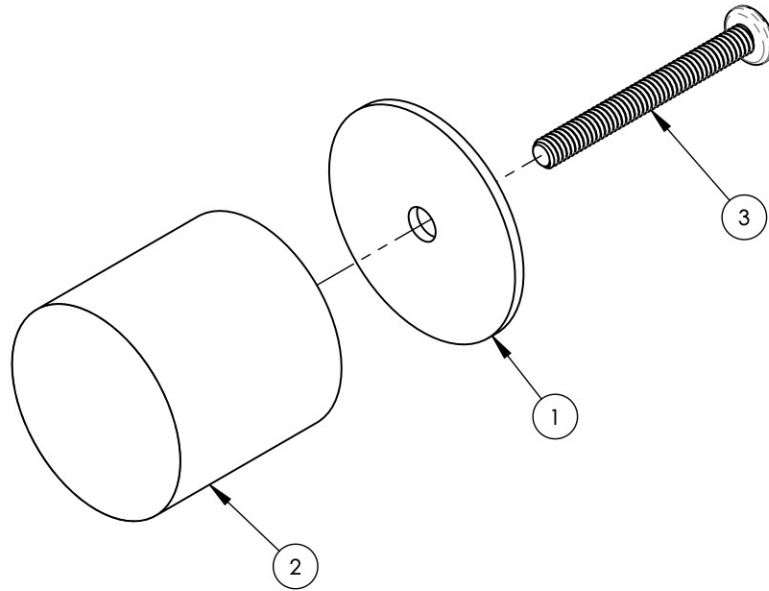

ZONE	REV.	DESCRIPTION	DATE	APPROVED
REVISIONS				

1261 LOGAN AVENUE
 COSTA MESA, CALIFORNIA 92626
 PHONE: 714.361.4800
 FAX: 714.617.3120

PHYL RICH[®]
 Defining Luxury Since 1959

PROPRIETARY AND CONFIDENTIAL
 THE INFORMATION CONTAINED IN THIS DRAWING IS THE SOLE PROPERTY OF PHYL RICH. ANY REPRODUCTION IN PART OR AS A WHOLE WITHOUT THE WRITTEN PERMISSION OF PHYL RICH IS PROHIBITED.

-	-	INTERPRET GEOMETRIC DIMENSIONING & TOLERANCING IN ACCORDANCE WITH ASME Y14.5-2009 & ASME Y14.41-2003 STANDARDS. UNLESS OTHERWISE SPECIFIED, DIMENSIONS ARE IN INCHES. TOLERANCES ARE:	
-	-		
-	-		
NEXT ASSY	USED ON	FRACTIONS ±1/16" DECIMALS X.X: ±.1 X.XX: ±.01 X.XXX: ±.005 ANGULAR ±2°	
APPLICATION			
MATERIAL		NAME	DATE
FINISH		DRAWN	AMM 5/5/2020
DO NOT SCALE DRAWING		CHECKED	

CABINET KNOB, SMOOTH, BASIC II

SIZE **A** ASM/PRT NO. 230-91/00 REV

SCALE: 1:1 WEIGHT: lbs. SHEET 1 OF 2