

- NOTE(S):
1. PART NUMBER, "/00" DENOTES PART SHALL HAVE FINISH.
 2. APPLY NSF COMPLIANT GREASE TO ANY O-RING, SEALING JOINTS, AND/OR PIVOTAL POINTS.
 3. APPLY NSF COMPLIANT LOCTITE TO THREADED AREA.
 4. APPLY NSF COMPLIANT REMOVABLE (BLUE) LOCTITE TO THREADED AREA.
 5. SILVER SOLDER JOINTS SHALL BE FULLY WETTED VIA CAPILLARY ACTION AND COMPLETELY NON-POROUS.

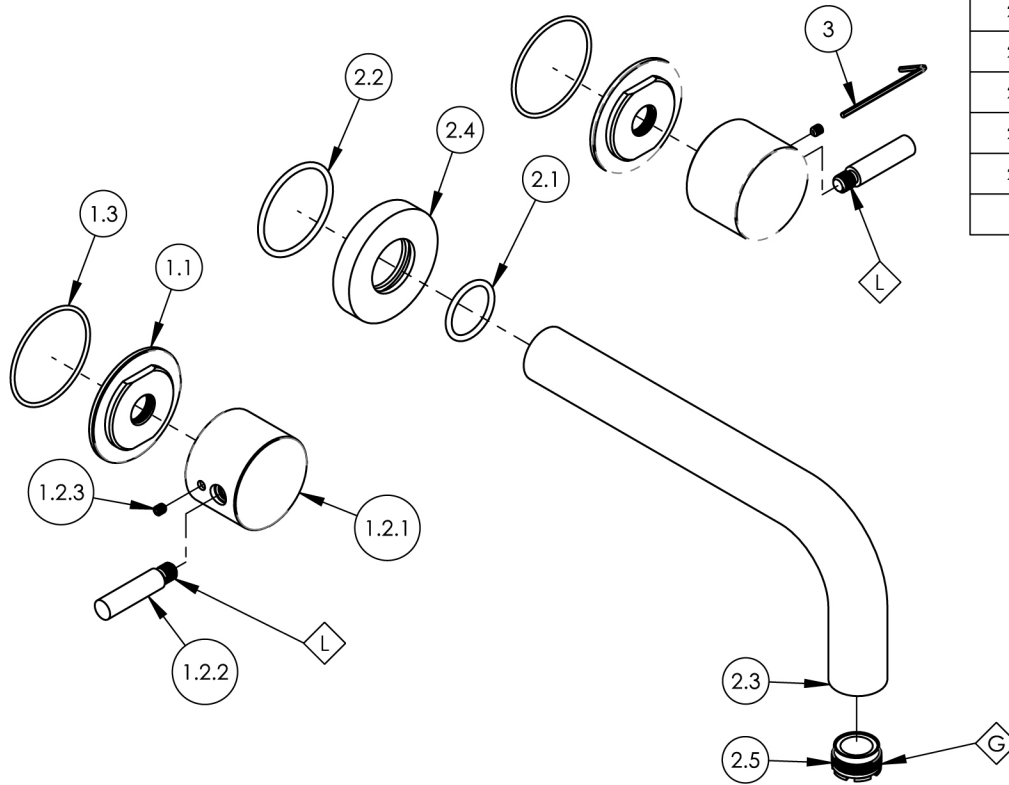

ITEM NO.	PART NUMBER	DESCRIPTION	QTY.	
1	3-339/00	SUB ASSY. LEVER HANDLE, BASIC II	2	
1.1	11164/00	ESCUTCHEON BASE, CONTEMP. BASIC II	1	
1.2	2-249/00	HANDLE LEVER, BASIC II	1	
1.2.1	11167/00	BASE HANDLE, CONTEMP. BASIC II	1	
1.2.2	11168/00	HANDLE LEVER, CONTEMP. BASIC II	1	
1.2.3	92008	SET SCREW, CUP POINT 8-32, 3/16" L.	1	
1.3	90031	O-RING, 1-3/4"ID X 1/16"THK, AS-568-031	1	
2	3-418/00	WALL TUB, SPOUT ONLY, 7-1/2" L, BASIC	1	
2.1	90119	O-RING, 15/16"ID X 1-1/8"OD X 3/32"THK, AS-568-119	1	
2.2	90129	O-RING, 1-9/16"ID X 3/32THK, AS-568-129	1	
2.3	P19018/00	7-1/2" WALL LAV SPOUT, BASIC SERIES	1	
2.4	P19017/00	ESCUTCHEON, FOR SPOUT	1	
2.5	P05024	AERATOR CACHE COIN SLOT, M21.5X1.0 FULL FLOW	1	
3	92021	HEX KEY 5/64, FOR 8-32 SET SCREW	1	



ZONE	REV.	DESCRIPTION	DATE	APPROVED
REVISIONS				

1261 LOGAN AVENUE
COSTA MESA, CALIFORNIA 92626
PHONE: 714.361.4800
FAX: 714.617.3120

PHYLIRICH®
Defining Luxury Since 1959

PROPRIETARY AND CONFIDENTIAL
THE INFORMATION CONTAINED IN THIS DRAWING
IS THE SOLE PROPERTY OF PHYLIRICH. ANY
REPRODUCTION IN PART OR AS A WHOLE
WITHOUT THE WRITTEN PERMISSION OF PHYLIRICH
IS PROHIBITED.
DO NOT SCALE DRAWING

WALL TUB SET, SPOUT 7-1/2" W/ LEVER,
BASIC II

SIZE	ASM/PRT NO.	REV
A	230-59/00	B
SCALE: 1:3.25		WEIGHT: lbs.
		SHEET 1 OF 2