

- NOTE(S):
- EXAMPLE OF SPLIT FINISH CODE:
A. 230-03/026X030
 - MARBLE HANDLE STONE OPTIONS:
A. BLACK MARBLE = 3-570 (.../00X030)
B. WHITE MARBLE = 3-571 (.../00X031)
C. SOAPSTONE = 3-572 (.../00X032)
 - APPLY NSF COMPLIANT GREASE TO ANY O-RING, SEALING JOINTS, AND/OR PIVOTAL POINTS. G
 - APPLY NSF COMPLIANT LOCTITE TO THREADED AREA. L
 - APPLY NSF COMPLIANT REMOVABLE (BLUE) LOCTITE TO THREADED AREA. B
 - SILVER SOLDER JOINTS SHALL BE FULLY WETTED VIA CAPILLARY ACTION AND COMPLETELY NON-POROUS. S

ITEM NO.	PART NUMBER	DESCRIPTION	QTY.
1	11164/00	ESCUTCHEON BASE, CONTEMP. BASIC II	2
2	3-421/00	WALL TUB, SPOUT ONLY, 14" L, BASIC	1
2.1	P19017/00	ESCUTCHEON, FOR SPOUT	1
2.2	90119	O-RING, 15/16"ID X 1-1/8"OD X 3/32"THK, AS-568-119	1
2.3	90129	O-RING, 1-9/16"ID X 3/32THK, AS-568-129	1
2.4	10481/00	14" WALL LAV SPOUT, BASIC SERIES	1
2.5	P05024	AERATOR CACHE COIN SLOT, M21.5X1.0 FULL FLOW	1
3	3-570	HANDLE, ROUND MARBLE, BLACK (030) ASSY	2
4	90031	O-RING, 1-3/4"ID X 1/16"THK, AS-568-031	2
5	92021	HEX KEY 5/64, FOR 8-32 SET SCREW	1

SEE NOTES *

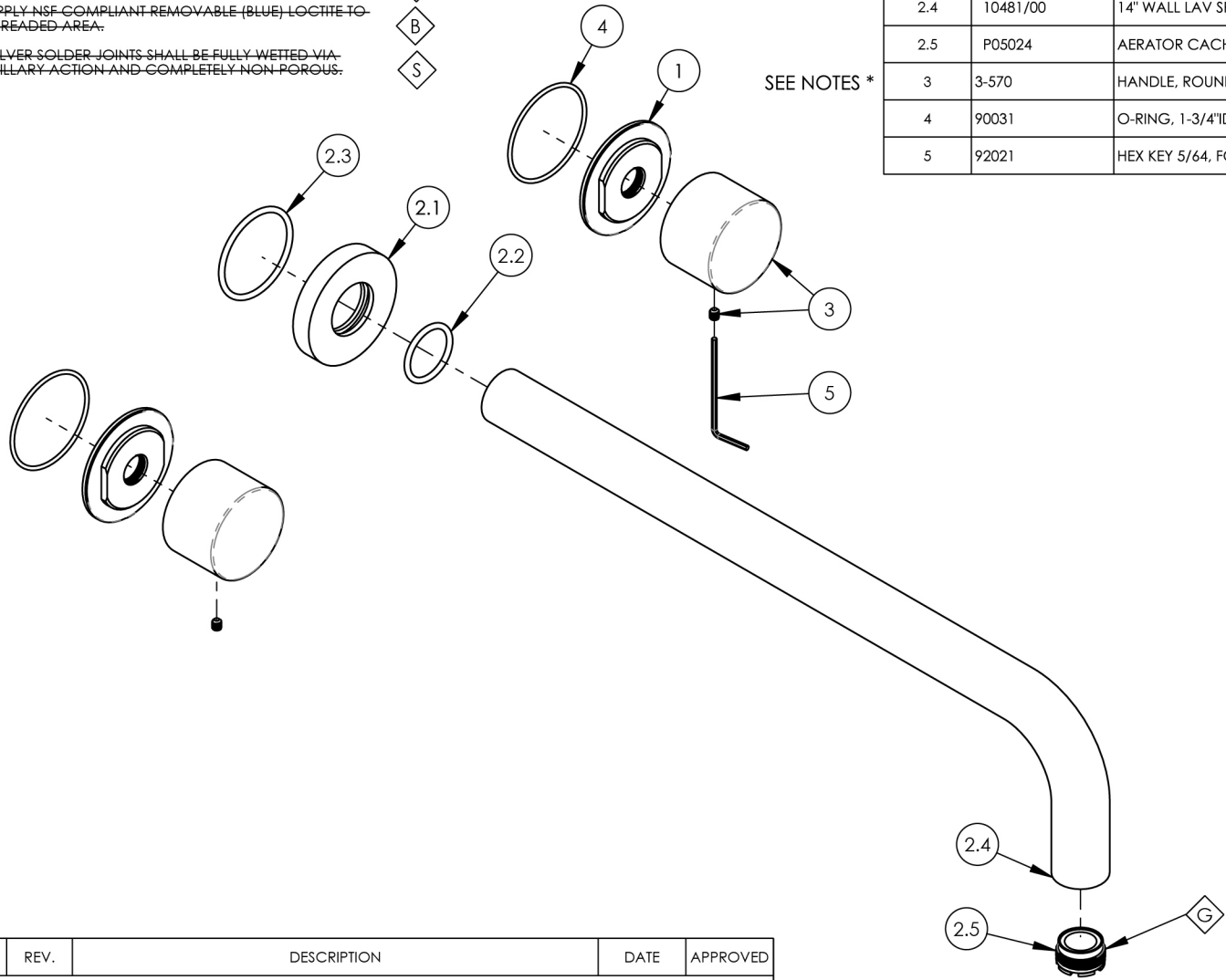

ZONE	REV.	DESCRIPTION	DATE	APPROVED
REVISIONS				

1261 LOGAN AVENUE COSTA MESA, CALIFORNIA 92626 PHONE: 714.361.4800 FAX: 714.617.3120	<h1>PHYL RICH®</h1> <p>Defining Luxury Since 1959</p>	PROPRIETARY AND CONFIDENTIAL THE INFORMATION CONTAINED IN THIS DRAWING IS THE SOLE PROPERTY OF PHYL RICH. ANY REPRODUCTION IN PART OR AS A WHOLE WITHOUT THE WRITTEN PERMISSION OF PHYL RICH IS PROHIBITED. DO NOT SCALE DRAWING
---	---	---

WALL TUB SET, SPOUT 14" W/ MARBLE, BASIC II

SIZE A	ASM/PRT NO. 230-58-14/00	REV -
SCALE: 1:3	WEIGHT: lbs.	SHEET 1 OF 2