

NOTE(S):  
 1. EXAMPLE OF SPLIT FINISH CODE:  
 A. 230-03/026X030

2. MARBLE HANDLE STONE OPTIONS:  
 A. BLACK MARBLE = 3-570 (.../00X030)  
 B. WHITE MARBLE = 3-571 (.../00X031)  
 C. SOAPSTONE = 3-572 (.../00X032)

3. APPLY NSF COMPLIANT GREASE TO ANY O-RING, SEALING JOINTS, AND/OR PIVOTAL POINTS.

4. APPLY NSF COMPLIANT LOCTITE TO THREADED AREA.

5. APPLY NSF COMPLIANT REMOVABLE (BLUE) LOCTITE TO THREADED AREA.

6. SILVER SOLDER JOINTS SHALL BE FULLY WETTED VIA CAPILLARY ACTION AND COMPLETELY NON-POROUS.

◇ G  
 ◇ L  
 ◇ B  
 ◇ S

SEE NOTES\*

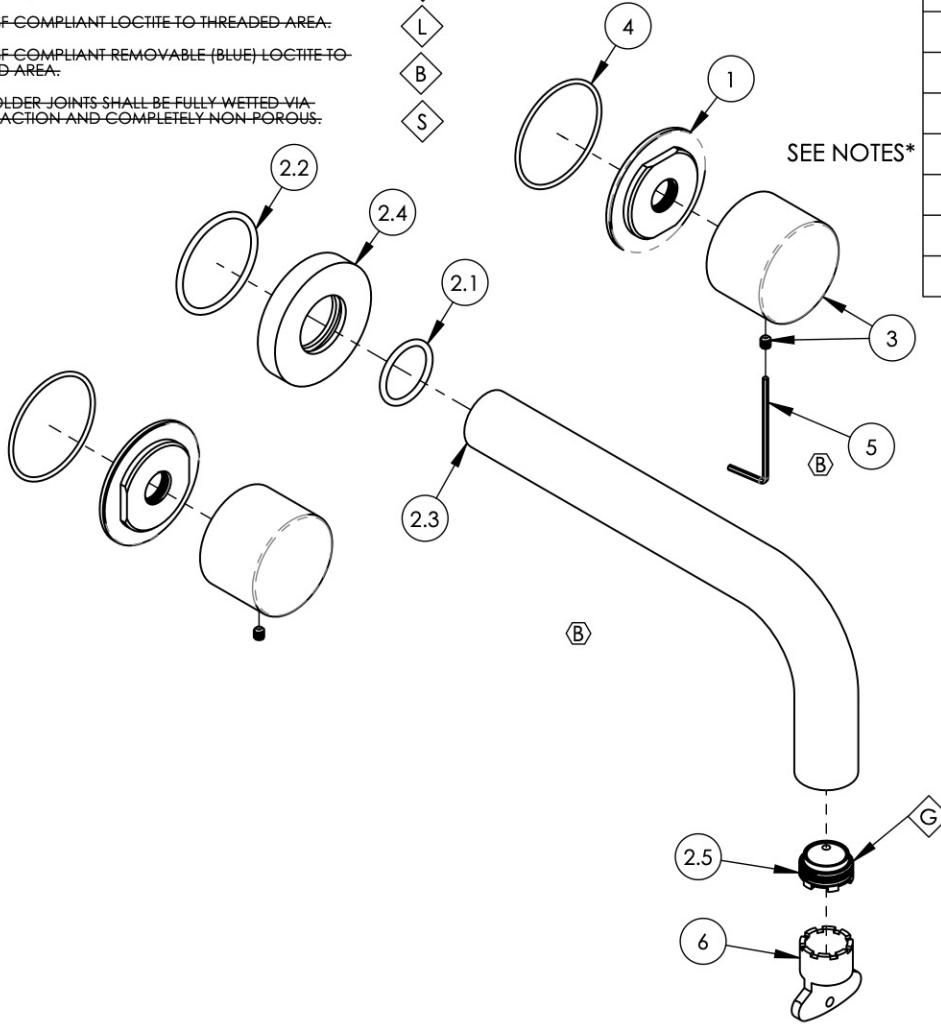

ITEM NO.	PART NUMBER	DESCRIPTION	QTY.
1	11164/00	ESCUTCHEON BASE, CONTEMP. BASIC II	2
2	3-414/00	WALL LAV, SPOUT ONLY, 7-1/2" L, BASIC	1
2.1	90119	O-RING, 15/16"ID X 1-1/8"OD X 3/32"THK, AS-568-119	1
2.2	90129	O-RING, 1-9/16"ID X 3/32"THK, AS-568-129	1
2.3	P19018/00	7-1/2" WALL LAV SPOUT, BASIC SERIES	1
2.4	P19017/00	ESCUTCHEON, FOR SPOUT	1
2.5	11429	AERATOR CACHE JR, 1.2GPM, M21.5X1.0, 42.2260.450	1
3	3-570	HANDLE, ROUND MARBLE, BLACK (030) ASSY	2
4	90031	O-RING, 1-3/4"ID X 1/16"THK, AS-568-031	2
5	92021	HEX KEY 5/64, FOR 8-32 SET SCREW	1
6	P05025	AERATOR, BASIC KEY, PLASTIC RED	1

ALL	B	UPDATE SPOUT ASSEMBLY, ADD HEX KEY	2/23/2022	AMM
ZONE	REV.	DESCRIPTION	DATE	APPROVED
REVISIONS				

1261 LOGAN AVENUE  
 COSTA MESA, CALIFORNIA 92626  
 PHONE: 714.361.4800  
 FAX: 714.617.3120

**PHYL RICH**<sup>®</sup>  
 Defining Luxury Since 1959

**PROPRIETARY AND CONFIDENTIAL**  
 THE INFORMATION CONTAINED IN THIS DRAWING IS THE SOLE PROPERTY OF PHYL RICH. ANY REPRODUCTION IN PART OR AS A WHOLE WITHOUT THE WRITTEN PERMISSION OF PHYL RICH IS PROHIBITED.  
**DO NOT SCALE DRAWING**

WALL LAV SET, SPOUT 7-1/2" W/ MARBLE, BASIC II

SIZE <b>A</b>	ASM/PRT NO. 230-13/00	REV B
SCALE: 1:3	WEIGHT: lbs.	SHEET 1 OF 2