

NOTE(S):  
1. PART NUMBER, "/00" DENOTES PART SHALL HAVE FINISH.

2. APPLY NSF COMPLIANT GREASE TO ANY O-RING, SEALING JOINTS, AND/OR PIVOTAL POINTS.

3. APPLY NSF COMPLIANT LOCTITE TO THREADED AREA.

4. APPLY NSF COMPLIANT REMOVABLE (BLUE) LOCTITE TO THREADED AREA.

5. SILVER SOLDER JOINTS SHALL BE FULLY WETTED VIA CAPILLARY ACTION AND COMPLETELY NON-POROUS.



ITEM NO.	PART NUMBER	DESCRIPTION	QTY.
1	12437/00	TUBE BAR, SHOWER DOOR PULL, SQUARE, 12" C-C, JOLIE	2
2	12434/00	POST, SHOWER DOOR PULL, SQUARE, THREADED, JOLIE	2
3	30395	CLEAR TUBE, UV-RESISTANT PVC	2
4	92560/00	PIN THRU GLASS, SHOWER ENCLOSURE PULL, 2-1/2" L	2
5	12431/00	BASE BOTTOM, SHOWER DOOR PULL, SQUARE, JOLIE	4
6	30394	WASHER, CLEAR PLASTIC, OD 1.750 X .384 ID X .065 THK	4
7	12451/00	BASE INSERT, SHOWER DOOR PULL, SQUARE, JOLIE	4
8	12452/00	BASE TOP, SHOWER DOOR PULL, SQUARE, JOLIE	4
9	92434	SCREW, SS PHILLIPS FLAT HEAD W/ UNDERCUT 6-32 X 7/16" L	16
10	12453/00	POST, SHOWER DOOR PULL, SQUARE, UNTHREADED, JOLIE	2
11	92248	SET SCREW, CUP POINT 8-32 UNC, 1/8" L.	2

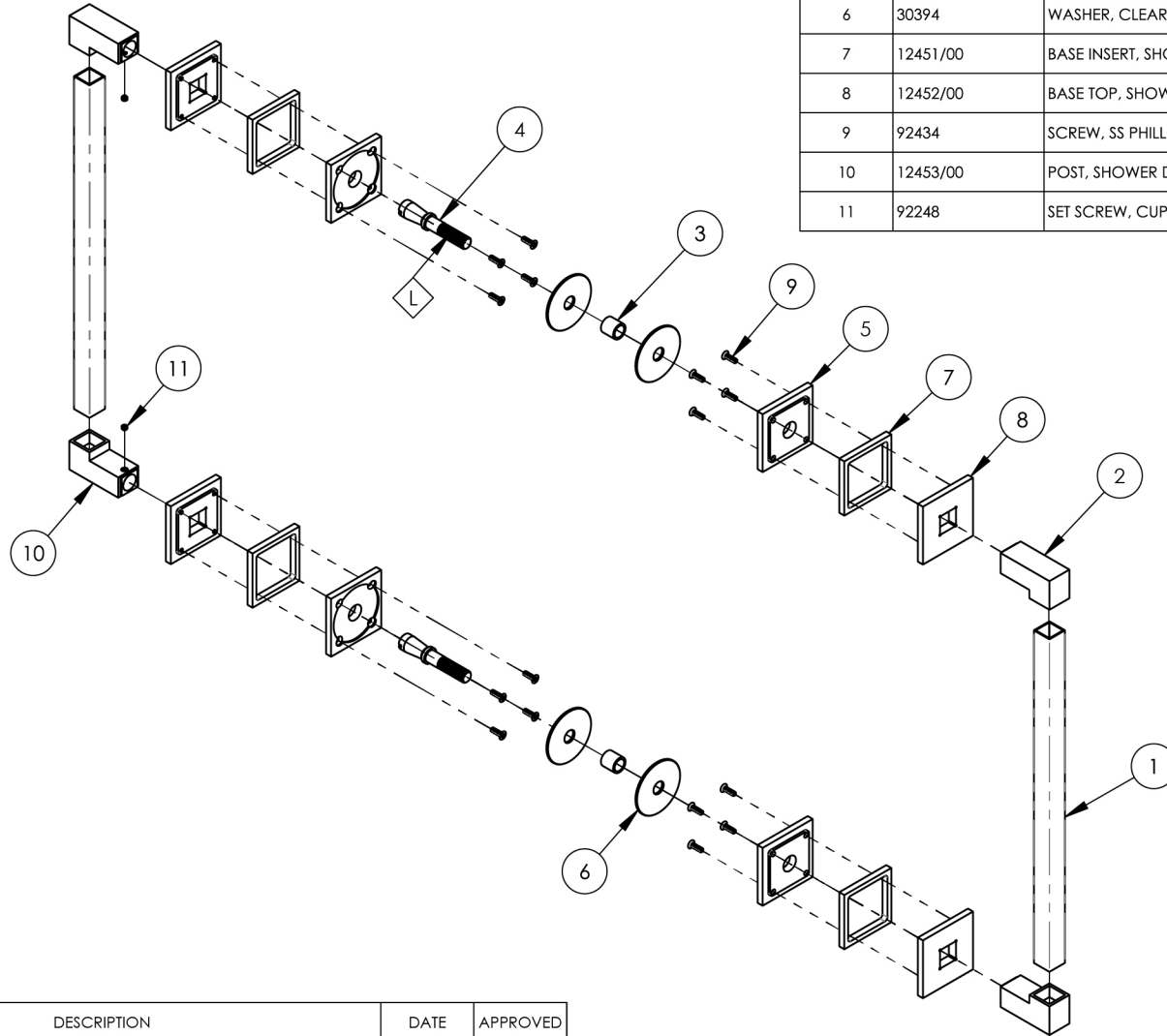

ZONE	REV.	DESCRIPTION	DATE	APPROVED
REVISIONS				

1261 LOGAN AVENUE  
COSTA MESA, CALIFORNIA 92626  
PHONE: 714.361.4800  
FAX: 714.617.3120

**PHYLIRICH**<sup>®</sup>  
Defining Luxury Since 1959

PROPRIETARY AND CONFIDENTIAL  
THE INFORMATION CONTAINED IN THIS DRAWING  
IS THE SOLE PROPERTY OF PHYLIRICH. ANY  
REPRODUCTION IN PART OR AS A WHOLE  
WITHOUT THE WRITTEN PERMISSION OF PHYLIRICH  
IS PROHIBITED.  
DO NOT SCALE DRAWING

SHOWER DOOR PULL, SQUARE, 12" C-C,  
DOUBLE, JOLIE

SIZE <b>A</b>	ASM/PRT NO. 222S-93-12/00	REV -
SCALE: 1:5.25	WEIGHT: lbs.	SHEET 1 OF 2