

- NOTE(S):
1. PART NUMBER, "/00" DENOTES PART SHALL HAVE FINISH.
2. APPLY NSF COMPLIANT GREASE TO ANY O-RING, SEALING JOINTS, AND/OR PIVOTAL POINTS.
3. APPLY NSF COMPLIANT LOCTITE TO THREADED AREA.
4. APPLY NSF COMPLIANT REMOVABLE (BLUE) LOCTITE TO THREADED AREA.
5. SILVER SOLDER JOINTS SHALL BE FULLY WETTED VIA CAPILLARY ACTION AND COMPLETELY NON-POROUS.

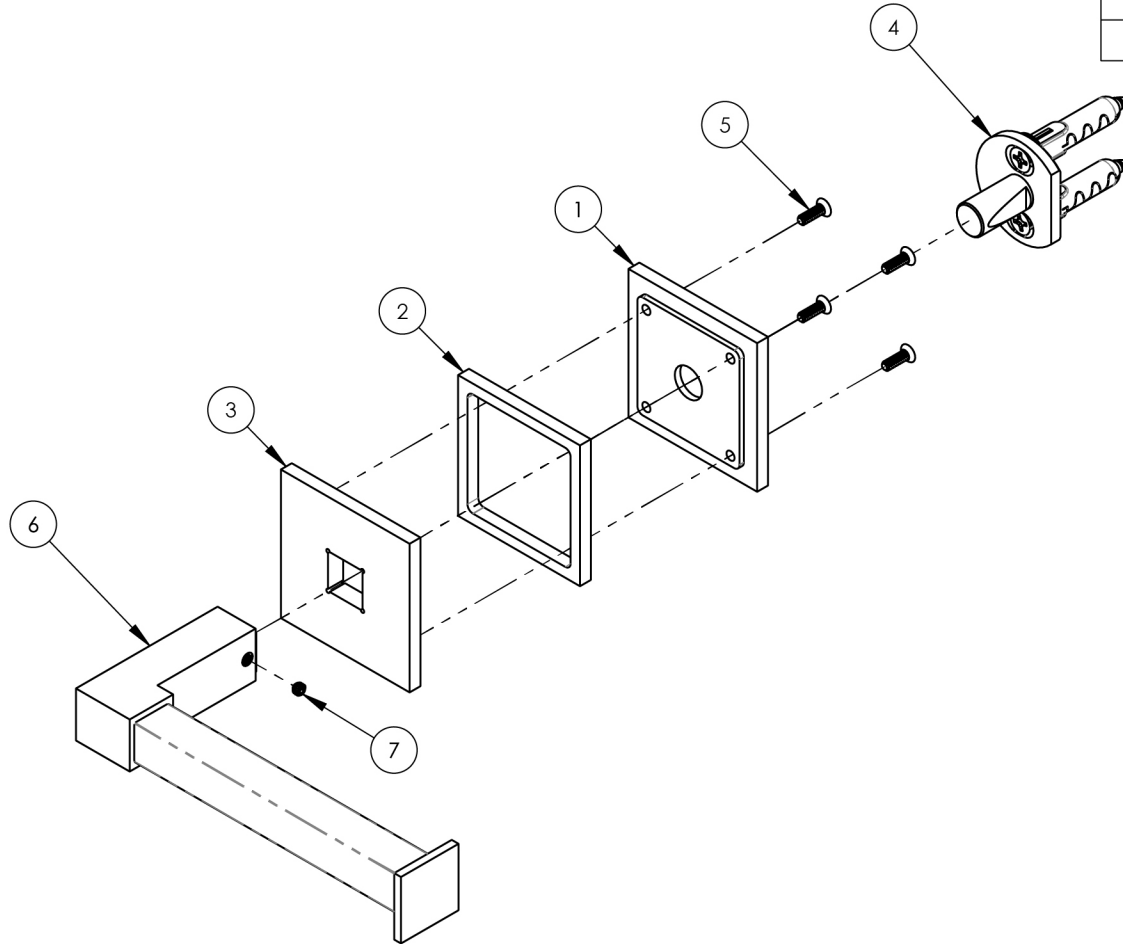

| ITEM NO. | PART NUMBER | DESCRIPTION | QTY. |
|----------|-------------|---|------|
| 1 | 12422/00 | BASE BOTTOM, SQUARE, JOLIE | 1 |
| 2 | 12423/00 | BASE INSERT, SQUARE, JOLIE | 1 |
| 3 | 12424/00 | BASE TOP, SQUARE, JOLIE | 1 |
| 4 | 2-264 | WALL MOUNTING KIT | 1 |
| 5 | 92434 | SCREW, SS PHILLIPS FLAT HEAD W/ UNDERCUT 6-32 X 7/16" L | 4 |
| 6 | 2-480/00 | TP HOLDER, SINGLE POST ARM, SQUARE, BRAZE, JOLIE | 1 |
| 7 | 92248 | SET SCREW, CUP POINT 8-32 UNC, 1/8" L. | 1 |



| ZONE | REV. | DESCRIPTION | DATE | APPROVED |
|------|------|-------------|------|----------|
|------|------|-------------|------|----------|

REVISIONS

1261 LOGAN AVENUE
COSTA MESA, CALIFORNIA 92626
PHONE: 714.361.4800
FAX: 714.617.3120

PHYL RICH[®]
Defining Luxury Since 1959

PROPRIETARY AND CONFIDENTIAL
THE INFORMATION CONTAINED IN THIS DRAWING
IS THE SOLE PROPERTY OF PHYL RICH. ANY
REPRODUCTION IN PART OR AS A WHOLE
WITHOUT THE WRITTEN PERMISSION OF PHYL RICH
IS PROHIBITED.
DO NOT SCALE DRAWING

TP HOLDER, SINGLE POST, SQUARE, JOLIE

| SIZE | ASM/PRT NO. | REV |
|--------------|--------------|--------------|
| A | 222S-74/00 | - |
| SCALE: 1:2.5 | WEIGHT: lbs. | SHEET 1 OF 2 |