

NOTE(S):
1. PART NUMBER, "/00" DENOTES PART SHALL HAVE FINISH.

2. APPLY NSF COMPLIANT GREASE TO ANY O-RING, SEALING JOINTS, AND/OR PIVOTAL POINTS.

3. APPLY NSF COMPLIANT LOCTITE TO THREADED AREA.

4. APPLY NSF COMPLIANT REMOVABLE (BLUE) LOCTITE TO THREADED AREA.

5. SILVER SOLDER JOINTS SHALL BE FULLY WETTED VIA CAPILLARY ACTION AND COMPLETELY NON-POROUS.

G

L

B

S

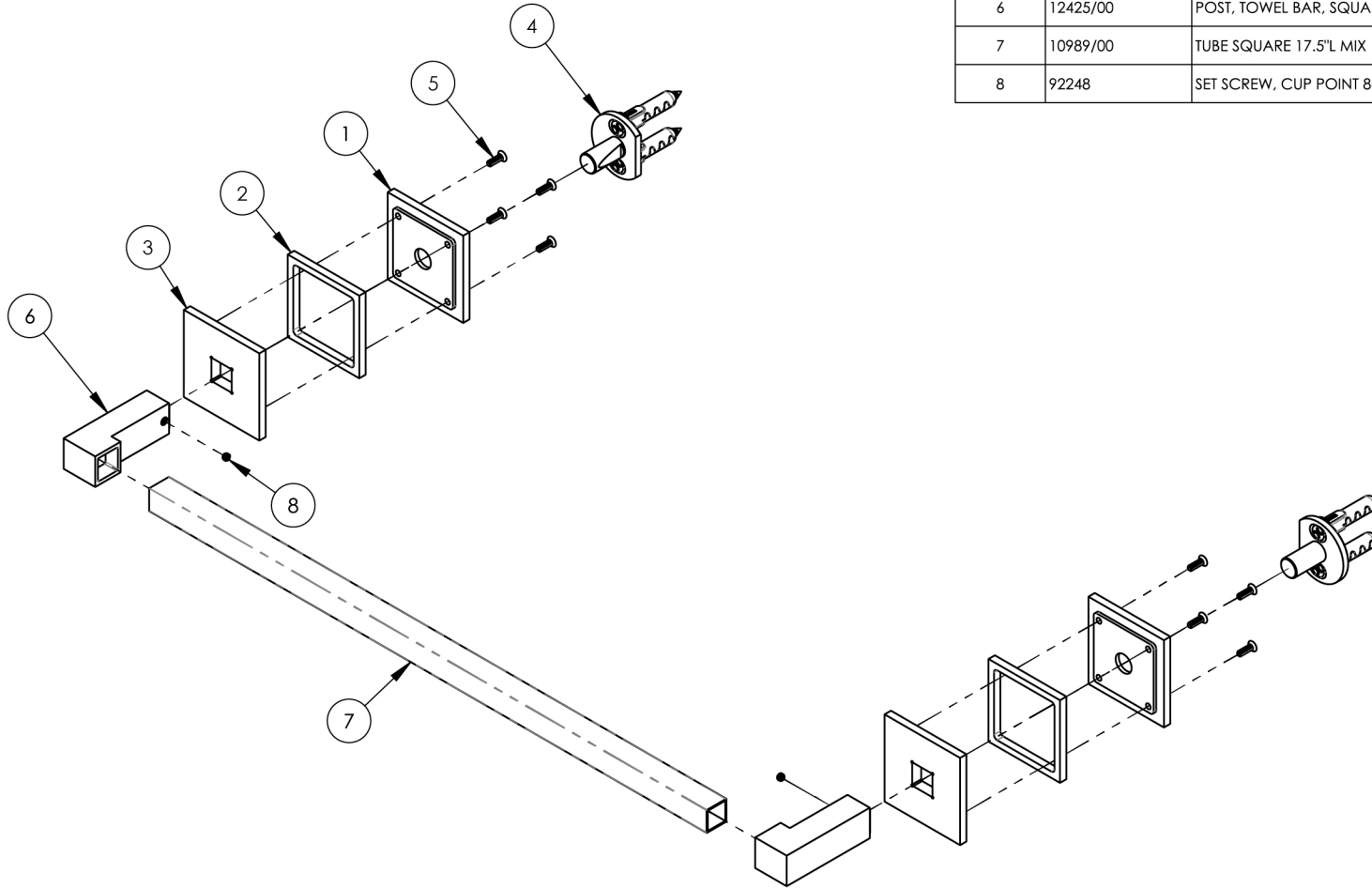

ITEM NO.	PART NUMBER	DESCRIPTION	QTY.
1	12422/00	BASE BOTTOM, SQUARE, JOLIE	2
2	12423/00	BASE INSERT, SQUARE, JOLIE	2
3	12424/00	BASE TOP, SQUARE, JOLIE	2
4	2-264	WALL MOUNTING KIT	2
5	92434	SCREW, SS PHILLIPS FLAT HEAD W/ UNDERCUT 6-32 X 7/16" L	8
6	12425/00	POST, TOWEL BAR, SQUARE, JOLIE	2
7	10989/00	TUBE SQUARE 17.5" L MIX	1
8	92248	SET SCREW, CUP POINT 8-32 UNC, 1/8" L.	2

ZONE	REV.	DESCRIPTION	DATE	APPROVED
REVISIONS				

1261 LOGAN AVENUE
COSTA MESA, CALIFORNIA 92626
PHONE: 714.361.4800
FAX: 714.617.3120

PHYL RICH[®]
Defining Luxury Since 1959

PROPRIETARY AND CONFIDENTIAL
THE INFORMATION CONTAINED IN THIS DRAWING
IS THE SOLE PROPERTY OF PHYL RICH. ANY
REPRODUCTION IN PART OR AS A WHOLE
WITHOUT THE WRITTEN PERMISSION OF PHYL RICH
IS PROHIBITED.
DO NOT SCALE DRAWING

18" TOWEL BAR, SQUARE, JOLIE

SIZE	ASM/PRT NO.	REV
A	222S-70/00	-
SCALE: 1:4	WEIGHT: lbs.	SHEET 1 OF 2