

- NOTE(S):
- PART NUMBER, "/00" DENOTES PART SHALL HAVE FINISH.
  - APPLY NSF COMPLIANT GREASE TO ANY O-RING, SEALING JOINTS, AND/OR PIVOTAL POINTS.
  - APPLY NSF COMPLIANT LOCTITE TO THREADED AREA.
  - APPLY NSF COMPLIANT REMOVABLE (BLUE) LOCTITE TO THREADED AREA.
  - SILVER SOLDER JOINTS SHALL BE FULLY WETTED VIA CAPILLARY ACTION AND COMPLETELY NON-POROUS.

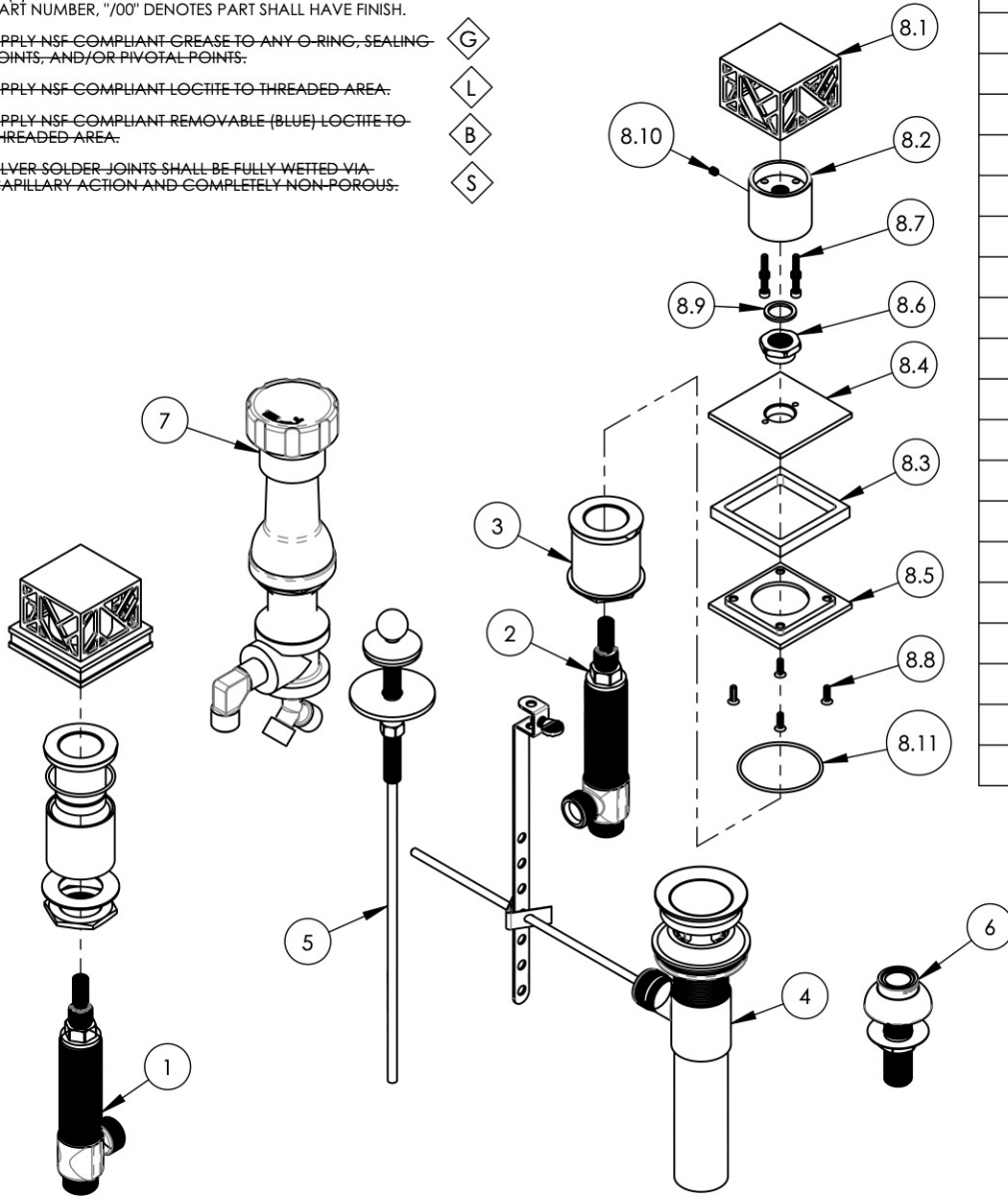

ITEM NO.	PART NUMBER	DESCRIPTION	QTY.
1	1-149	WIDESPREAD VALVE LAV 16PT, HOT, ONLY	1
2	1-150	WIDESPREAD VALVE LAV 16PT, COLD, ONLY	1
3	2-092	RECESSED MOUNTING KIT FOR WIDESPREAD	2
4	3-046/00	POP-UP DRAIN ASSEMBLY (2-101, 2-102, & 2-246)	1
5	3-084/00	ASSY, POP-UP BIDET	1
6	3-085/00	ASSY, BIDET SPRAYER	1
7	3-160/00	BIDET DIVERTER, COMPLETE	1
8	3-603/00	ASSY, SQUARE HANDLE & BASE, CAGE DESIGN, JOLIE	2
8.1	11802/00	CAGE, HANDLE, SQUARE,	1
8.2	11803/00	HUB, HANDLE, CAGE DESIGN	1
8.3	11804/00	SQAURE INSERT, HANDLE, BASE	1
8.4	11805/00	SQUARE BASE, TOP, JOLIE	1
8.5	11806/00	SQUARE BASE, BOTTOM, JOLIE	1
8.6	92398	MOUNTING NUT, 9/16"-20	1
8.7	92471	SCREW, SS, SOCKET HEAD, 6-32 X 1/2" L	4
8.8	92434	SCREW, SS PHILLIPS FLAT HEAD W/ UNDERCUT 6-32 X 7/16" L	4
8.9	92404	WEAR WASHER, HANDLE	1
8.10	92008	SET SCREW, CUP POINT 8-32, 3/16" L.	1
8.11	90032	O-RING, 1-7/8"ID X 2"OD X 1/16"THK, AS-568-032	1

ZONE	REV.	DESCRIPTION	DATE	APPROVED
REVISIONS				

1261 LOGAN AVENUE  
COSTA MESA, CALIFORNIA 92626  
PHONE: 714.361.4800  
FAX: 714.617.3120

**PHYL RICH**<sup>®</sup>  
Defining Luxury Since 1959

**PROPRIETARY AND CONFIDENTIAL**  
THE INFORMATION CONTAINED IN THIS DRAWING IS THE SOLE PROPERTY OF PHYL RICH. ANY REPRODUCTION IN PART OR AS A WHOLE WITHOUT THE WRITTEN PERMISSION OF PHYL RICH IS PROHIBITED.  
**DO NOT SCALE DRAWING**

FOUR HOLE BIDET, SQUARE HANDLES,  
JOLIE

SIZE <b>A</b>	ASM/PRT NO. 222-61/00	REV -
SCALE: 1:4.5	WEIGHT: lbs.	SHEET 1 OF 2