

NOTE(S):
 1. PART NUMBER, "/00" DENOTES PART SHALL HAVE FINISH.
 2. APPLY NSF COMPLIANT GREASE TO ANY O-RING, SEALING JOINTS, AND/OR PIVOTAL POINTS.
 3. APPLY NSF COMPLIANT LOCTITE TO THREADED AREA.

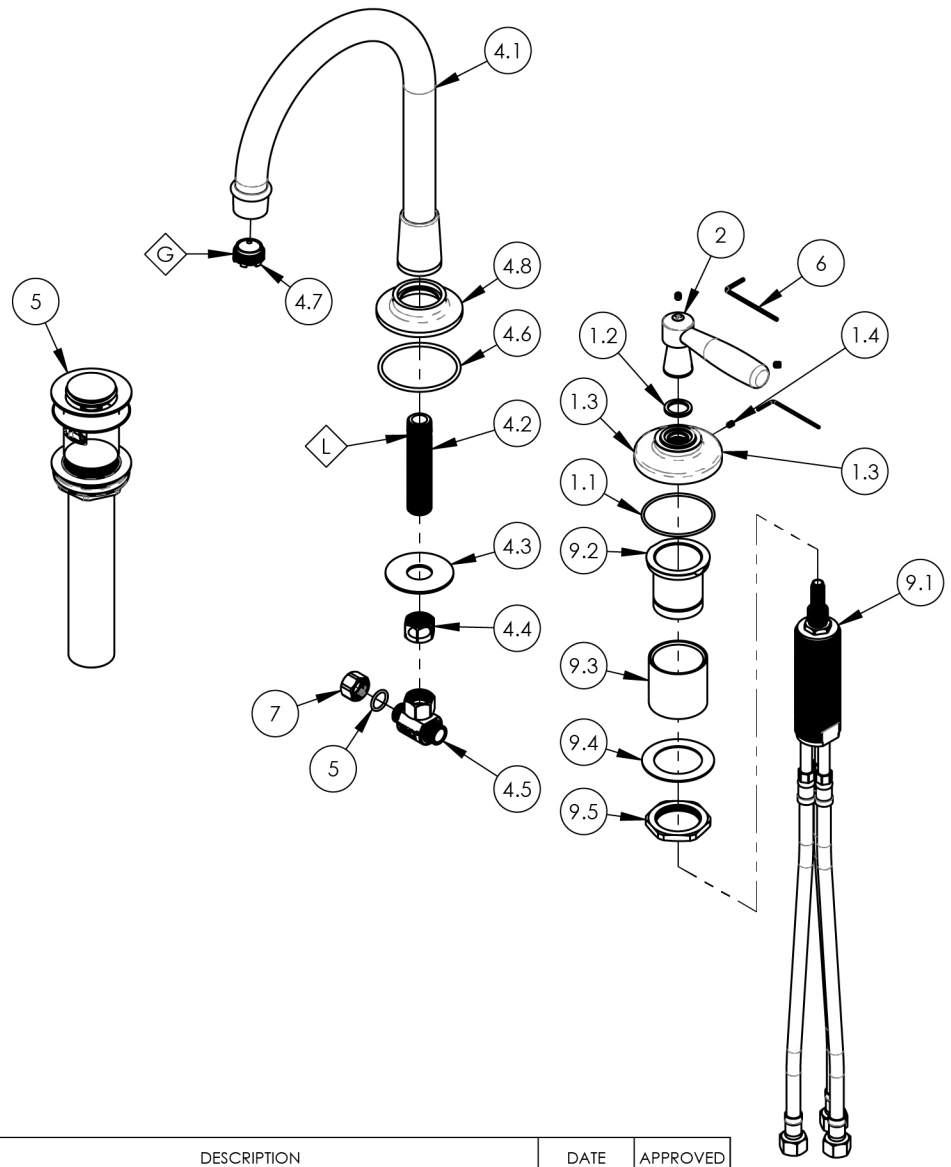

| ITEM NO. | PART NUMBER | DESCRIPTION | QTY. |
|----------|-------------|--|------|
| 1 | 3-984/00 | ESCUTCHEON BASE, SINGLE HANDLE LAV | 1 |
| 1.1 | 90032 | O-RING, 1-7/8"ID X 2"OD X 1/16"THK, AS-568-032 | 1 |
| 1.2 | 92404 | WEAR WASHER, HANDLE | 1 |
| 1.3 | 12685/00 | ESCUTCHEON, SINGLE HANDLE LAV | 1 |
| 1.4 | 92005 | SET SCREW, CUP PT 6-32 UNC THREAD 3/16"L | 1 |
| 2 | 3-303/00 | HANDLE LEVER W/ HARDWARE, WORKS | 1 |
| 5 | 3-545/00 | BRASS PUSH TYPE DRAIN, W/ OVERFLOW & SMALL PLUG | 1 |
| 4 | 3-616/00 | SPOUT ARC, WIDESPREAD, W/ HARDWARE, TRADITIONAL, WORKS | 1 |
| 4.1 | 2-331/00 | SPOUT ARC, BASE & AERATOR HOUSING, BRAZE, WORKS | 1 |
| 4.2 | 10745 | THREAD ALL, 3/8"-18 NPSM | 1 |
| 4.3 | 92174 | WASHER, 1.860 O.D X .690 I.D | 1 |
| 4.4 | 10746 | NUT, 3/8"-18 NPSL | 1 |
| 4.5 | 1-112 | TEE VALVE, 3/8" NPSM X 3/8" COMPRESSION | 1 |
| 4.6 | 90137 | O-RING, 2-1/16"ID X 3/32"THK., AS-568-137 | 1 |
| 4.7 | 11429 | AERATOR CACHE JR, 1.2GPM, M21.5X1.0, 42.2260.450 | 1 |
| 4.8 | 12273/00 | ESCUTCHEON BASE, ARC SPOUT, WORKS | 1 |
| 5 | 90014 | O-RING, 1/2"ID X 5/8"OD X 1/16"THK, AS-568-014 | 1 |
| 6 | 92021 | HEX KEY 5/64, FOR 8-32 SET SCREW | 1 |
| 7 | 92492 | CAP NUT, 3/8" COMPRESSION | 1 |
| 8 | 92246 | HEX KEY 1/16, FOR 6-32 SET SCREW | 1 |
| 9 | 2-580 | VALVE KIT, FLUSH MOUNT, SINGLE HANDLE LAV | 1 |
| 9.1 | 1-054 | VALVE, DECK MOUNTED SINGLE HANDLE LAV DROP-IN | 1 |
| 9.2 | 11077 | SLEEVE MOUNT, DECK (ROMAN) TUB | 1 |
| 9.3 | 92180 | EXTENSION SLEEVE, WIDESPREAD | 1 |
| 9.4 | 92138 | BRASS WASHER, THIN | 1 |
| 9.5 | 92313 | HEX NUT, 1-1/4"-20 THREAD | 1 |

| ZONE | REV. | DESCRIPTION | DATE | APPROVED |
|-----------|------|-------------|------|----------|
| REVISIONS | | | | |

1261 LOGAN AVENUE
 COSTA MESA, CALIFORNIA 92626
 PHONE: 714.361.4800
 FAX: 714.617.3120

PHYLIRICH®

Defining Luxury Since 1959

PROPRIETARY AND CONFIDENTIAL
 THE INFORMATION CONTAINED IN THIS DRAWING IS THE SOLE PROPERTY OF PHYLIRICH. ANY REPRODUCTION IN PART OR AS A WHOLE WITHOUT THE WRITTEN PERMISSION OF PHYLIRICH IS PROHIBITED.
 DO NOT SCALE DRAWING

WIDESPREAD LAV, HIGH ARC SPOUT, SINGLE LEVER HANDLE, WORKS

| | | |
|------------------|--------------------------|--------------|
| SIZE A | ASM/PRT NO. 220-08/00 | REV - |
| SCALE: 1:5.25 | WEIGHT: lbs. | SHEET 1 OF 2 |