

5

4

3

2

1

ITEM NO.	PART NUMBER	DESCRIPTION	QTY.
1	10530/00	POST, TOWEL BARS, COINED SERIES	2
2	10917/00	BAR TUBE, SLIDEBAR FOR HANDSHOWER	1
3	10972/00	HUB, TRANSITIONAL 3RING	2
4	10978/00	ESCUTCHEON HANDLE BASE COINED, 3RING, COINED SERIES	2
5	2-104	MOUNTING KIT WITH EXTENSION	2
6	92248	SET SCREW, CUP POINT 8-32 UNC, 1/8" L.	2
7	P39001	HEX KEY 5/64, FOR 8-32 SET SCREW	1

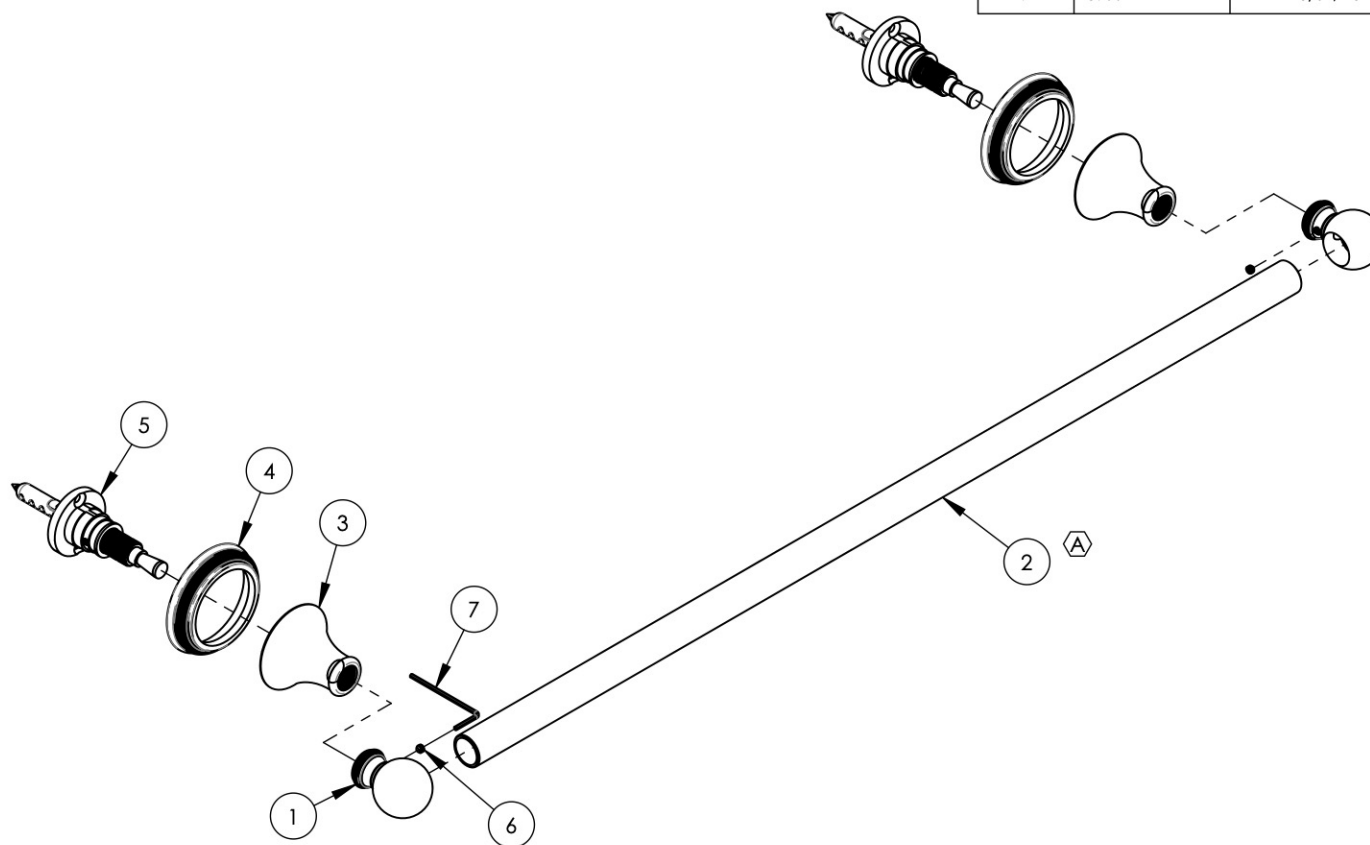

ZONE	REV.	DESCRIPTION	DATE	APPROVED
C2	A	UPDATE TEMPLATE & MAIN TUBE	4/10/2020	AMM
REVISIONS				

1261 LOGAN AVENUE  
COSTA MESA, CALIFORNIA 92626  
PHONE: 714.361.4800  
FAX: 714.617.3120

**PHYLIRICH®**  
Defining Luxury Since 1959

**PROPRIETARY AND CONFIDENTIAL**

THE INFORMATION CONTAINED IN THIS DRAWING IS THE SOLE PROPERTY OF PHYLIRICH. ANY REPRODUCTION IN PART OR AS A WHOLE WITHOUT THE WRITTEN PERMISSION OF PHYLIRICH IS PROHIBITED.

-	-	INTERPRET GEOMETRIC DIMENSIONING & TOLERANCING IN ACCORDANCE WITH ASME Y14.5-2009 & ASME Y14.41-2003 STANDARDS. UNLESS OTHERWISE SPECIFIED, DIMENSIONS ARE IN INCHES. TOLERANCES ARE:		
NEXT ASSY	USED ON	FRACTIONS ±1/16"	DECIMALS X.X: ±.1 X.XX: ±.01 X.XXX: ±.005	ANGULAR ±2°
APPLICATION		MATERIAL	NAME	DATE
FINISH		DRAWN	LLO	3/25/2014
<b>DO NOT SCALE DRAWING</b>		CHECKED	GRE	

**TOWEL BAR 24", COINED SERIES**

SIZE <b>A</b>	ASM/PRT NO. 208-71/00	REV A
SCALE: 1:4	WEIGHT: lbs.	SHEET 1 OF 2

5

4

3

2

1