

ITEM NO.	PART NUMBER	DESCRIPTION	QTY.
1	11372	NIPPLE, QUICK CONNECT SUPPLY	2
2	11373	QUICK CONNECT, VALVE BASE	1
3	11415	NUT, QUICK CONNECT SUPPLY	2

A

B

C

D

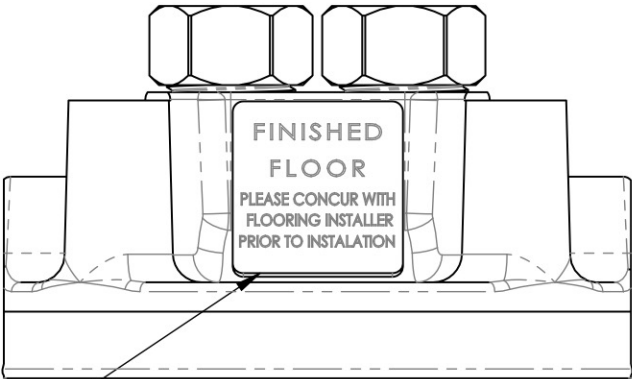
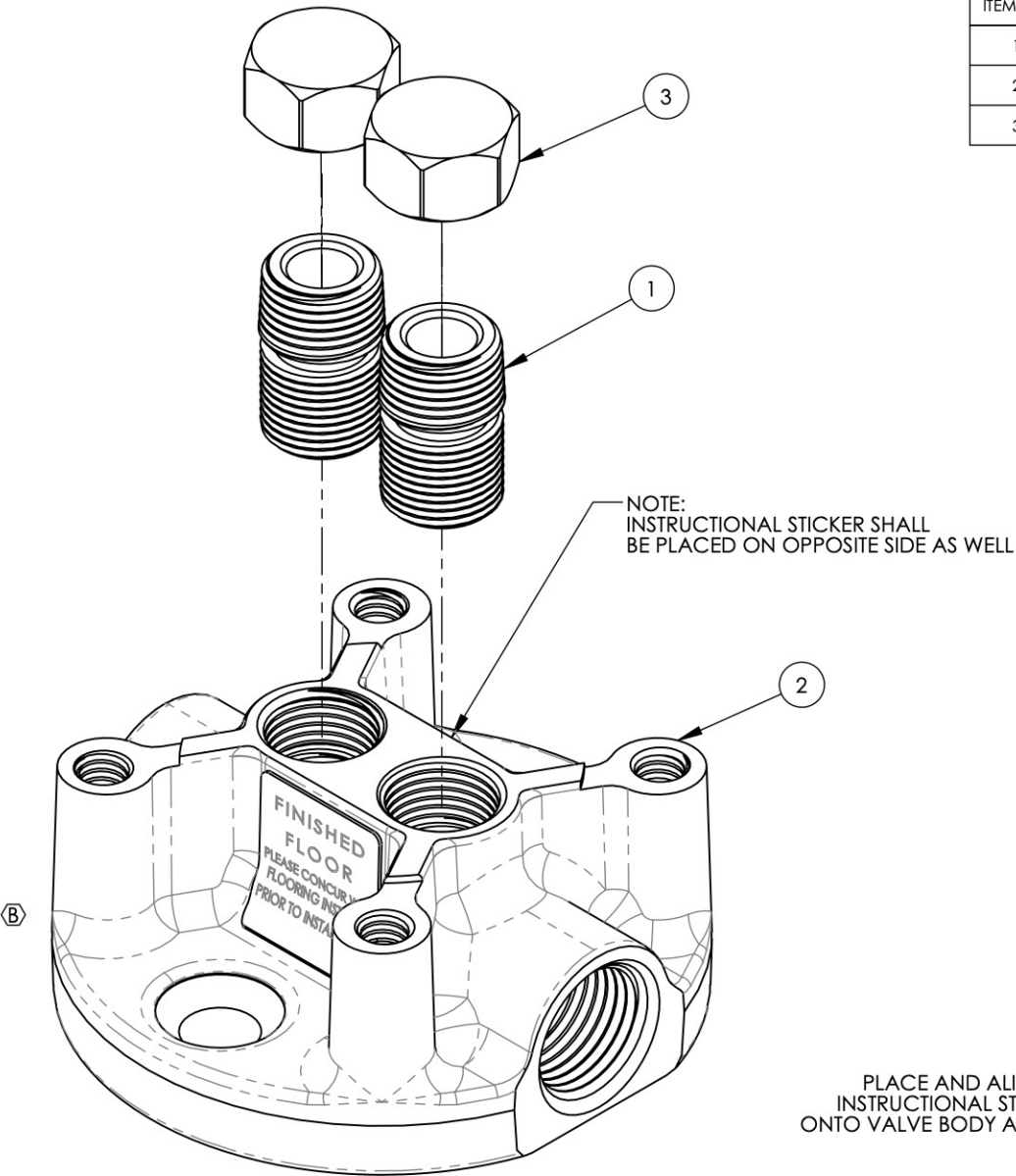

PLACE AND ALIGN  
INSTRUCTIONAL STICKER  
ONTO VALVE BODY AS SHOWN

E

D4	B	APPLIED NEW FORGING MODEL	2/15/2021	RAH
ZONE	REV.	DESCRIPTION	DATE	APPROVED

REVISIONS	
<p>1261 LOGAN AVENUE COSTA MESA, CALIFORNIA 92626</p> <p>PHONE: 714.361.4800 FAX: 714.617.3120</p>	<p><b>RSS</b>  <b>MANUFACTURING</b></p> <p><b>PROPRIETARY AND CONFIDENTIAL</b></p> <p>THE INFORMATION CONTAINED IN THIS DRAWING IS THE SOLE PROPERTY OF RSS MANUFACTURING. ANY REPRODUCTION IN PART OR AS A WHOLE WITHOUT THE WRITTEN PERMISSION OF RSS MANUFACTURING IS PROHIBITED.</p>

-	92261	INTERPRET GEOMETRIC DIMENSIONING & TOLERANCING IN ACCORDANCE WITH ASME Y14.5-2009 & ASME Y14.41-2003 STANDARDS. UNLESS OTHERWISE SPECIFIED, DIMENSIONS ARE IN INCHES. TOLERANCES ARE:  <b>FRACTIONS</b> ±1/64" <b>DECIMALS</b> X.X: ±.1 X.XX: ±.01 X.XXX: ±.005 <b>ANGULAR</b> ±.5°		
-	11370			
230-45	11366			
NEXT ASSY	USED ON			
APPLICATION				
MATERIAL				
FINISH			NAME	DATE
DO NOT SCALE DRAWING		DRAWN	RAH	3/23/2016
		CHECKED		

ROUGH IN, FLOOR MOUNT TUB

SIZE	ASM/PRT NO.	REV
<b>A</b>	2-145	<b>B</b>
SCALE: 1:1	WEIGHT: lbs.	SHEET 1 OF 1