

- NOTE(S):
 1. PART NUMBER, "/00" DENOTES PART SHALL HAVE FINISH.
 2. APPLY NSF COMPLIANT GREASE TO ANY O-RING, SEALING JOINTS, AND/OR PIVOTAL POINTS.
 3. APPLY NSF COMPLIANT LOCTITE TO THREADED AREA.
 4. APPLY NSF COMPLIANT REMOVABLE (BLUE) LOCTITE TO THREADED AREA.
 5. SILVER SOLDER JOINTS SHALL BE FULLY WETTED VIA CAPILLARY ACTION AND COMPLETELY NON-POROUS.

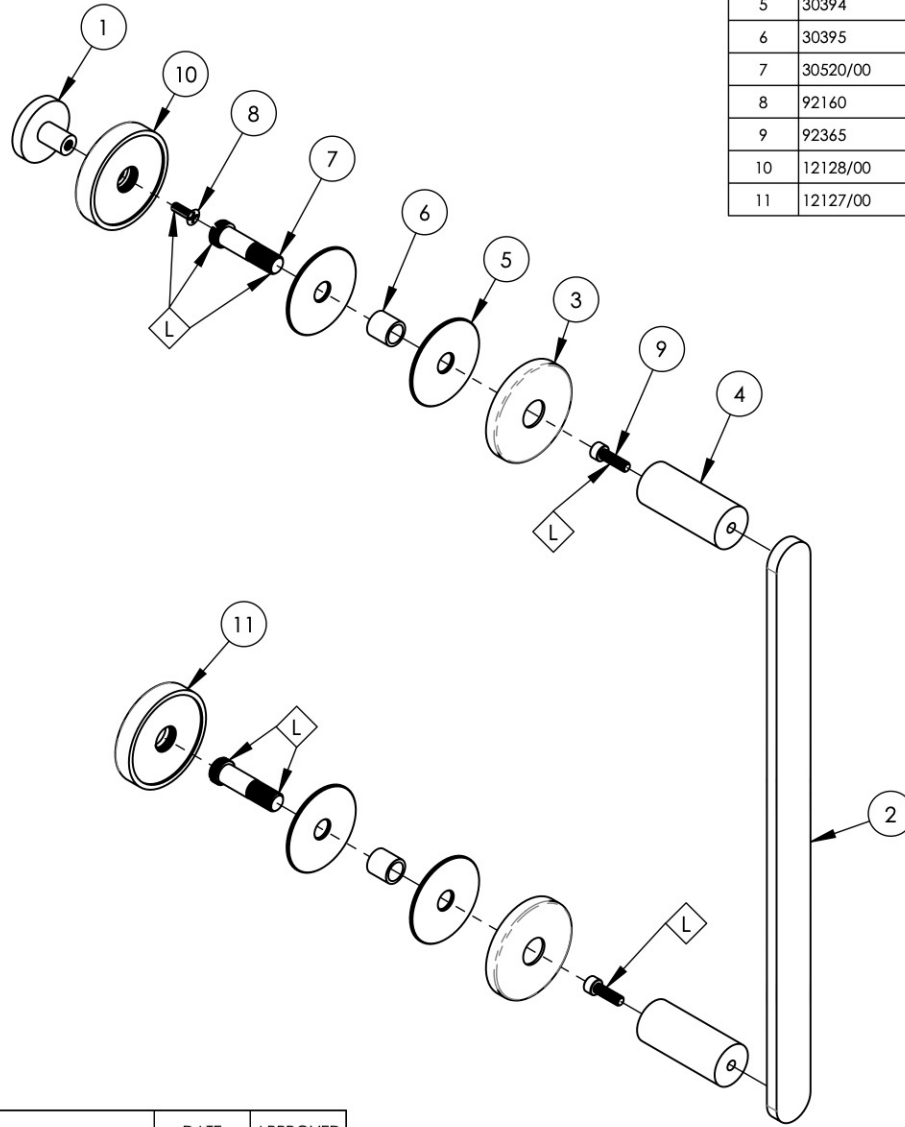

ITEM NO.	PART NUMBER	DESCRIPTION	QTY.
1	50105/00	KNOB, CABINET, ROND	1
2	12080/00	BAR FOR SHOWER PULL, 12" C2C, ROND	1
3	12085/00	ESCUTCHEON, ACCESSORIES, ROND	2
4	12088/00	POST EXTENSION, OUTSIDE, SHOWER PULL, ROND	2
5	30394	WASHER, CLEAR PLASTIC, OD 1.750 X .384 ID X .065 THK	4
6	30395	CLEAR TUBE, UV-RESISTANT PVC	2
7	30520/00	PIN THRU GLASS, ENDCAP SHOWER ENCLOSURE PULL, SALE GALLERY	2
8	92160	SCREW, FLAT HD. 8-32 X 1/2"L	1
9	92365	SCREW, SOCKET HD, 10-32 X 5/8"L	2
10	12128/00	COVER FOR KNOB, SHOWER GLASS DOOR, ROND	1
11	12127/00	COVER, SHOWER GLASS DOOR, ROND	1



ZONE	REV.	DESCRIPTION	DATE	APPROVED
REVISIONS				

1261 LOGAN AVENUE
 COSTA MESA, CALIFORNIA 92626
 PHONE: 714.361.4800
 FAX: 714.617.3120

PHYLIRICH[®]
 Defining Luxury Since 1959

PROPRIETARY AND CONFIDENTIAL
 THE INFORMATION CONTAINED IN THIS DRAWING IS THE SOLE PROPERTY OF PHYLIRICH. ANY REPRODUCTION IN PART OR AS A WHOLE WITHOUT THE WRITTEN PERMISSION OF PHYLIRICH IS PROHIBITED.
DO NOT SCALE DRAWING

SHOWER DOOR PULL, 12" C-C, SINGLE, ROND

SIZE A	ASM/PRT NO. 183-92-12/00	REV
SCALE: 1:3.5	WEIGHT: lbs.	SHEET 1 OF 2