

- NOTE(S):
1. PART NUMBER, "/00" DENOTES PART SHALL HAVE FINISH.
 2. APPLY NSF COMPLIANT GREASE TO ANY O-RING, SEALING JOINTS, AND/OR PIVOTAL POINTS.
 3. APPLY NSF COMPLIANT LOCTITE TO THREADED AREA.
 4. APPLY NSF COMPLIANT REMOVABLE (BLUE) LOCTITE TO THREADED AREA.
 5. SILVER SOLDER JOINTS SHALL BE FULLY WETTED VIA CAPILLARY ACTION AND COMPLETELY NON POROUS.

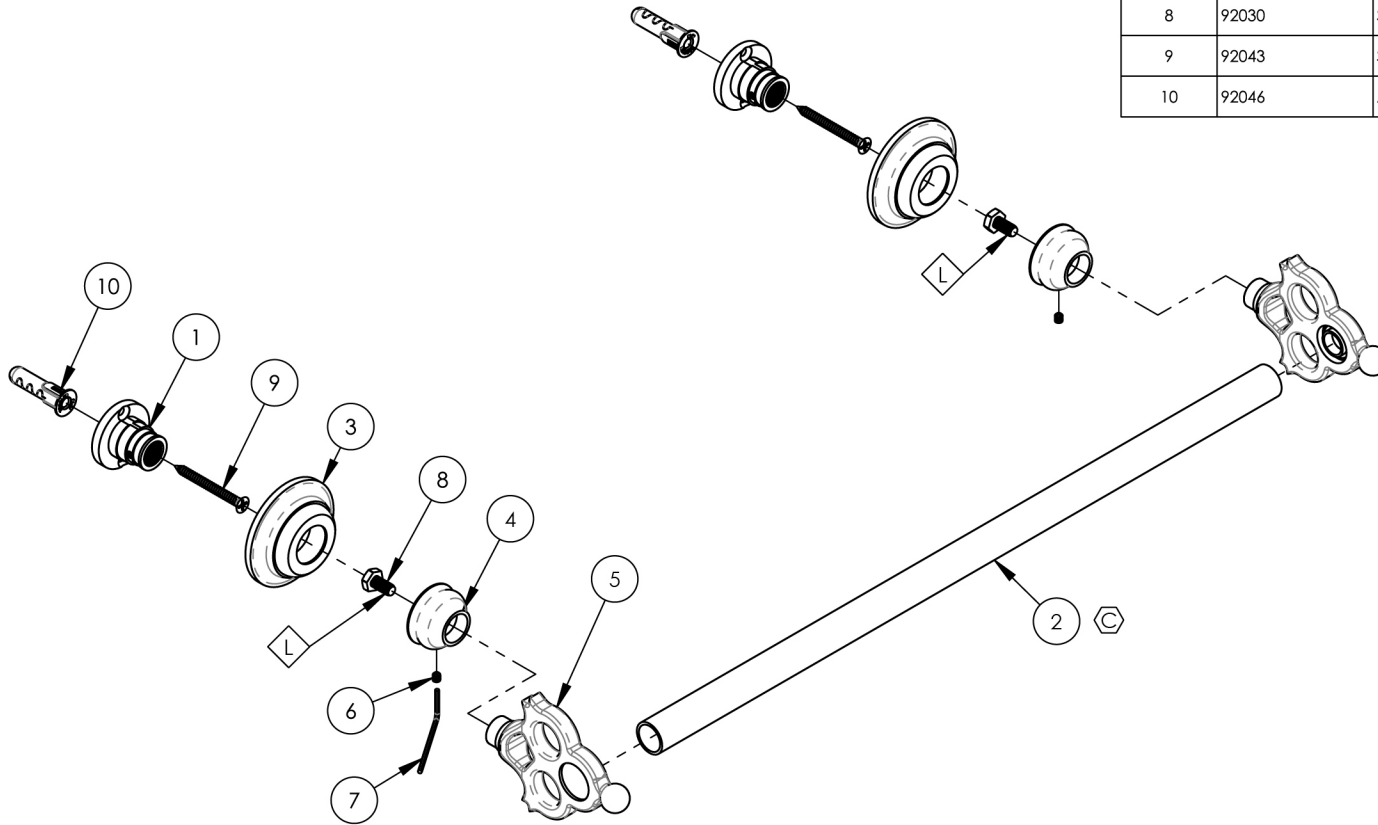

ITEM NO.	PART NUMBER	DESCRIPTION	QTY.
1	11050	MOUNTING KIT, WALL FLANGE	2
2	11063/00	BAR TUBE, FOR 18" TOWEL BAR	1
3	11277/00	ESCUTCHEON, ACCESSORIES, MAISON	2
4	11286/00	BASE, ACCESSORIES, MAISON SERIES	2
5	2-149/00	SUB ASSY., TOWEL BAR POST, MAISON	2
6	92008	SET SCREW, CUP POINT 8-32, 3/16" L.	2
7	92021	HEX KEY 5/64, FOR 8-32 SET SCREW	1
8	92030	SCREW, HEX HEAD 1/4"-20 THRD, 7/16"L	2
9	92043	SCREW, FLAT HD #10 SIZE W/ #2 PHIL DRIVE, 2"L	2
10	92046	ANCHOR SCREW 3/8" HOLE, TOGGLER AF10	2



B3	C	UPDATED COMPONENT	2/13/2025	VA
ZONE	REV.	DESCRIPTION	DATE	APPROVED
REVISIONS				

1261 LOGAN AVENUE
COSTA MESA, CALIFORNIA 92626
PHONE: 714.361.4800
FAX: 714.617.3120

PHYLIRICH®
Defining Luxury Since 1959

PROPRIETARY AND CONFIDENTIAL
THE INFORMATION CONTAINED IN THIS DRAWING
IS THE SOLE PROPERTY OF PHYLIRICH. ANY
REPRODUCTION IN PART OR AS A WHOLE
WITHOUT THE WRITTEN PERMISSION OF PHYLIRICH
IS PROHIBITED.
DO NOT SCALE DRAWING

18" TOWEL BAR, MAISON

SIZE A	ASM/PRT NO. 164-70/00	REV C
SCALE: 1:4	WEIGHT: lbs.	SHEET 1 OF 2