

- NOTE(S):
1. PART NUMBER, "/00" DENOTES PART SHALL HAVE FINISH.
  2. APPLY NSF COMPLIANT GREASE TO ANY O-RING, SEALING JOINTS, AND/OR PIVOTAL POINTS.
  3. APPLY NSF COMPLIANT LOCTITE TO THREADED AREA.
  4. APPLY NSF COMPLIANT REMOVABLE (BLUE) LOCTITE TO THREADED AREA.
  5. SILVER SOLDER JOINTS SHALL BE FULLY WETTED VIA CAPILLARY ACTION AND COMPLETELY NON-POROUS.

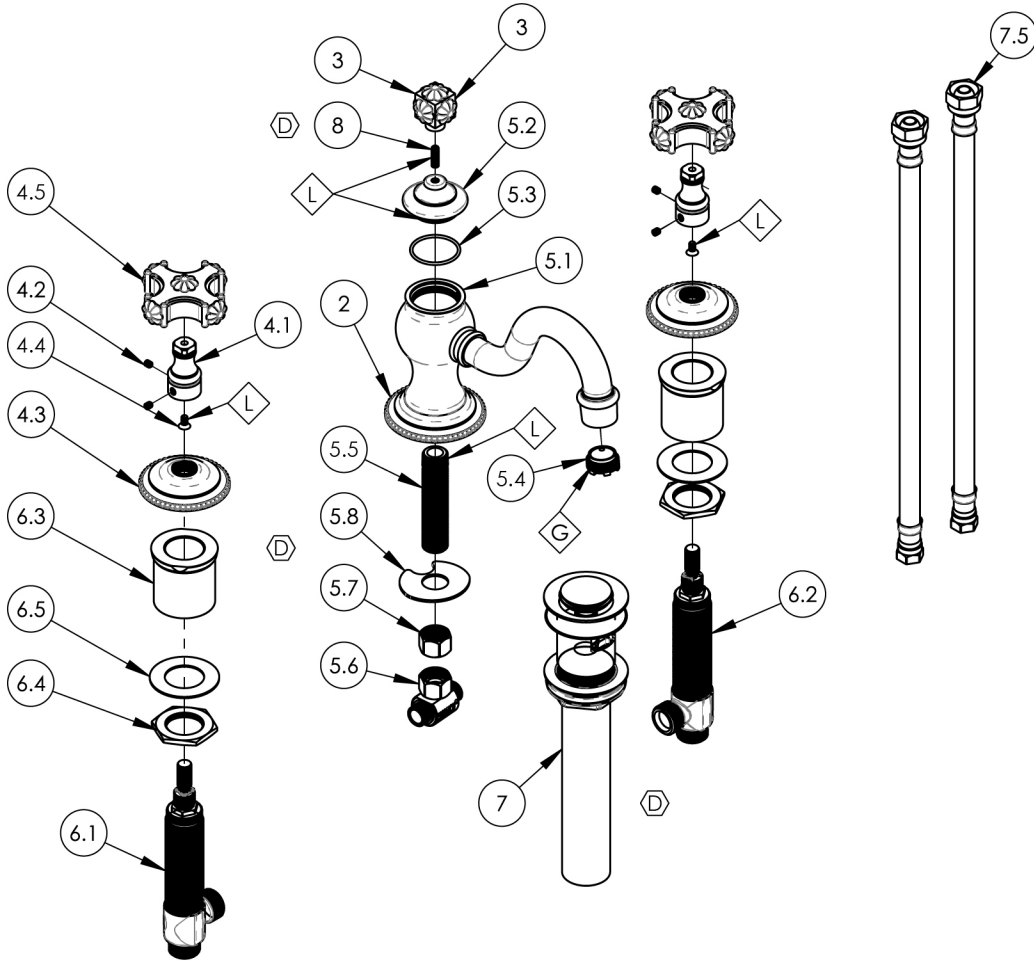

ITEM NO.	PART NUMBER	DESCRIPTION	QTY.
7.5	10982	HOSE, 3/8" COMP. X 1/2" NPSM - 12"L	2
2	11180/00	ESCUTCHEON SPOUT, COURONNE SERIES	1
3	2-115/00	SUB-ASSY. FINIAL POP-UP, MARVELLE SERIES	1
4	3-029/00	CROSS HANDLE, MARVELLE SERIES	2
4.1	10542/00	BASE HANDLE, CROSS MARVELLE	1
4.2	92008	SET SCREW, CUP POINT 8-32, 3/16" L.	2
4.3	10540/00	ESCUTCHEON, MARVELLE SERIES	1
4.4	92146	SCREW, FLAT HD. 8-32 X 5/16"L	1
4.5	2-114/00	SUB-ASSY. HANDLE CROSS, MARVELLE SERIES	1
5	3-341/00	ASSY. SPOUT, WIDESPREAD, COURONNE/MARVELLE	1
5.1	2-037/00	SUB-ASSY. SPOUT COURONNE/MARVELLE SERIES	1
5.2	11179/00	SPOUT CAP, COURONNE SERIES	1
5.3	90025	O-RING, 1-3/16"ID X 1/16"THK, AS-568-025	1
5.4	11429	AERATOR CACHE JR, 1.2GPM, M21.5X1.0, 42.2260.450	1
5.5	10745	THREAD ALL, 3/8"-18 NPSL - 3/8"NPT	1
5.6	1-112	TEE VALVE, 3/8" NPSM X 3/8" COMPRESSION	1
5.7	10746	NUT, 3/8"-18 NPSL	1
5.8	92174	WASHER MOUNT WIDESPREAD (3/8")	1
6	1-700	WIDESPREAD VALVE 16PT, HOT & COLD, W/ FLUSH MOUNTING KITS	1
6.1	1-149	WIDESPREAD VALVE LAV 16PT, HOT, ONLY	1
6.2	1-150	WIDESPREAD VALVE LAV 16PT, COLD, ONLY	1
6.3	2-410	RECESSED FLUSHED MOUNTING KIT FOR WIDESPREAD W/O WASHER/NUT	2
6.4	92251	HEX NUT, 1"-20 THREAD	2
6.5	92252	WASHER, 1-1/32" ID 1-13/16" OD	2
7	3-545/00	BRASS PUSH TYPE DRAIN, W/ OVERFLOW & SMALL PLUG	1
8	92152	SET SCREW, CUP PT. 10-24 UNC X 5/8"L	1

ALL	D	MODIFIED & ADDED COMPONENTS, REMOVED POP UP ASSY	11/5/2024	RAH
ZONE	REV.	DESCRIPTION	DATE	APPROVED
REVISIONS				

1261 LOGAN AVENUE  
COSTA MESA, CALIFORNIA 92626  
PHONE: 714.361.4800  
FAX: 714.617.3120

**PHYLIRICH®**  
Defining Luxury Since 1959

PROPRIETARY AND CONFIDENTIAL  
THE INFORMATION CONTAINED IN THIS DRAWING  
IS THE SOLE PROPERTY OF PHYLIRICH. ANY  
REPRODUCTION IN PART OR AS A WHOLE  
WITHOUT THE WRITTEN PERMISSION OF PHYLIRICH  
IS PROHIBITED.  
DO NOT SCALE DRAWING

WIDESPREAD FAUCET, CROSS HANDLES,  
MARVELLE

SIZE <b>A</b>	ASM/PRT NO. 162-01/00	REV D
SCALE: 1:5	WEIGHT: lbs.	SHEET 1 OF 2