

NOTE(S):
1. PART NUMBER, "/00" DENOTES PART SHALL HAVE FINISH.

2. APPLY NSF COMPLIANT GREASE TO ANY O-RING, SEALING JOINTS, AND/OR PIVOTAL POINTS.

3. APPLY NSF COMPLIANT LOCTITE TO THREADED AREA.

4. APPLY NSF COMPLIANT REMOVABLE (BLUE) LOCTITE TO THREADED AREA.

5. SILVER SOLDER JOINTS SHALL BE FULLY WETTED VIA CAPILLARY ACTION AND COMPLETELY NON-POROUS.



| ITEM NO. | PART NUMBER | DESCRIPTION | QTY. |
|----------|-------------|---|------|
| 1 | 11366 | HOSE, SUPPLY, FREE STANDING TUB FILLER | 2 |
| 2 | 11367 | CONNECTOR, BODY TO RISER | 1 |
| 3 | 11368/00 | RISER, SUPPLY TUBE | 1 |
| 4 | 3-049/00 | ASSY, HOSE KIT, HANDSHOWER | 1 |
| 5 | 3-471/00 | ASSY, ROUND HANDSHOWER, CONTEMPORARY | 1 |
| 6 | 3-503/00 | ASSY, MAIN BODY, TUB-FILLER, W/ SHOWER HOOK | 1 |
| 7 | 3-504/00 | ASSY, RISER & BASE, FLOOR MOUNT TUB FILLER | 1 |
| 8 | 3-506/00 | ASSY, FLAT/LOW SQUARE SPOUT, FLOOR MOUNT TUB FILLER | 1 |
| 9 | 3-581/00 | HANDLE LEVER W/ SET SCREW, TRANSITION | 1 |
| 9.1 | 92223 | SCREW, SOCKET HD. SS, 8-32 X 5/8"L | 1 |
| 9.2 | 92163 | SET SCREW, CUP PT 8-32 X 1/8"L | 1 |
| 9.3 | 11706/00 | HUB, LEVER HANDLE | 1 |
| 9.4 | 11707/00 | HANDLE, LEVER | 1 |
| 10 | 92176 | WEAR WASHER | 1 |
| 11 | P05024 | AERATOR CACHE COIN SLOT, M21.5X1.0 FULL FLOW | 1 |
| 12 | P05025 | AERATOR, BASIC KEY, PLASTIC RED | 1 |

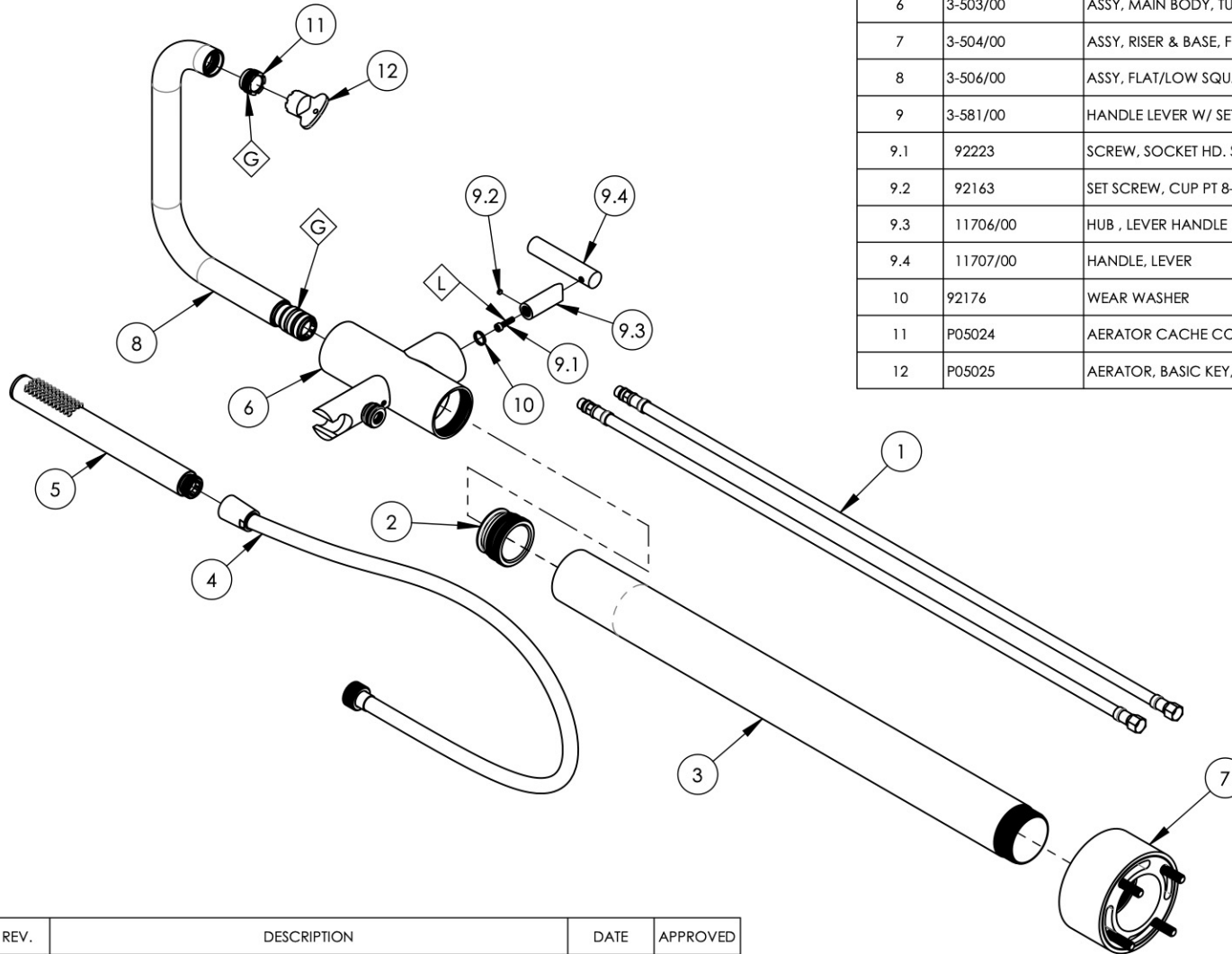

| ZONE | REV. | DESCRIPTION | DATE | APPROVED |
|------|------|-------------|------|----------|
|------|------|-------------|------|----------|

REVISIONS

1261 LOGAN AVENUE
COSTA MESA, CALIFORNIA 92626
PHONE: 714.361.4800
FAX: 714.617.3120

PHYLIRICH[®]
Defining Luxury Since 1959

PROPRIETARY AND CONFIDENTIAL
THE INFORMATION CONTAINED IN THIS DRAWING IS THE SOLE PROPERTY OF PHYLIRICH. ANY REPRODUCTION IN PART OR AS A WHOLE WITHOUT THE WRITTEN PERMISSION OF PHYLIRICH IS PROHIBITED.
DO NOT SCALE DRAWING

**FLOOR MOUNT TUB FILLER W/
HANDSHOWER SET, SINGLE HOLE TALL,
LOW SPOUT W/ LEVER, TRANSITION**

| | | |
|------------------|-----------------------------|--------------|
| SIZE A | ASM/PRT NO. 120-47-01/00 | REV - |
| SCALE: 1:6 | WEIGHT: lbs. | SHEET 1 OF 2 |