

NOTE(S):  
1. PART NUMBER, "/00" DENOTES PART SHALL HAVE FINISH.

2. APPLY NSF COMPLIANT GREASE TO ANY O-RING, SEALING JOINTS, AND/OR PIVOTAL POINTS.

3. APPLY NSF COMPLIANT LOCTITE TO THREADED AREA:

4. APPLY NSF COMPLIANT REMOVABLE (BLUE) LOCTITE TO THREADED AREA:

5. SILVER SOLDER JOINTS SHALL BE FULLY WETTED VIA CAPILLARY ACTION AND COMPLETELY NON-POROUS:



ITEM NO.	PART NUMBER	DESCRIPTION	QTY.	
1	11366	HOSE, SUPPLY, FREE STANDING TUB FILLER	2	
2	11367	CONNECTOR, BODY TO RISER	1	
3	12189/00	RISER, SUPPLY TUBE, SHORT	1	
4	3-049/00	ASSY, HOSE KIT, HANDSHOWER	1	
5	3-471/00	ASSY, ROUND HANDSHOWER, CONTEMPORARY	1	
6	3-503/00	ASSY, MAIN BODY, TUB-FILLER, W/ SHOWER HOOK	1	
7	3-504/00	ASSY, RISER & BASE, FLOOR MOUNT TUB FILLER	1	
8	3-506/00	ASSY, FLAT/LOW SQUARE SPOUT, FLOOR MOUNT TUB FILLER	1	
9	3-580/00	HANDLE CROSS W/ SET SCREW, TRANSITION	1	
9.1	2-301/00	BRAZE, CROSS HANDLE, HUB	1	
9.2	92163	SET SCREW, CUP PT 8-32 X 1/8"L	1	
10	92176	WEAR WASHER	1	
11	P05024	AERATOR CACHE COIN SLOT, M21.5X1.0 FULL FLOW	1	
12	P05025	AERATOR, BASIC KEY, PLASTIC RED	1	

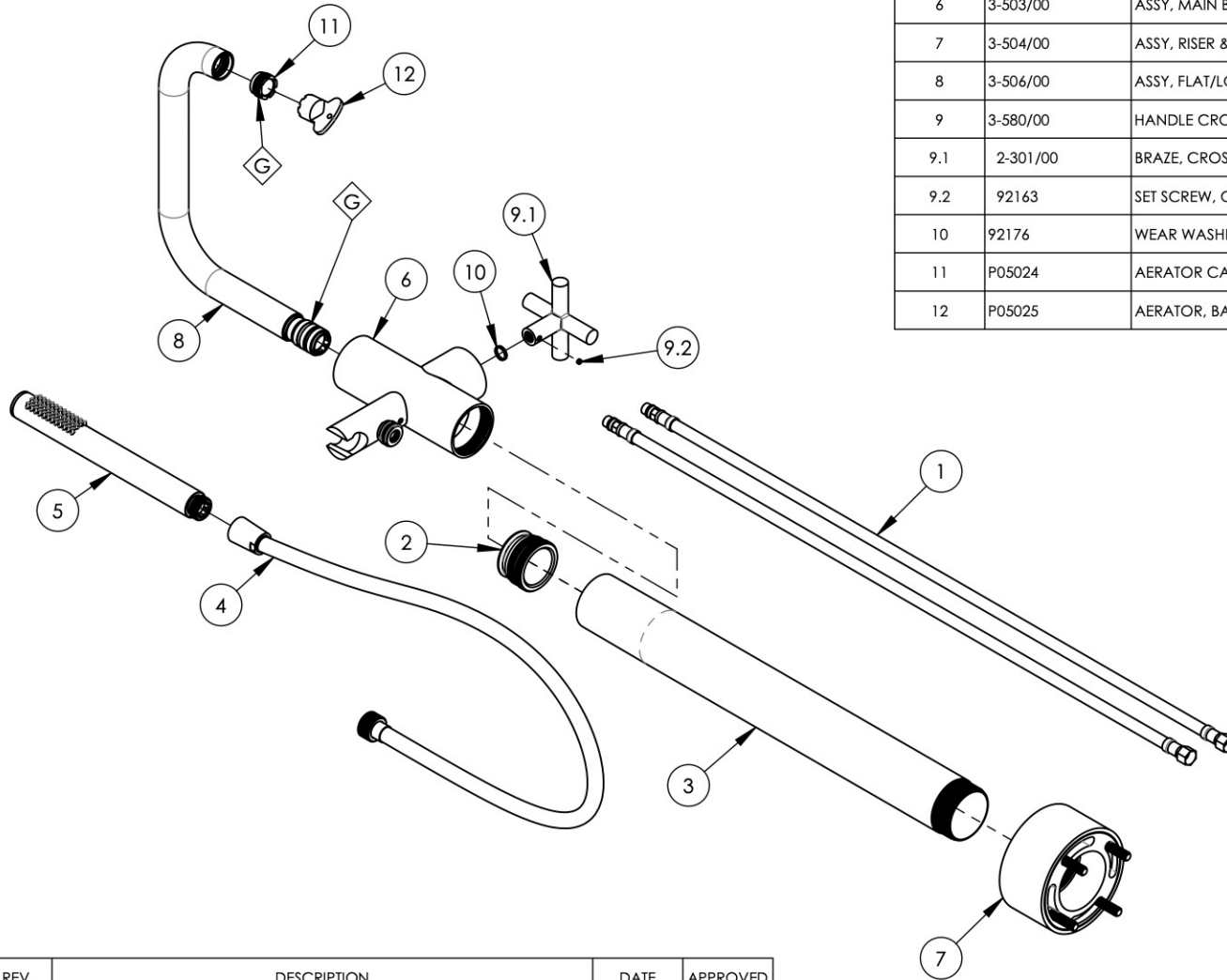

ZONE	REV.	DESCRIPTION	DATE	APPROVED
REVISIONS				

1261 LOGAN AVENUE  
COSTA MESA, CALIFORNIA 92626  
PHONE: 714.361.4800  
FAX: 714.617.3120

**PHYLIRICH®**  
Defining Luxury Since 1959

**PROPRIETARY AND CONFIDENTIAL**  
THE INFORMATION CONTAINED IN THIS DRAWING IS THE SOLE PROPERTY OF PHYLIRICH. ANY REPRODUCTION IN PART OR AS A WHOLE WITHOUT THE WRITTEN PERMISSION OF PHYLIRICH IS PROHIBITED.  
**DO NOT SCALE DRAWING**

**FLOOR MOUNT TUB FILLER W/  
HANDSHOWER SET, SINGLE HOLE SHORT,  
LOW SPOUT W/ CROSS, TRANSITION**

SIZE	ASM/PRT NO.	REV
<b>A</b>	<b>120-46-03/00</b>	-
SCALE: 1:6	WEIGHT: lbs.	SHEET 1 OF 2