

- NOTE(S):
1. PART NUMBER, "/00" DENOTES PART SHALL HAVE FINISH.
  2. APPLY NSF COMPLIANT GREASE TO ANY O-RING, SEALING JOINTS, AND/OR PIVOTAL POINTS.
  3. APPLY NSF COMPLIANT LOCTITE TO THREADED AREA.
  4. APPLY NSF COMPLIANT REMOVABLE (BLUE) LOCTITE TO THREADED AREA.
  5. SILVER SOLDER JOINTS SHALL BE FULLY WETTED VIA CAPILLARY ACTION AND COMPLETELY NON-POROUS.
  6. FOR DEEPER ESCUTCHEON:  
A. 3-353/00  
B. 92401

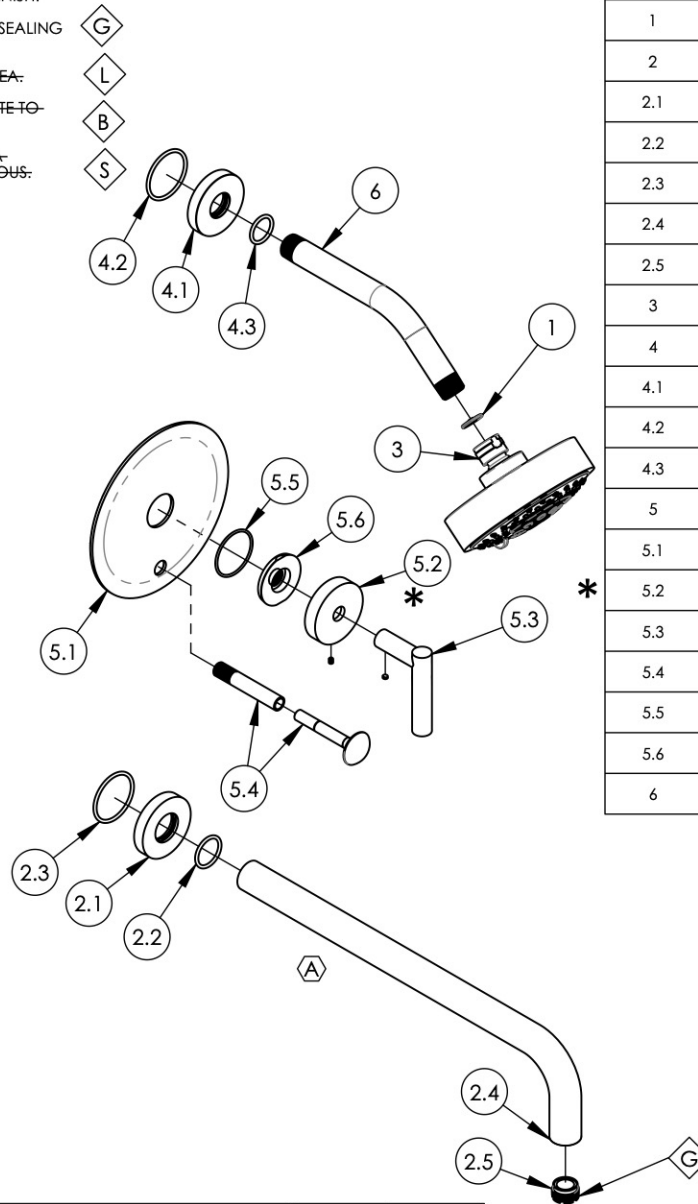

ITEM NO.	PART NUMBER	DESCRIPTION	QTY.	
1	11432	1.75 GPM FLOW REGULATOR	1	
2	3-421/00	WALL TUB, SPOUT ONLY, 14" L, BASIC	1	
2.1	P19017/00	ESCUTCHEON, FOR SPOUT	1	
2.2	90119	O-RING, 15/16"ID X 1-1/8"OD X 3/32"THK, AS-568-119	1	
2.3	90129	O-RING, 1-9/16"ID X 3/32"THK, AS-568-129	1	
2.4	10481/00	14" WALL LAV SPOUT, BASIC SERIES	1	
2.5	P05024	AERATOR CACHE COIN SLOT, M21.5X1.0 FULL FLOW	1	
3	3-454/00	SHOWER HEAD MULTI. FUNC. CONTEMP.	1	
4	3-700/00	SHOWER FLANGE, CONTEMPORARY, ROUND	1	
4.1	P16019/00	BASE SHOWER FLANGE, BASIC SERIES	1	
4.2	90129	O-RING, 1-9/16"ID X 3/32"THK, AS-568-129	1	
4.3	90117	O-RING, 7/8"ID X 33/32"THK., AS-568-117	1	
5	4-597/00	SHOWER TRIM PLATE, PRESSURE BALANCE DIVERTED, LEVER, TRANSITION	1	
5.1	10445/00	TRIM PLATE 6" ROUND W/ DIVERTER HOLE, BASIC II	1	
5.2	3-590/00	ESCUTCHEON W/ SET SCREW, TRANSITION	1	
5.3	3-581/00	HANDLE LEVER W/ SET SCREW, TRANSITION	1	
5.4	3-125/00	DIVERTER EXTENSION ASSY FOR PB TUB & SHOWER SET	1	
5.5	90029	O-RING, 1-5/8"ID X 1-3/4"OD X 1/16"THK, AS-568-029	1	
5.6	11003	SLEEVE MOUNT, WALL MT WIDESPREAD	1	
6	P16008/00	SHOWER ARM (8 INCH)	1	

B4	A	UPDATE SPOUT ASSEMBLY	11/2/2021	AMM
ZONE	REV.	DESCRIPTION	DATE	APPROVED
REVISIONS				

1261 LOGAN AVENUE  
COSTA MESA, CALIFORNIA 92626  
PHONE: 714.361.4800  
FAX: 714.617.3120

**PHYLIRICH®**  
Defining Luxury Since 1959

**PROPRIETARY AND CONFIDENTIAL**  
THE INFORMATION CONTAINED IN THIS DRAWING IS THE SOLE PROPERTY OF PHYLIRICH. ANY REPRODUCTION IN PART OR AS A WHOLE WITHOUT THE WRITTEN PERMISSION OF PHYLIRICH IS PROHIBITED.  
**DO NOT SCALE DRAWING**

**SHOWER TRIM SET, PB, TUB & SHOWER, SPOUT 14" W/ LEVER, TRANSITION**

SIZE	ASM/PRT NO.	REV
<b>A</b>	120-27-14/00	<b>A</b>
SCALE: 1:6	WEIGHT: lbs.	SHEET 1 OF 2