

ITEM NO.	PART NUMBER	DESCRIPTION	QTY.
1	3-055/00	TP ROLL SPRING HOLDER	1
2	92010	SET SCREW, CUP POINT 8-32UNC 5/16" LENGTH SS	2
3	P23039/00	KCW BACK PLATE	2
4	P23040	KR WALL INSERT	2
5	P23047/00	KCW50/65 POST	2
6	P36005	#6 DRY WALL SCREW	4
7	P39001	HEX KEY 5/64, FOR 8-32 SET SCREW	1

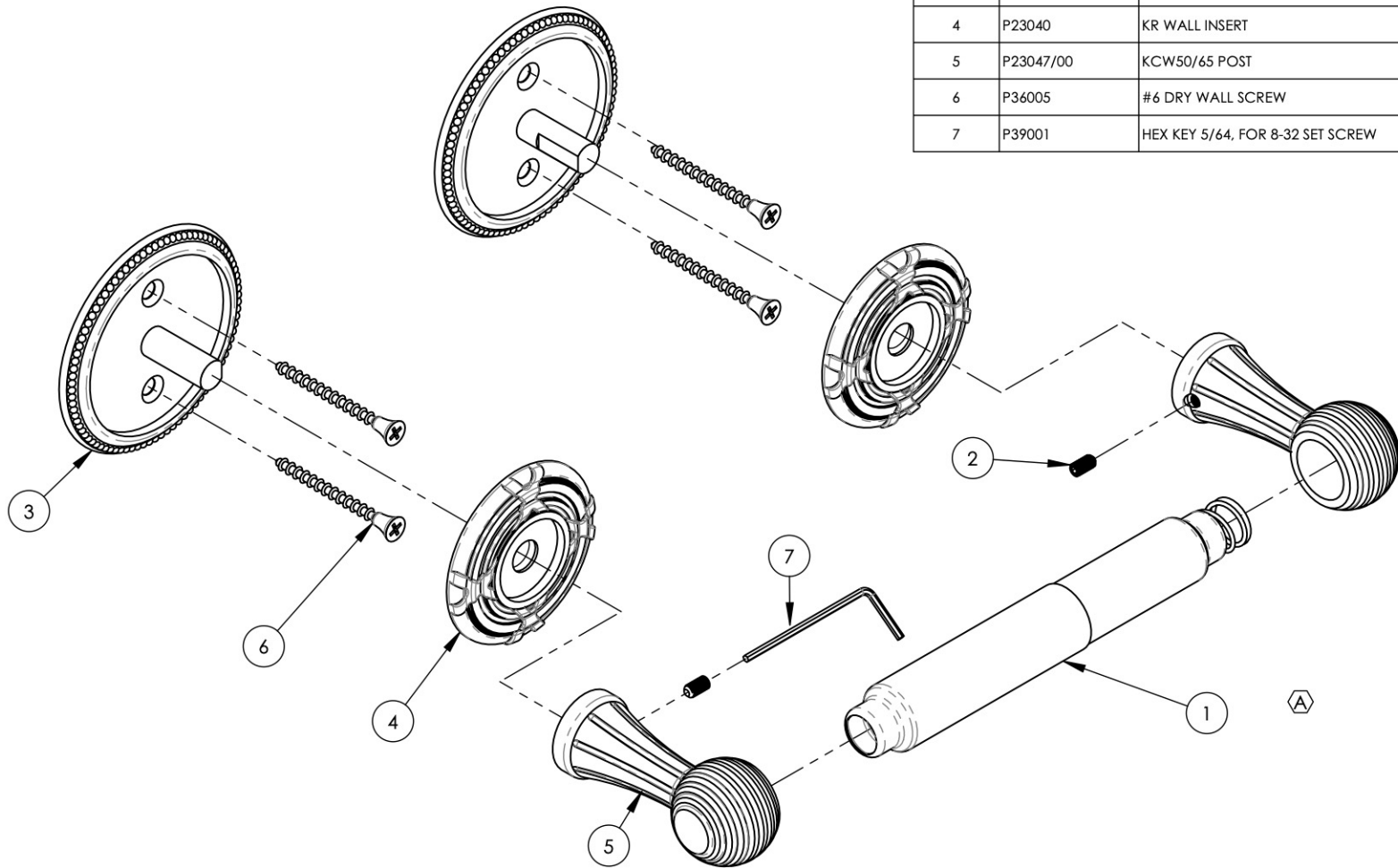

ALL	REV.	DESCRIPTION	DATE	APPROVED
A		UPDATE ROLLER & TEMPLATE	7/7/2020	AMM
REVISIONS				

1261 LOGAN AVENUE  
COSTA MESA, CALIFORNIA 92626  
PHONE: 714.361.4800  
FAX: 714.617.3120

**PHYLIRICH**<sup>®</sup>  
Defining Luxury Since 1959

**PROPRIETARY AND CONFIDENTIAL**  
THE INFORMATION CONTAINED IN THIS DRAWING IS THE SOLE PROPERTY OF PHYLIRICH. ANY REPRODUCTION IN PART OR AS A WHOLE WITHOUT THE WRITTEN PERMISSION OF PHYLIRICH IS PROHIBITED.

-	-	INTERPRET GEOMETRIC DIMENSIONING & TOLERANCING IN ACCORDANCE WITH ASME Y14.5-2009 & ASME Y14.41-2003 STANDARDS, UNLESS OTHERWISE SPECIFIED. DIMENSIONS ARE IN INCHES. TOLERANCES ARE:		
NEXT ASSY	USED ON	FRACTIONS ±1/16"	DECIMALS X.X: ±.1 X.XX: ±.01 X.XXX: ±.005	ANGULAR ±2°
APPLICATION		MATERIAL	NAME	DATE
FINISH		DRAWN	LLO	8/21/2013
DO NOT SCALE DRAWING		CHECKED	GRE	

TP HOLDER DOUBLE POST, RIBBON & REED (137-73/00)

SIZE	ASM/PRT NO.	REV
<b>A</b>	KR50/00	<b>A</b>
SCALE: 1:2	WEIGHT: lbs.	SHEET 1 OF 2