

5

4

3

2

1

NOTE(S):
 1. APPLY NSF COMPLIANT GREASE TO ANY O-RING, SEALING JOINTS, AND/OR PIVOTAL POINTS.



ITEM NO.	PART NUMBER	DESCRIPTION	QTY.
1	3-018/00	SHOWERHEAD SIX JET	1
2	90117	O-RING, 7/8"ID X 33/32"THK., AS-568-117	1
3	90138	O-RING, 2 1/8"ID X 3/32"THK., AS-568-138	1
4	P16008/00	SHOWER ARM (8 INCH)	1
5	P16011/00	K803 SHOWER FLANGE	1

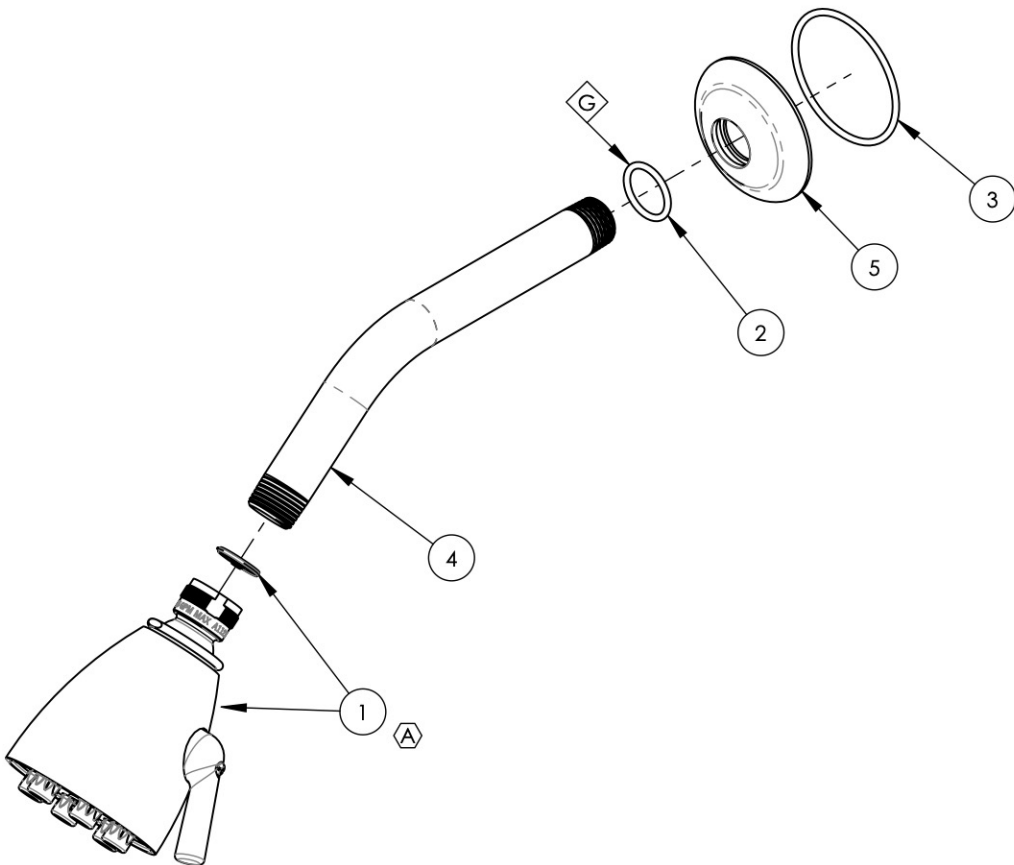

B5	A	UPDATE TEMPLATE & SHOWER HEAD, ADD CALL OUTS	4/13/2020	AMM
ZONE	REV.	DESCRIPTION	DATE	APPROVED
REVISIONS				

1261 LOGAN AVENUE
 COSTA MESA, CALIFORNIA 92626
 PHONE: 714.361.4800
 FAX: 714.617.3120

PHYLIRICH[®]
 Defining Luxury Since 1959

PROPRIETARY AND CONFIDENTIAL
 THE INFORMATION CONTAINED IN THIS DRAWING IS THE SOLE PROPERTY OF PHYLIRICH. ANY REPRODUCTION IN PART OR AS A WHOLE WITHOUT THE WRITTEN PERMISSION OF PHYLIRICH IS PROHIBITED.

-	-	INTERPRET GEOMETRIC DIMENSIONING & TOLERANCING IN ACCORDANCE WITH ASME Y14.5-2009 & ASME Y14.41-2003 STANDARDS, UNLESS OTHERWISE SPECIFIED. DIMENSIONS ARE IN INCHES. TOLERANCES ARE:
-	-	
-	-	
NEXT ASSY	USED ON	FRACTIONS $\pm 1/16"$ DECIMALS X.X: $\pm .1$ X.XX: $\pm .01$ X.XXX: $\pm .005$ ANGULAR $\pm 2^\circ$
APPLICATION		
MATERIAL	NAME	DATE
FINISH	DRAWN	CA 7/22/2013
DO NOT SCALE DRAWING		
CHECKED		

SMOOTH SHOWER HEAD

SIZE	ASM/PRT NO.	REV
A	K803/00	A
SCALE: 1:8	WEIGHT: lbs.	SHEET 1 OF 2

5

4

3

2

1