

5

4

3

2

1

- NOTE(S):  
 1. PART NUMBER, "/00" DENOTES PART SHALL HAVE FINISH.  
 2. APPLY NSF COMPLIANT GREASE TO ANY O-RING, SEALING JOINTS, AND/OR PIVOTAL POINTS.  
 3. APPLY NSF COMPLIANT LOCTITE TO THREADED AREA.  
 4. APPLY NSF COMPLIANT REMOVABLE (BLUE) LOCTITE TO THREADED AREA.  
 5. SILVER SOLDER JOINTS SHALL BE FULLY WETTED VIA CAPILLARY ACTION AND COMPLETELY NON-POROUS.



ITEM NO.	PART NUMBER	DESCRIPTION	QTY.
1	10639/00	ESCUTCHEON, WALL MOUNT CONTEMP.	2
2	10642/00	EXTENSION POST, TP HOLDER	2
3	10645/00	TOWEL BAR, 18" X .049" THK	1
4	2-098	MOUNTING KIT FOR MIX/EDGE SERIES	2
4.1	30042	WALL MOUNTING PLATE	1
4.2	92043	SCREW, FLAT HD #10 SIZE W/ #2 PHIL DRIVE, 2"L	2
4.3	92046	ANCHOR SCREW 3/8" HOLE, TOGGLER AF10	2
5	92008	SET SCREW, CUP POINT 8-32, 3/16" L.	2
6	92021	HEX KEY 5/64, FOR 8-32 SET SCREW	1
7	92207	SCREW, PAN HEAD, PHILLIPS, 1/4"-20 X 3/8"L, SS	2

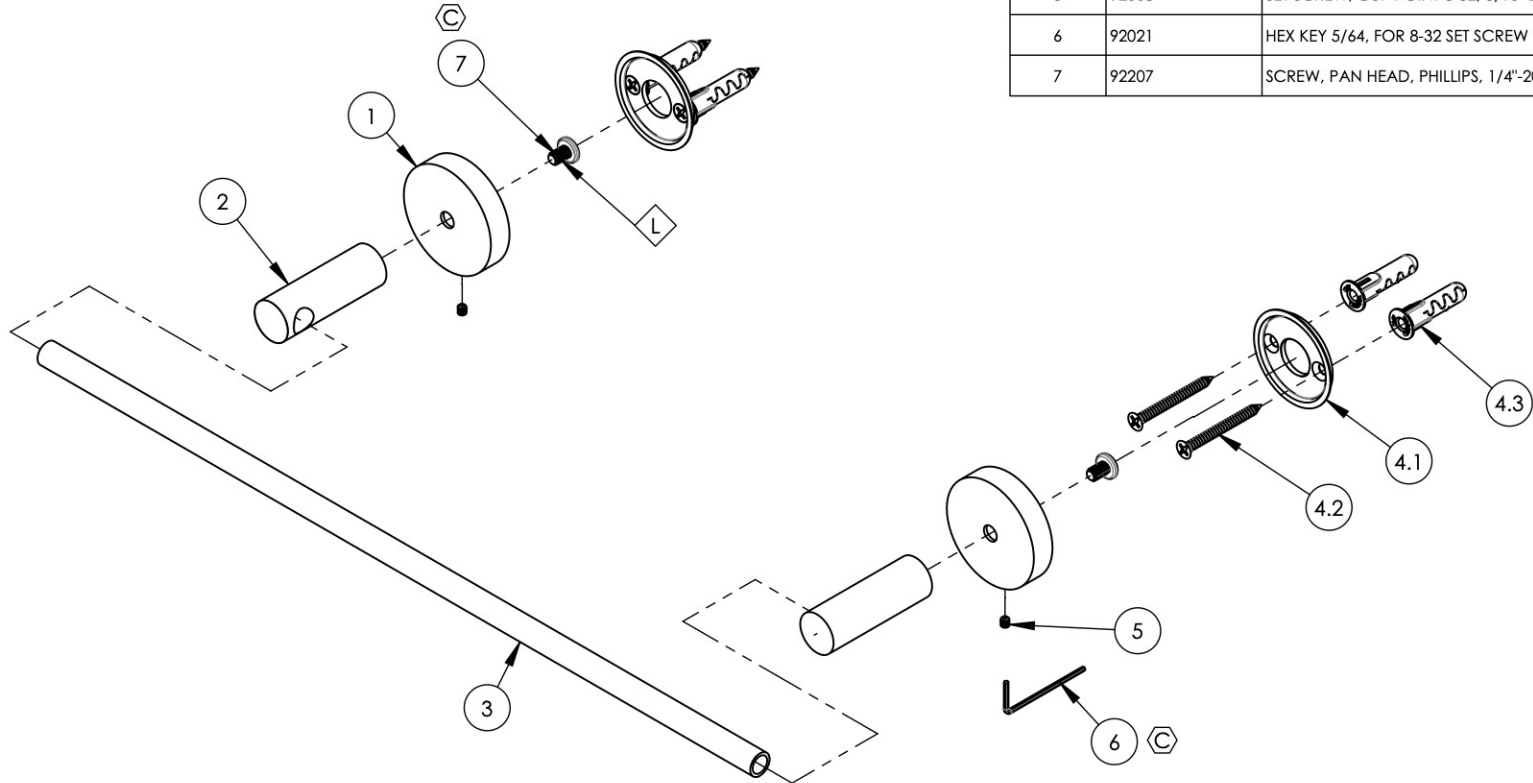

ZONE	REV.	DESCRIPTION	DATE	APPROVED
D4, B3	C	UPDATE SCREW, ADD HEX KEY	12/2/2020	AMM
REVISIONS				

1261 LOGAN AVENUE  
 COSTA MESA, CALIFORNIA 92626  
 PHONE: 714.361.4800  
 FAX: 714.617.3120

**PHYLIRICH**<sup>®</sup>  
 Defining Luxury Since 1959

**PROPRIETARY AND CONFIDENTIAL**  
 THE INFORMATION CONTAINED IN THIS DRAWING IS THE SOLE PROPERTY OF PHYLIRICH. ANY REPRODUCTION IN PART OR AS A WHOLE WITHOUT THE WRITTEN PERMISSION OF PHYLIRICH IS PROHIBITED.  
**DO NOT SCALE DRAWING**

ACCESSORIES, 18" TOWEL BAR, BASIC, (130-70)

SIZE <b>A</b>	ASM/PRT NO. DB65/00	REV C
SCALE: 1:3.5	WEIGHT: lbs.	SHEET 1 OF 2

5

4

3

2

1