

- NOTE(S):
 1. PART NUMBER, "/00" DENOTES PART SHALL HAVE FINISH.
 2. APPLY NSF COMPLIANT GREASE TO ANY O-RING, SEALING JOINTS, AND/OR PIVOTAL POINTS.
 3. APPLY NSF COMPLIANT LOCTITE TO THREADED AREA.

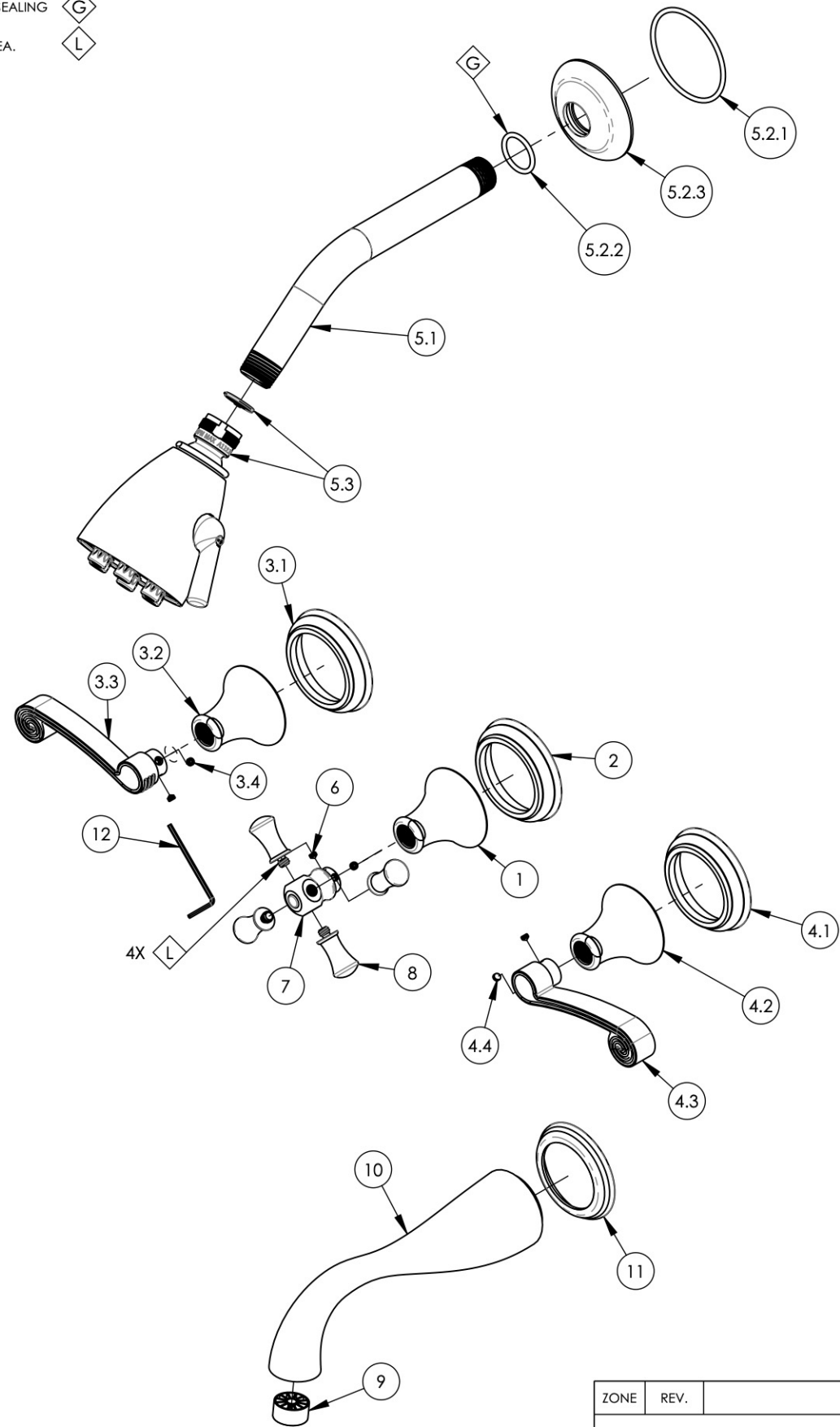

ITEM NO.	PART NUMBER	DESCRIPTION	QTY.
1	10972/00	HUB, TRANSITIONAL 3RING	1
2	11188/00	ESCUTCHEON, HANDLE BASE 3RING	1
3	3-476/00	ASSY. LEFT CURVED LEVER HANDLE, 3 RING SERIES	1
3.1	11188/00	ESCUTCHEON, HANDLE BASE 3RING	1
3.2	10972/00	HUB, TRANSITIONAL 3RING	1
3.3	P01082	3 RING CURVED HANDLE, LEFT	1
3.4	92163	SET SCREW, CONE PT 8-32 X 1/8"L	2
4	3-477/00	ASSY. RIGHT CURVED LEVER HANDLE, 3 RING SERIES	1
4.1	11188/00	ESCUTCHEON, HANDLE BASE 3RING	1
4.2	10972/00	HUB, TRANSITIONAL 3RING	1
4.3	P01080	3 RING CURVED HANDLE, RIGHT	1
4.4	92163	SET SCREW, CONE PT 8-32 X 1/8"L	2
5	4-140/00	SHOWER HEAD 8" ARM, 6 JET PLUNGER, HEX TRADITIONAL	1
5.1	P16008/00	SHOWER ARM (8 INCH)	1
5.2	810/00	SHOWER FLANGE, TRADITIONAL	1
5.2.1	90138	O-RING, 2 1/8"ID X 3/32"THK., AS-568-138	1
5.2.2	90117	O-RING, 7/8"ID X 33/32"THK., AS-568-117	1
5.2.3	P16011/00	K803 SHOWER FLANGE	1
5.3	3-018/00	SHOWERHEAD SIX JET	1
6	92163	SET SCREW, CONE PT 8-32 X 1/8"L	2
7	P01056/00	D103 HANDLE BALL	1
8	P01057/00	SPOKE FOR HANDLE, D103	4
9	P03061	#CH-101-6 PLTC WTR STNR FOR SPOUT	1
10	P26001/00	DORALFE WALL TUB SPOUT	1
11	P26018/00	ESCUTCHEON BASE, 3RING WALL SPOUT	1
12	P39001	HEX KEY 5/64, FOR 8-32 SET SCREW	1

ZONE	REV.	DESCRIPTION	DATE	APPROVED	
REVISIONS					
1261 LOGAN AVENUE COSTA MESA, CALIFORNIA 92626 PHONE: 714.361.4800 FAX: 714.617.3120		PHYLIRICH Defining Luxury Since 1959	PROPRIETARY AND CONFIDENTIAL THE INFORMATION CONTAINED IN THIS DRAWING IS THE SOLE PROPERTY OF PHYLIRICH. ANY REPRODUCTION IN PART OR AS A WHOLE WITHOUT THE WRITTEN PERMISSION OF PHYLIRICH IS PROHIBITED.		

-	-	INTERPRET GEOMETRIC DIMENSIONING & TOLERANCING IN ACCORDANCE WITH ASME Y14.5-2009 & ASME Y14.41-2003 STANDARDS. UNLESS OTHERWISE SPECIFIED, DIMENSIONS ARE IN INCHES. TOLERANCES ARE:		
NEXT ASSY	USED ON	FRACTIONS ±1/16"	DECIMALS X.X: ±.1 X.XX: ±.01 X.XXX: ±.005	ANGULAR ±2°
APPLICATION		MATERIAL	NAME	DATE
FINISH		DRAWN	AMM	4/14/2020
DO NOT SCALE DRAWING		CHECKED		

THREE HANDLE TUB AND SHOWER SET, CURVED LEVER, 3 RING				
SIZE	ASM/PRT NO.	REV		
B	D2206/00	A		
SCALE: 1:3.5	WEIGHT: lbs.	SHEET 1 OF 2		