

- NOTE(S):
- PART NUMBER, "/00" DENOTES PART SHALL HAVE FINISH.
 - APPLY NSF COMPLIANT GREASE TO ANY O-RING, SEALING JOINTS, AND/OR PIVOTAL POINTS.
 - APPLY NSF COMPLIANT LOCTITE TO THREADED AREA.
 - APPLY NSF COMPLIANT REMOVABLE (BLUE) LOCTITE TO THREADED AREA.
 - SILVER SOLDER JOINTS SHALL BE FULLY WETTED VIA CAPILLARY ACTION AND COMPLETELY NON-POROUS.

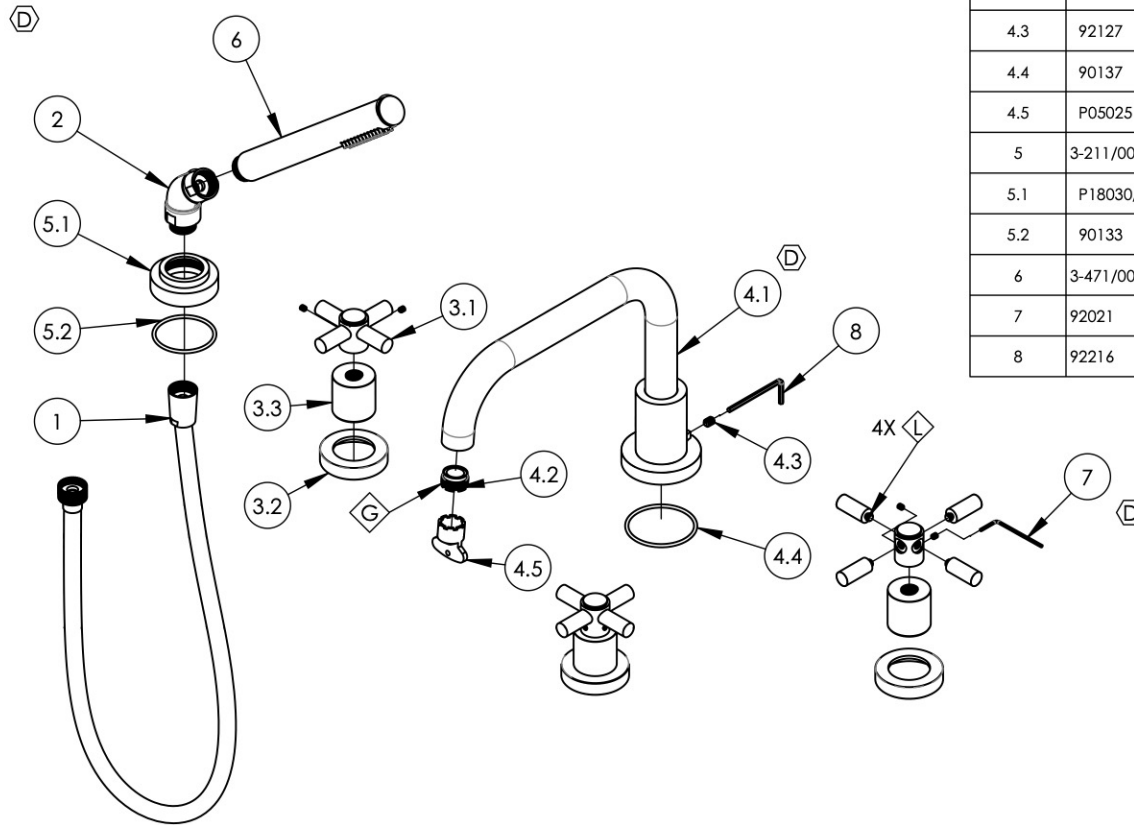

ITEM NO.	PART NUMBER	DESCRIPTION	QTY.
1	3-049/00	ASSY, HOSE KIT, HANDSHOWER	1
2	3-050/00	ELBOW ASSEMBLY	1
3	3-186/00	TUBULAR CROSS HANDLE FOR DECK TUB, BASIC SERIES	3
3.1	3-439/00	ASSY. CROSS HANDLE TUBULAR, BASIC SERIES	1
3.2	11108/00	ESCUTCHEON LARGE ID FOR RT/PB, BASIC SERIES	1
3.3	11107/00	HUB LARGE FOR RT, BASIC SERIES	1
4	3-191/00	DECK TUB, SPOUT ONLY, LOW SPOUT, BASIC	1
4.1	2-168/00	SUB ASSY. FLAT TUB SPOUT, DECK TUB BASIC	1
4.2	P05024	AERATOR CACHE COIN SLOT, M21.5X1.0 FULL FLOW	1
4.3	92127	SET SCREW, CUP PT, 1/4"-20 X 5/16"L, SS	1
4.4	90137	O-RING, 2-1/16"ID X 3/32"THK., AS-568-137	1
4.5	P05025	AERATOR, BASIC KEY, PLASTIC RED	1
5	3-211/00	ESCUTCHEON BASE, HANDSHOWER, BASIC	1
5.1	P18030/00	ESCUTCHEON BASE, DECK TUB, HANDSHOWER, BASIC	1
5.2	90133	1 3/4"O-RING, 1-13/16ID X 3/32THK, AS-568-133	1
6	3-471/00	ASSY, ROUND HANDSHOWER, CONTEMPORARY	1
7	92021	HEX KEY 5/64, FOR 8-32 SET SCREW	1
8	92216	HEX L-KEY 1/8" HEX x 2-5/16"L	1



ALL	D	DISSOLVE HANDSHOWER SUBASSEMBLY, UPDATE HEX KEY & SPOUT SUBASSEMBLY	11/10/2021	AMM
ZONE	REV.	DESCRIPTION	DATE	APPROVED
REVISIONS				

1261 LOGAN AVENUE
COSTA MESA, CALIFORNIA 92626
PHONE: 714.361.4800
FAX: 714.617.3120

PHYLIRICH[®]
Defining Luxury Since 1959

PROPRIETARY AND CONFIDENTIAL
THE INFORMATION CONTAINED IN THIS DRAWING IS THE SOLE PROPERTY OF PHYLIRICH. ANY REPRODUCTION IN PART OR AS A WHOLE WITHOUT THE WRITTEN PERMISSION OF PHYLIRICH IS PROHIBITED.
DO NOT SCALE DRAWING

DECK TUB W/ HANDSHOWER SET, LOW SPOUT W/ CROSS TUBULAR, BASIC, (131-49)

SIZE A	ASM/PRT NO. D2136D1/00	REV D
SCALE: 1:6	WEIGHT: lbs.	SHEET 1 OF 2