

ITEM NO.	PART NUMBER	DESCRIPTION	QTY.
1	11064/00	BAR TUBE, FOR 30" TOWEL BAR	1
2	11065/00	SLIDEBAR POST, TOWEL BAR HEX MODERN 501 SERIES	2
5	11732/00	ESCUTCHEON, TRANSITIONAL	2
4	2-103	MOUNTING KIT WITH ADJUSTABLE THREADED PIN	2
4.1	11050	MOUNTING KIT, WALL FLANGE	1
4.2	92234	SCREW FOR WOOD, PHIL. NO. 8 X 1-1/2" L	2
4.3	92235	ANCHOR FOR DRYWALL, TWIST-ACTION NO. 6-8 SIZE	2
5	92008	SET SCREW, CUP POINT 8-32, 3/16" L.	2
6	P39001	HEX KEY 5/64, FOR 8-32 SET SCREW	1

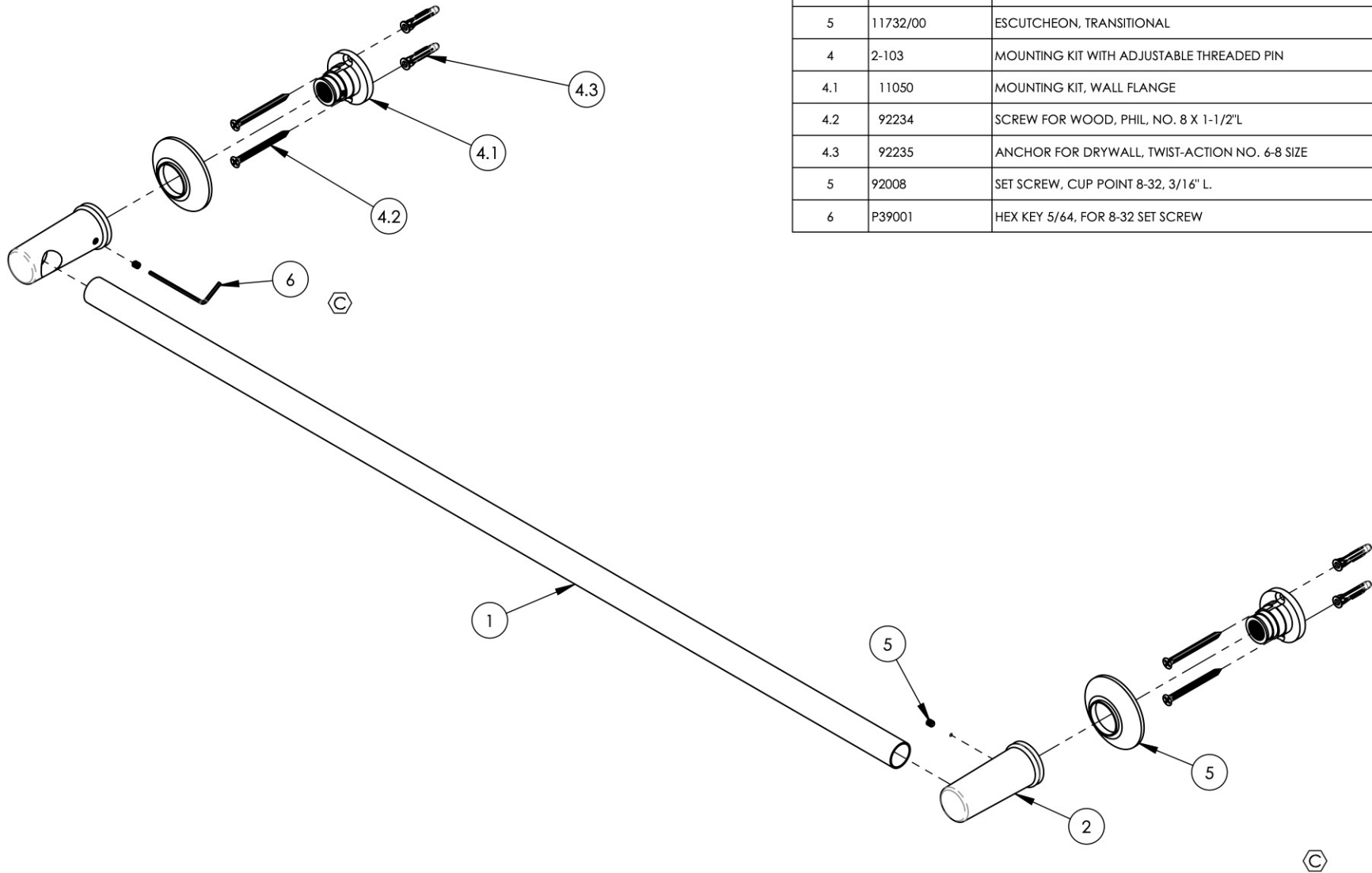

ALL	C	UPDATE TEMPLATE & DWG NAME, ADD HEX KEY	12/10/2019	AMM
ZONE	REV.	DESCRIPTION	DATE	APPROVED
REVISIONS				

1261 LOGAN AVENUE  
COSTA MESA, CALIFORNIA 92626  
PHONE: 714.361.4800  
FAX: 714.617.3120

# PHYLIRICH®

Defining Luxury Since 1959

**PROPRIETARY AND CONFIDENTIAL**  
THE INFORMATION CONTAINED IN THIS DRAWING IS THE SOLE PROPERTY OF PHYLIRICH. ANY REPRODUCTION IN PART OR AS A WHOLE WITHOUT THE WRITTEN PERMISSION OF PHYLIRICH IS PROHIBITED.

-	-	INTERPRET GEOMETRIC DIMENSIONING & TOLERANCING IN ACCORDANCE WITH ASME Y14.5-2009 & ASME Y14.41-2003 STANDARDS, UNLESS OTHERWISE SPECIFIED. DIMENSIONS ARE IN INCHES. TOLERANCES ARE: <b>FRACTIONS</b> ±1/16" <b>DECIMALS</b> X.X: ±.1 X.XX: ±.01 X.XXX: ±.005 <b>ANGULAR</b> ±2°
NEXT ASSY	USED ON	
APPLICATION		
MATERIAL	NAME	DATE
FINISH	DRAWN	MAF 5/22/2014
<b>DO NOT SCALE DRAWING</b>		CHECKED

## ACCESSORIES, TOWEL BAR, CENTERS, 30"L, HEX MODERN

SIZE	ASM/PRT NO.	REV
A	501-72/00	C
SCALE: 1:4	WEIGHT: lbs.	SHEET 1 OF 2

