

NOTE(S):
 1. PART NUMBER, "/00" DENOTES PART SHALL HAVE FINISH.

2. APPLY NSF COMPLIANT GREASE TO ANY O-RING, SEALING JOINTS, AND/OR PIVOTAL POINTS.

3. APPLY NSF COMPLIANT LOCTITE TO THREADED AREA:

4. APPLY NSF COMPLIANT REMOVABLE (BLUE) LOCTITE TO THREADED AREA:

5. SILVER SOLDER JOINTS SHALL BE FULLY WETTED VIA CAPILLARY ACTION AND COMPLETELY NON-POROUS.

G
L
B
S

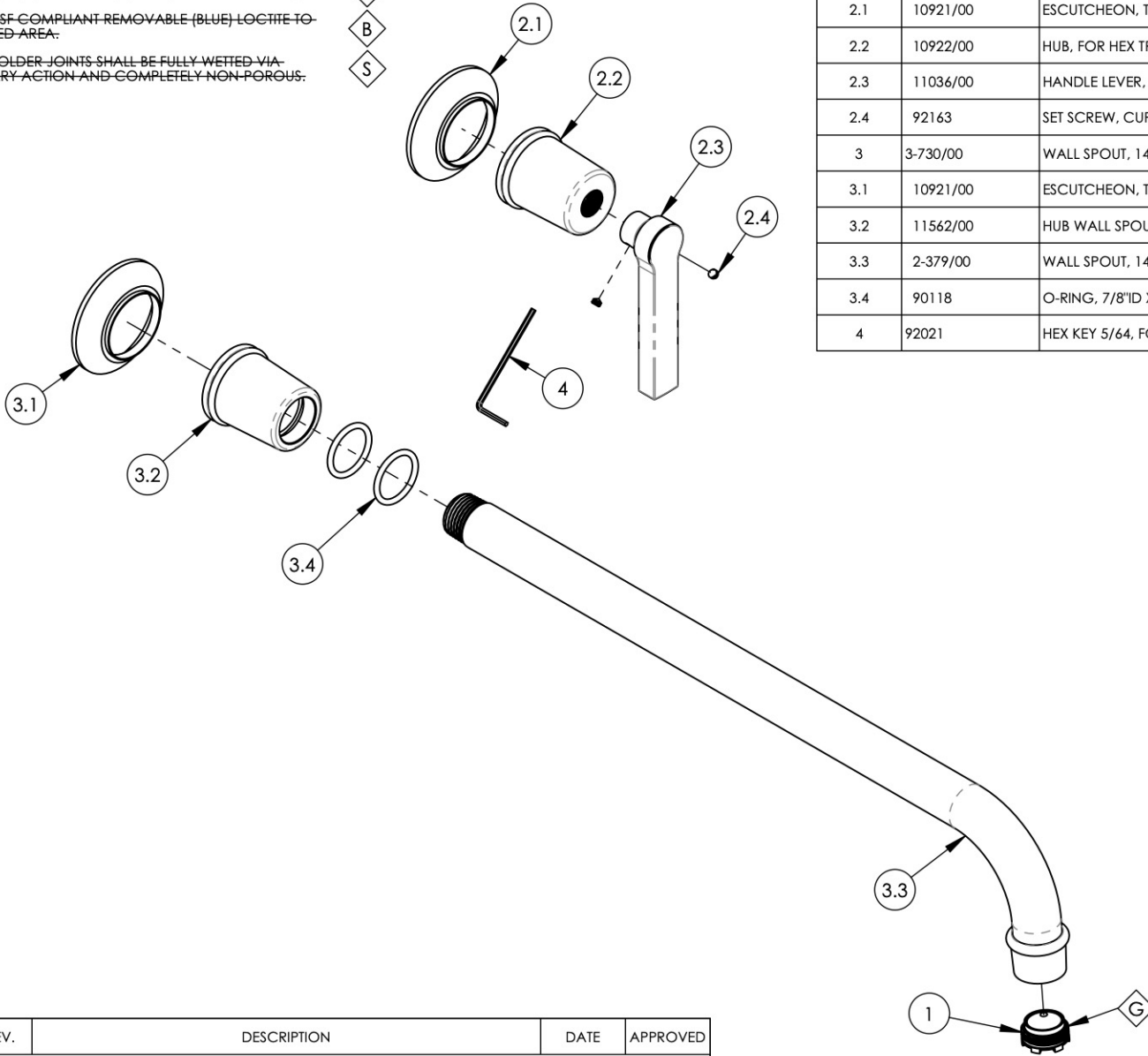

| ITEM NO. | PART NUMBER | DESCRIPTION | QTY. |
|----------|-------------|---|------|
| 1 | 11429 | AERATOR CACHE JR, 1.2GPM, M21.5X1.0, 42.2260.450 | 1 |
| 2 | 3-133/00 | LEVER HANDLE, HEX MODERN, 501 SERIES | 1 |
| 2.1 | 10921/00 | ESCUTCHEON, TRANSITIONAL | 1 |
| 2.2 | 10922/00 | HUB, FOR HEX TRANSITIONAL | 1 |
| 2.3 | 11036/00 | HANDLE LEVER, CONTEMPORARY 16PT | 1 |
| 2.4 | 92163 | SET SCREW, CUP PT 8-32 X 1/8"L | 2 |
| 3 | 3-730/00 | WALL SPOUT, 14", HEX MODERN | 1 |
| 3.1 | 10921/00 | ESCUTCHEON, TRANSITIONAL | 1 |
| 3.2 | 11562/00 | HUB WALL SPOUT, HEX MOD. TRANS. | 1 |
| 3.3 | 2-379/00 | WALL SPOUT, 14", BRAZE, HEX MODERN | 1 |
| 3.4 | 90118 | O-RING, 7/8"ID X 1-1/16"OD X 3/32"THK, AS-568-118 | 2 |
| 4 | 92021 | HEX KEY 5/64, FOR 8-32 SET SCREW | 1 |

| ZONE | REV. | DESCRIPTION | DATE | APPROVED |
|-----------|------|-------------|------|----------|
| REVISIONS | | | | |

1261 LOGAN AVENUE
 COSTA MESA, CALIFORNIA 92626
 PHONE: 714.361.4800
 FAX: 714.617.3120

PHYL RICH[®]
 Defining Luxury Since 1959

PROPRIETARY AND CONFIDENTIAL
 THE INFORMATION CONTAINED IN THIS DRAWING IS THE SOLE PROPERTY OF PHYL RICH. ANY REPRODUCTION IN PART OR AS A WHOLE WITHOUT THE WRITTEN PERMISSION OF PHYL RICH IS PROHIBITED.
DO NOT SCALE DRAWING

WALL LAV SET, SINGLE HANDLE, TUBE SPOUT 14" W/ LEVER, HEX MODERN

| | | |
|------------------|------------------------------------|--------------|
| SIZE A | ASM/PRT NO. 501-18-14/00 | REV - |
| SCALE: 1:3 | WEIGHT: lbs. | SHEET 1 OF 2 |