

ITEM NO.	PART NUMBER	DESCRIPTION	QTY.
1	3-142B/00	CROSS HANDLE, WALL/SOWER, 500 SERIES	1
1.1	10538/00	CAP RING FOR 500 SERIES BUTTON	1
1.2	10621/00	BASE HUB NUT	1
1.3	10618/00	ESCUTCHEON, TRADITIONAL 500	1
1.4	11097	PLASTIC BUTTON, BLANK	1
1.5	2-180/00	SUB ASSY. CROSS HANDLE HUB	1
1.5.1	92008	SET SCREW, CUP POINT 8-32, 3/16" L.	2
1.5.2	10623/00	HANDLE FINIAL CROSS	4
1.5.3	10622/00	HUB FOR HANDLE, CROSS	1
2	P39001	HEX KEY 5/64, FOR 8-32 SET SCREW	1

NOTE(S):
 1. PART NUMBER, "/00" DENOTES PART SHALL HAVE FINISH.
 2. APPLY NSF COMPLIANT LOCTITE TO THREADED AREA.

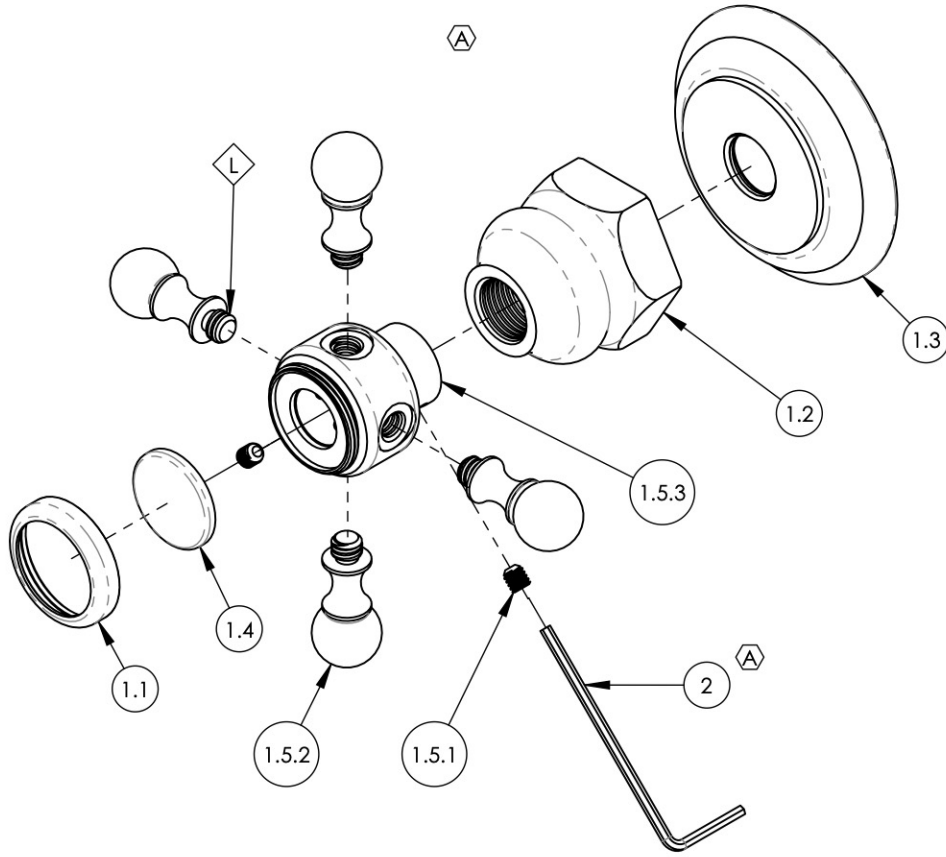

ALL	A	UPDATE TEMPLATE/ DWG NAME, HANDLE ASSY. ADD HEX KEY	12/13/2019	AMM
ZONE	REV.	DESCRIPTION	DATE	APPROVED
REVISIONS				

1261 LOGAN AVENUE
 COSTA MESA, CALIFORNIA 92626
 PHONE: 714.361.4800
 FAX: 714.617.3120

PHYLIRICH®

Defining Luxury Since 1959

PROPRIETARY AND CONFIDENTIAL

THE INFORMATION CONTAINED IN THIS DRAWING IS THE SOLE PROPERTY OF PHYLIRICH. ANY REPRODUCTION IN PART OR AS A WHOLE WITHOUT THE WRITTEN PERMISSION OF PHYLIRICH IS PROHIBITED.

-		INTERPRET GEOMETRIC DIMENSIONING & TOLERANCING IN ACCORDANCE WITH ASME Y14.5-2009 & ASME Y14.41-2003 STANDARDS, UNLESS OTHERWISE SPECIFIED. DIMENSIONS ARE IN INCHES. TOLERANCES ARE:		
NEXT ASSY	USED ON	FRACTIONS ±1/16"	DECIMALS X.X: ±.1 X.XX: ±.01 X.XXX: ±.005	ANGULAR ±2°
APPLICATION		MATERIAL	NAME	DATE
FINISH		DRAWN	CA	10/31/2013
DO NOT SCALE DRAWING		CHECKED		

**SHOWER ITEM, VOLUME CONTROL/
 DIVERTER, CROSS, HEX TRADITIONAL**

SIZE	ASM/PRT NO.	REV
A	500-35/00	A

SCALE: 1:1.5 WEIGHT: lbs. SHEET 1 OF 2

