

NOTE(S):

1. EXAMPLE OF SPLIT FINISH CODE:  
A. 3-373/026X030

2. SPLIT FINISH CODES:

- A. BLACK MARBLE = 3-373/00X030
- B. WHITE MARBLE = 3-373/00X031
- C. SOAPSTONE = 3-373/00X032

3. AVAILABLE HANDLE STONE PART # OPTIONS:

- A. BLACK MARBLE = 11328 (030)
- B. WHITE MARBLE = 11329 (031)
- C. SOAPSTONE = 11330 (032)

(B)

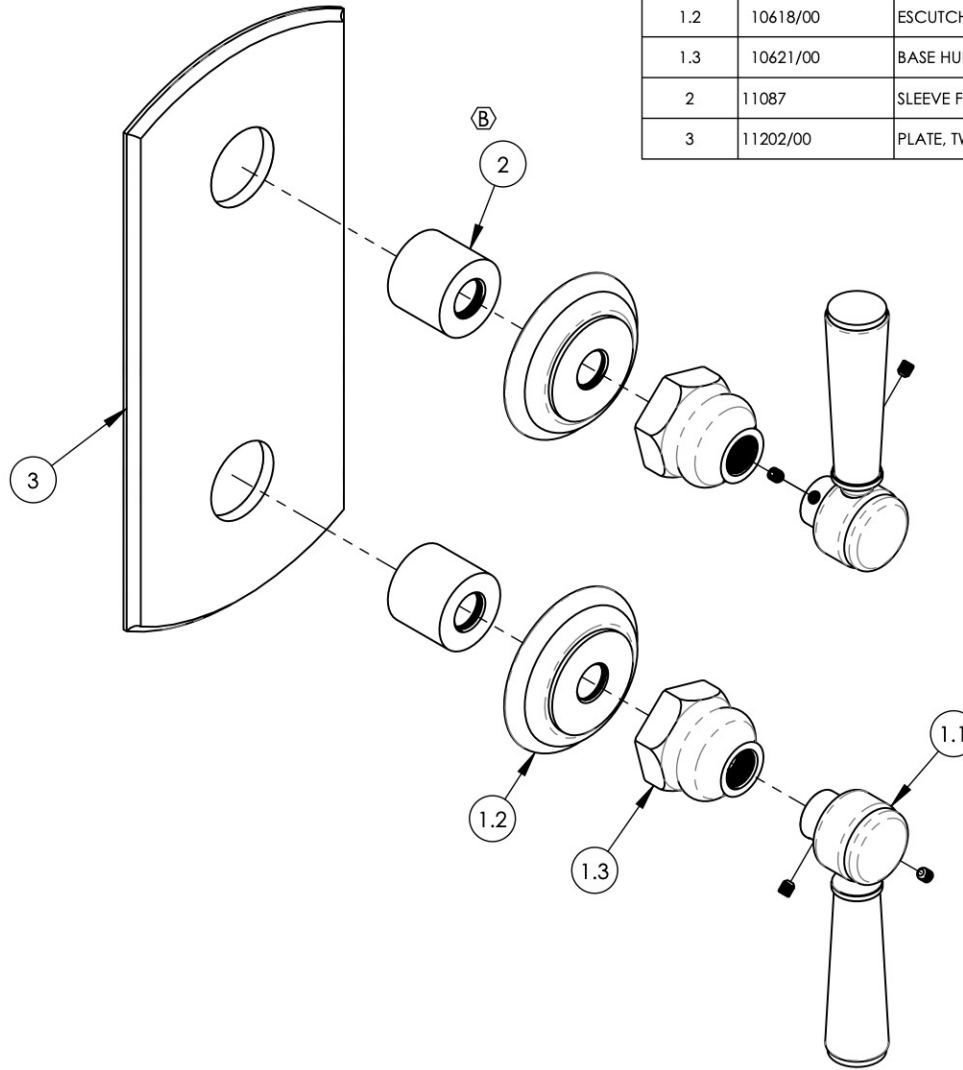

(B)

ITEM NO.	PART NUMBER	DESCRIPTION	QTY.	
*	1	3-373/00	MARBLE LEVER HANDLE ASSY., WALL/SHOWER	2
	1.1	2-142/00	MARBLE LEVER HANDLE, 500 SERIES, HEX TRADITIONAL	1
	1.2	10618/00	ESCUTCHEON, TRADITIONAL 500	1
	1.3	10621/00	BASE HUB NUT	1
	2	11087	SLEEVE FOR PB-THERM PLATE	2
	3	11202/00	PLATE, TWO HANDLE BEVELED EDGE	1

ALL	B	NEW TEMPLATE/ CENTERING SLEEVE, ADD MARBLE NOTES, REMOVE TAPE, UPDATE DWG NAME	12/12/2019	AMM
ZONE	REV.	DESCRIPTION	DATE	APPROVED
REVISIONS				

1261 LOGAN AVENUE  
COSTA MESA, CALIFORNIA 92626  
PHONE: 714.361.4800  
FAX: 714.617.3120

**PHYLIRICH**<sup>®</sup>  
Defining Luxury Since 1959

**PROPRIETARY AND CONFIDENTIAL**

THE INFORMATION CONTAINED IN THIS DRAWING IS THE SOLE PROPERTY OF PHYLIRICH. ANY REPRODUCTION IN PART OR AS A WHOLE WITHOUT THE WRITTEN PERMISSION OF PHYLIRICH IS PROHIBITED.

-	-	INTERPRET GEOMETRIC DIMENSIONING & TOLERANCING IN ACCORDANCE WITH ASME Y14.5-2009 & ASME Y14.41-2003 STANDARDS, UNLESS OTHERWISE SPECIFIED, DIMENSIONS ARE IN INCHES. TOLERANCES ARE:		
NEXT ASSY	USED ON	FRACTIONS ±1/16"	DECIMALS X.X: ±.1 X.XX: ±.01 X.XXX: ±.005	ANGULAR ±2°
APPLICATION		MATERIAL	NAME	DATE
FINISH		DRAWN	LLO	10/23/2015
<b>DO NOT SCALE DRAWING</b>		CHECKED	GRE	

**THERM, SHOWER TRIM, TWO HANDLE, MARBLE, HEX TRADITIONAL**

SIZE	ASM/PRT NO.	REV
<b>A</b>	4-155/00	<b>B</b>

SCALE: 1:2.5      WEIGHT: lbs.      SHEET 1 OF 2