

5

4

3

2

1

NOTE(S):  
1. PART NUMBER, "/00" DENOTES PART SHALL HAVE FINISH.

ITEM NO.	PART NUMBER	DESCRIPTION	QTY.
1	11087	SLEEVE FOR PB-THERM PLATE	2
2	11202/00	PLATE, TWO HANDLE BEVELED EDGE	1
3	3-142B/00	CROSS HANDLE, WALL/SHOWER, 500 SERIES	2
3.1	10538/00	CAP RING FOR 500 SERIES BUTTON	1
3.2	10621/00	BASE HUB NUT	1
3.3	10618/00	ESCUTCHEON, TRADITIONAL 500	1
3.4	11097	PLASTIC BUTTON, BLANK	1
3.5	2-180/00	SUB ASSY. CROSS HANDLE HUB	1

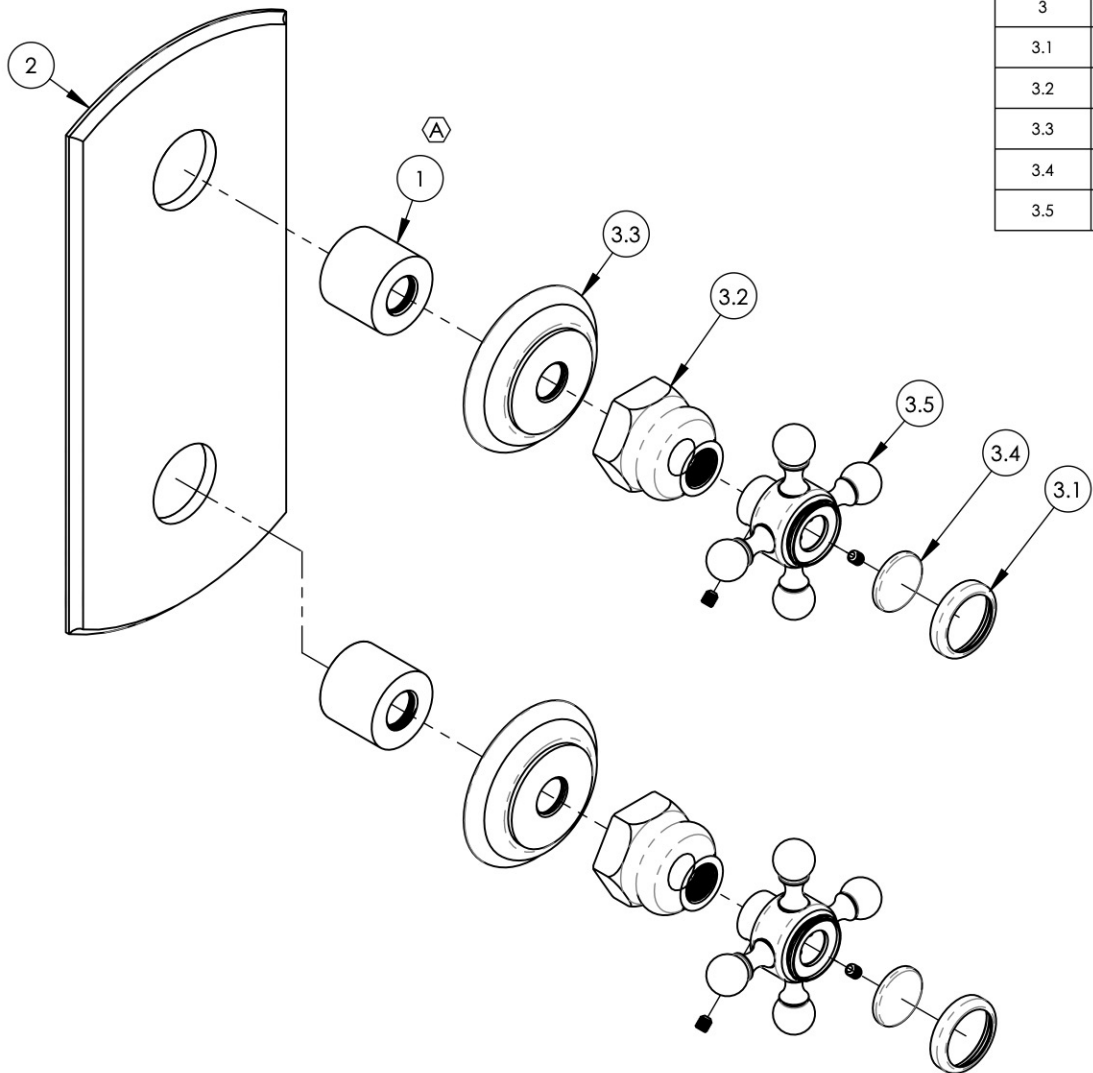

A

ALL	REV.	DESCRIPTION	DATE	APPROVED
A		UPDATE TEMPLATE, DWG NAME, CENTERING SLEEVES, REMOVE TAPE	12/12/2019	AMM

-		INTERPRET GEOMETRIC DIMENSIONING & TOLERANCING IN ACCORDANCE WITH ASME Y14.5-2009 & ASME Y14.41-2003 STANDARDS, UNLESS OTHERWISE SPECIFIED. DIMENSIONS ARE IN INCHES. TOLERANCES ARE:		
-				
-				
NEXT ASSY	USED ON	FRACTIONS ±1/16"	DECIMALS X.X: ±.1 X.XX: ±.01 X.XXX: ±.005	ANGULAR ±2°
APPLICATION		MATERIAL	NAME	DATE
FINISH		DRAWN	LLO	10/23/2015
DO NOT SCALE DRAWING		CHECKED	GRE	

THERM, SHOWER TRIM, TWO HANDLE, CROSS, HEX TRADITIONAL

SIZE	ASM/PRT NO.	REV
<b>A</b>	4-099/00	<b>A</b>
SCALE: 1:2.5	WEIGHT: lbs.	SHEET 1 OF 2

1261 LOGAN AVENUE  
COSTA MESA, CALIFORNIA 92626  
PHONE: 714.361.4800  
FAX: 714.617.3120

**PHYL RICH**<sup>®</sup>  
Defining Luxury Since 1959

**PROPRIETARY AND CONFIDENTIAL**  
THE INFORMATION CONTAINED IN THIS DRAWING IS THE SOLE PROPERTY OF PHYL RICH. ANY REPRODUCTION IN PART OR AS A WHOLE WITHOUT THE WRITTEN PERMISSION OF PHYL RICH IS PROHIBITED.

5

4

3

2

1