

NOTE(S):  
 1. PART NUMBER, "/00" DENOTES PART SHALL HAVE FINISH.

ITEM NO.	PART NUMBER	DESCRIPTION	QTY.
1	11087	SLEEVE FOR PB-THERM PLATE	1
2	3-142B/00	CROSS HANDLE, WALL/SHOWER, 500 SERIES	1
2.1	10538/00	CAP RING FOR 500 SERIES BUTTON	1
2.2	10621/00	BASE HUB NUT	1
2.3	10618/00	ESCUTCHEON, TRADITIONAL 500	1
2.4	11097	PLASTIC BUTTON, BLANK	1
2.5	2-180/00	SUB ASSY. CROSS HANDLE HUB	1
3	P17009/00	PRESSURE BALANCE TRIM PLATE	1

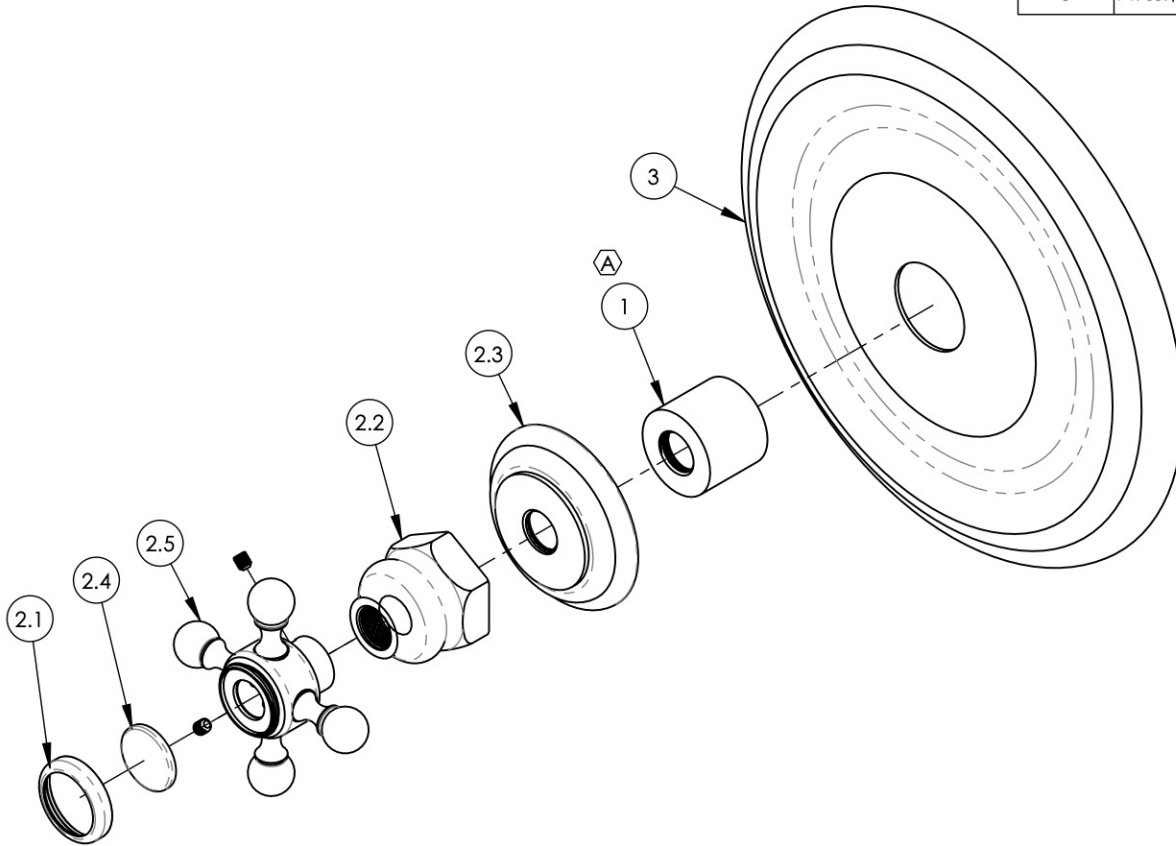

(A)

ALL	A	REMOVE HEX KEY, UPDATE TEMPLATE, CENTERING SLEEVE, & DWG NAME	12/11/2019	AMM
ZONE	REV.	DESCRIPTION	DATE	APPROVED
REVISIONS				

-	-	INTERPRET GEOMETRIC DIMENSIONING & TOLERANCING IN ACCORDANCE WITH ASME Y14.5-2009 & ASME Y14.41-2003 STANDARDS, UNLESS OTHERWISE SPECIFIED. DIMENSIONS ARE IN INCHES. TOLERANCES ARE: FRACTIONS ±1/16" DECIMALS X.X: ±.1 X.XX: ±.01 X.XXX: ±.005
NEXT ASSY USED ON		
APPLICATION		
MATERIAL	NAME	DATE
FINISH	DRAWN	LLO 10/26/2015
DO NOT SCALE DRAWING		CHECKED
		GRE

SHOWER TRIM PLATE, SINGLE HANDLE, CROSS, HEX TRADITIONAL

SIZE	ASM/PRT NO.	REV
<b>A</b>	4-097/00	A

SCALE: 1:2.25    WEIGHT: lbs.    SHEET 1 OF 2

1261 LOGAN AVENUE  
 COSTA MESA, CALIFORNIA 92626  
 PHONE: 714.361.4800  
 FAX: 714.617.3120

**PHYLIRICH®**  
 Defining Luxury Since 1959

**PROPRIETARY AND CONFIDENTIAL**  
 THE INFORMATION CONTAINED IN THIS DRAWING IS THE SOLE PROPERTY OF PHYLIRICH. ANY REPRODUCTION IN PART OR AS A WHOLE WITHOUT THE WRITTEN PERMISSION OF PHYLIRICH IS PROHIBITED.