

5

4

3

2

1

NOTE(S):

- 1. PART NUMBER, "/00" DENOTES PART SHALL HAVE FINISH.
- 2. APPLY NSF COMPLIANT GREASE TO ANY O-RING, SEALING JOINTS, AND/OR PIVOTAL POINTS.
- 3. APPLY NSF COMPLIANT LOCTITE TO THREADED AREA.
- 4. APPLY NSF COMPLIANT REMOVABLE (BLUE) LOCTITE TO THREADED AREA.
- 5. SILVER SOLDER JOINTS SHALL BE FULLY WETTED VIA CAPILLARY ACTION AND COMPLETELY NON-POROUS.



ITEM NO.	PART NUMBER	DESCRIPTION	QTY.
1	10013	INJECTOR SHANK, 1/2"NPT MALE TO M16.5 CACHE W/ O-SEAL	1
2	11628/00	WALL SPOUT, RADI	1
3	11629/00	ESCUTCHEON, WALL SPOUT, RADI	1
4	90113	O-RING, 9/16"ID X 3/4"OD X 3/32"THK, AS-568-113	3
5	90131	O-RING, 1-11/16ID X 3/32THK, AS-568-131	1
6	92008	SET SCREW, CUP POINT 8-32, 3/16" L.	2
7	92158	DOWEL PIN, 1/8" X 3/8"L	2

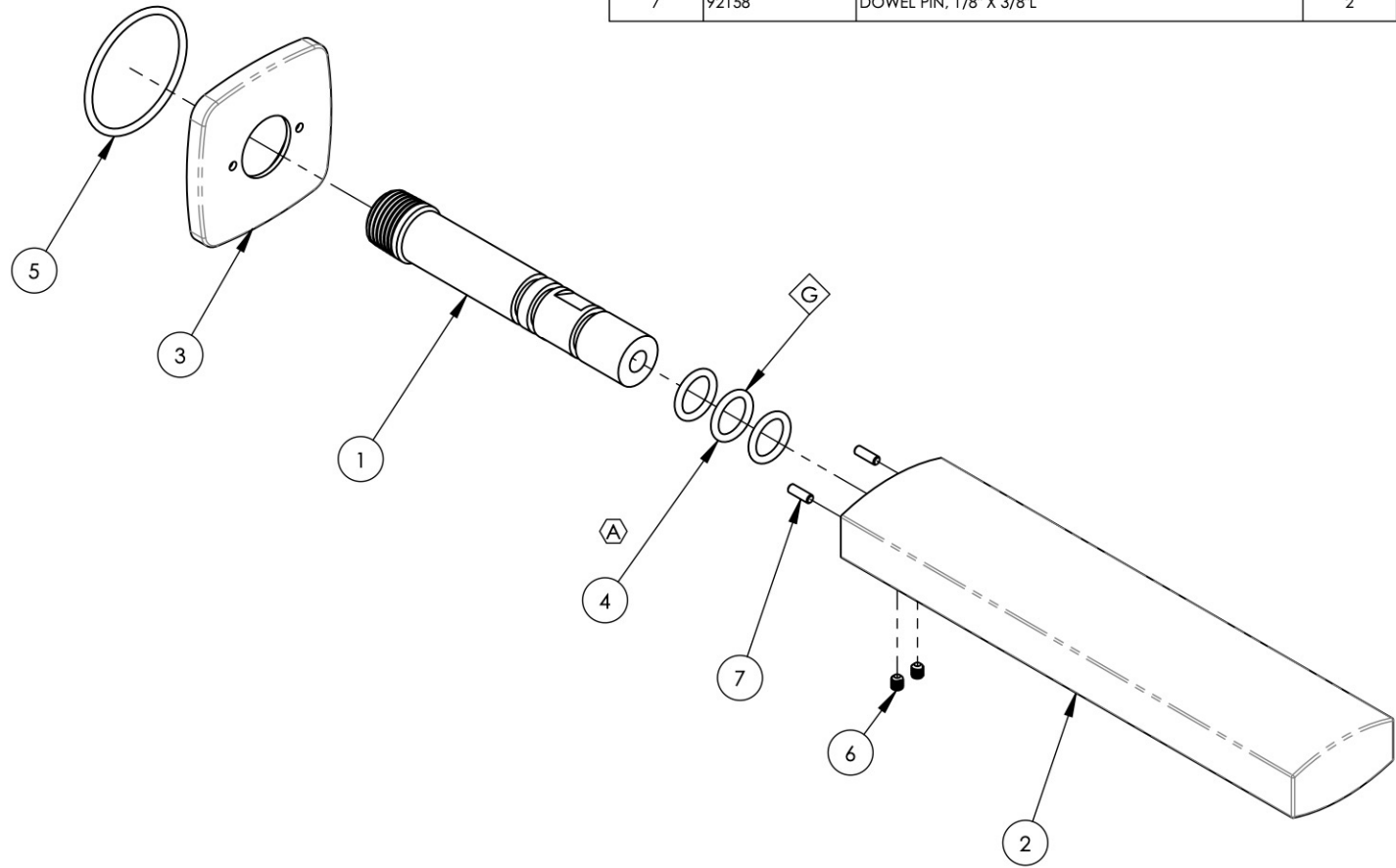

C3	A	UPDATE O-RINGS, ADD WHERE USED	2/17/2021	AMM
ZONE	REV.	DESCRIPTION	DATE	APPROVED
REVISIONS				

1261 LOGAN AVENUE  
COSTA MESA, CALIFORNIA 92626  
PHONE: 714.361.4800  
FAX: 714.617.3120

**PHYL RICH**<sup>®</sup>  
Defining Luxury Since 1959

**PROPRIETARY AND CONFIDENTIAL**  
THE INFORMATION CONTAINED IN THIS DRAWING IS THE SOLE PROPERTY OF RSS MANUFACTURING. ANY REPRODUCTION IN PART OR AS A WHOLE WITHOUT THE WRITTEN PERMISSION OF RSS MANUFACTURING IS PROHIBITED.

181-56/00	-	INTERPRET GEOMETRIC DIMENSIONING & TOLERANCING IN ACCORDANCE WITH ASME Y14.5-2009 & ASME Y14.41-2003 STANDARDS. UNLESS OTHERWISE SPECIFIED, DIMENSIONS ARE IN INCHES. TOLERANCES ARE:
181-27/00	-	
181-26/00	-	
NEXT ASSY	USED ON	<b>FRACTIONS</b> ±1/64"
APPLICATION		<b>DECIMALS</b> X.X: ±.1 X.XX: ±.01 X.XXX: ±.005
MATERIAL		<b>ANGULAR</b> ±.5°
FINISH		NAME DATE
		DRAWN RAH 12/21/2017
<b>DO NOT SCALE DRAWING</b>		CHECKED

ASSY, WALL SPOUT, RADI

SIZE	ASM/PRT NO.	REV
<b>A</b>	3-523/00	A

SCALE: 1:2.5      WEIGHT: lbs.      SHEET 1 OF 2

5

4

3

2

1